

Installing a new printhead in your Kodak Inkjet Printer

1

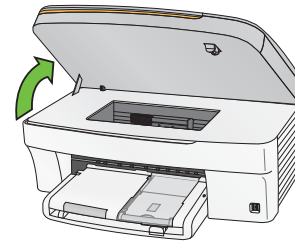

5100, 5300, 5500

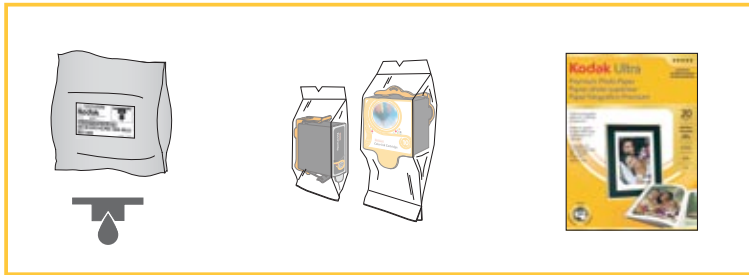
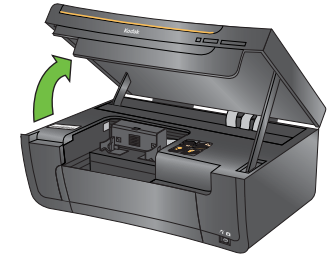

ESP 3/ESP 5

- a) Follow these instructions for step-by-step guidance on how to remove and replace your printhead.
- b) If your printer is not powered on, press ON.
- c) Lift the printer access door and wait for the carriage to move to the center position.
- d) Remove any paper that may be loaded in the printer.

2

Remove Ink Cartridges and Used Printhead

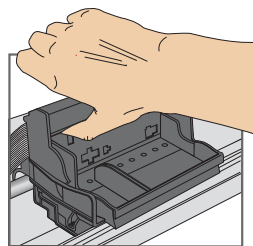
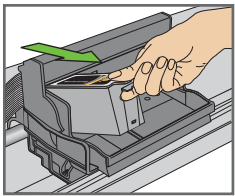

5100, 5300, 5500

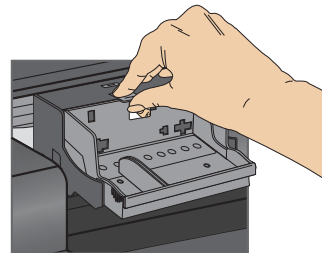

ESP 3/ESP 5

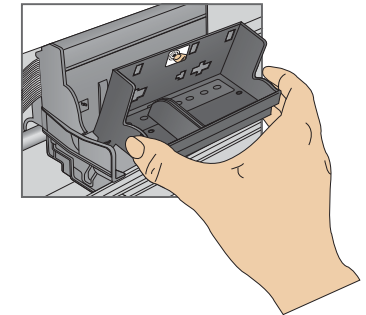

- a) Remove both ink cartridges.
- b) Unlatch the used printhead.
5000 Series: press the button on the left, as shown.
ESP 3/ESP 5: Lift the button in the center of the carriage, as shown.
- c) Lift the used printhead out of the carriage.

3

Insert New Printhead

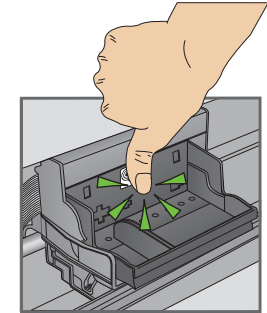
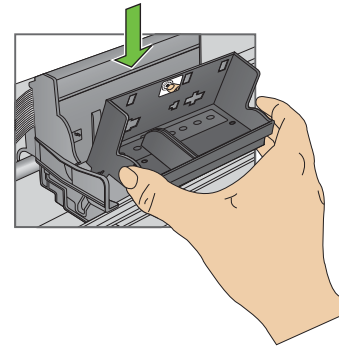
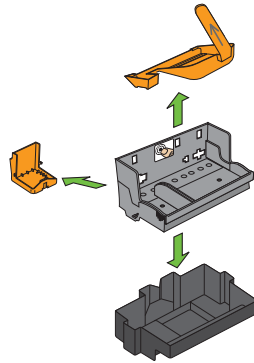
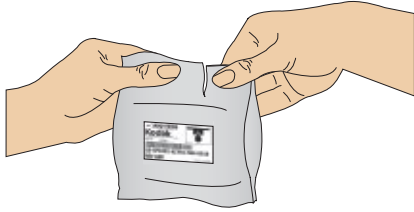

- a)** Remove the printhead from its bag.
NOTE: If the printhead bag contains a small Desiccant Pack, remove and discard it.

IMPORTANT: Complete steps b through d immediately after opening sealed bag.

- b)** Remove the 3 plastic protective shields.

- c)** Place the printhead into the carriage.
Insert at the angle shown.

- d)** Push **firmly** against the back wall of the printhead until you hear a loud snap.

4

Re-Insert the Ink Cartridges

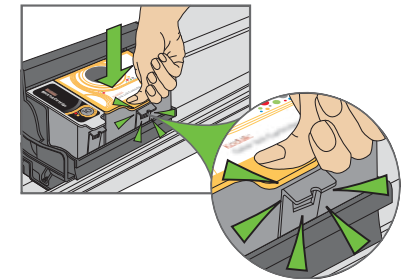
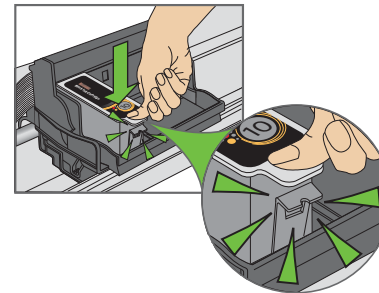
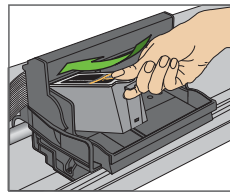
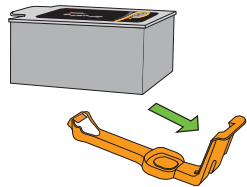

- a)** Remove the black ink cartridge from its bag. Carefully remove and discard the orange cap.

- b)** Insert the black ink cartridge into the printhead.

- c)** Press down on the ink cartridge until you hear it click into position.

- d)** Repeat steps a-c for the color ink cartridge. Close the printer access door.

5

Load Paper and Calibrate (5000 Series Only)

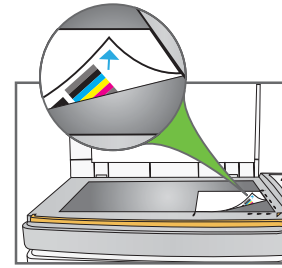
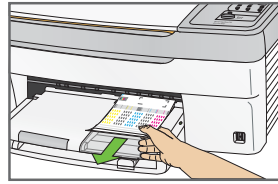
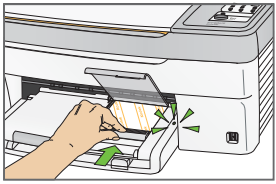

5100/5300



5500

- a)** Insert 4x6 photo paper glossy side down and push the photo tray in until it clicks into place. The photo tray light should illuminate when the tray is properly inserted.
- b)** Once the ON/OFF indicator is a steady Green, press "Start" and allow the printer to print a calibration Sheet. Calibration is complete when the ON/OFF light is solid.
- c)** Remove the calibration sheet from the output tray. Place it face down and align to the registration marks in the proper corner of the scanner glass, **as shown**.
- d)** Lower the scanner lid and press Start.

6

Load Paper and Calibrate (ESP 3 and ESP 5 Models Only)

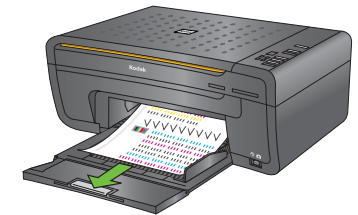
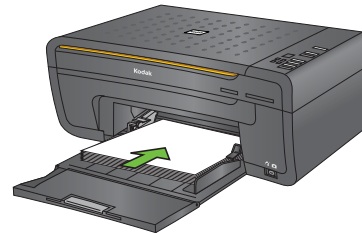
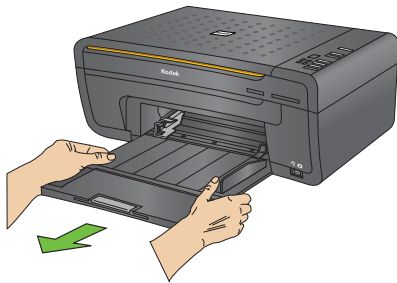

- a)** Lower the front access door and pull the paper tray all the way out.
- b)** Insert a stack of 5-10 sheets of 8.5x11 plain paper into the paper tray.
- c)** Press Copy/Resume. The printer will automatically begin to calibrate and is complete when the ON/OFF light is solid.

Need More Help?

The User Guide is installed with your Kodak Inkjet Printer Software and is located:

Windows: Start ▶ Program Files ▶ Kodak ▶ User Guide

Macintosh: Library ▶ Documentation ▶ Kodak AiO Printers

Or go to www.kodak.com/go/manuals

For printer support, please go to www.kodak.com/go/aio-support or call 1-800-421-6699.



AUR1780-9



C