

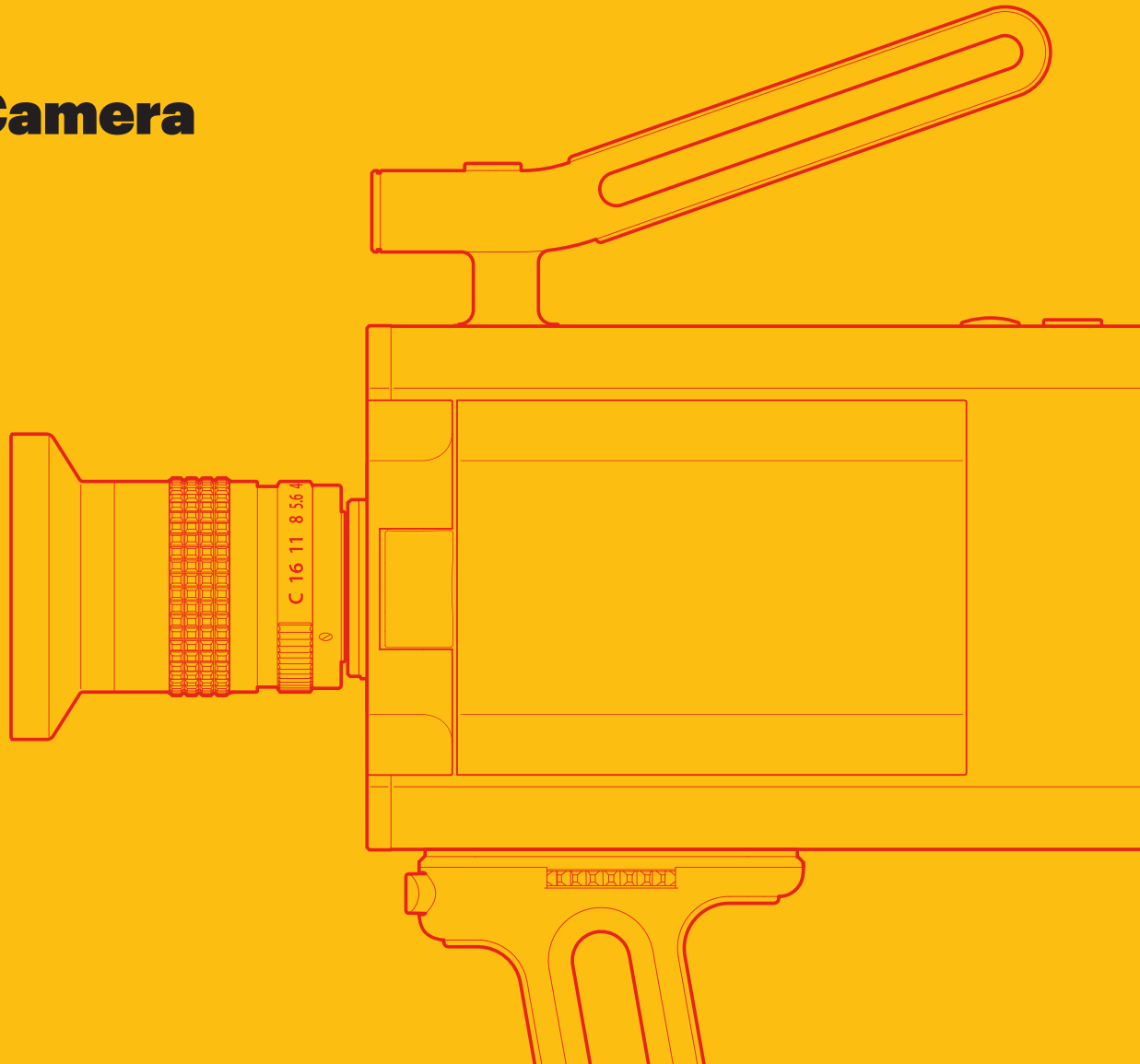

Super 8 Camera



Super 8. Better than perfect.

There are some moments that digital just can't replicate. The incomparable warmth, depth, and beauty of film simply has no equal. These are the moments that inspire us, that move us forward, and enlighten us. Merging analog magic with digital convenience in the most accessible and easy-to-use film format ever invented.

The new KODAK Super 8 Camera is the most advanced camera in its category. Industrial design, lens options, and a complete system from action to cut. It's more than a camera. Welcome to your new platform for creativity. Nice to see you again, Super 8.

Registration

Register your new KODAK Super 8 camera to activate your warranty. Find this KODAK Super 8 Camera User Manual, along with videos and stay up to date on special offers, tips and additional services.

www.kodak.com/go/super8

This User Manual goes beyond the Getting Started Guide to show you how to set up your camera, shoot movies, use all the features, and take care of your camera.

Contents

Safety and Battery Handling	3
Warranty	4
Getting Started	
What's in the Box	6
Overview	7
Overview - Back Panel	8
Install the Battery	9
Charge the Battery	9
Install the Lens / Using a Filter	10
Install Pistol Grip	10
Power On / Power Off	11
Setup	11
Load the Film Cartridge	12
Create Cartridge / Set Film Type	12
Set Frame Rate	13
Set Alternative Frame Rate (Function Button)	13
Use Alternative Frame Rate (Function Button)	14
Set Run Mode and Auto Off Mode	14
Viewfinder Overview	15
Compose the Scene: View Gate / Aspect Ratio Overlay	16
External Display as Viewfinder or Control Monitor	17
Connecting the Camera with a remote	18
Adjust Exposure, Focus, and Shoot	19
Unload and Process Film	19
Recording Audio: SD Card	20
Insert and Format SD Card	20
Connect Microphone or Line Input	21
Transfer Audio Files: SD card	22
Audio File Management	22
You are good to go when... ..	23
Troubleshooting	23
Proper Care of Your Camera	24
About Your Camera	
Audio Menu	25
Cartridge Menu	25
Camera Menu	26
Viewfinder Menu	26
System Menu	27
Update Firmware	27

Safety and Battery Handling





Save These Important Safety Instructions

- Read and follow these instructions before using Kodak products. Always follow basic safety procedures.
- The use of an accessory attachment that is not recommended by Kodak, such as an AC adapter, may cause fire, electric shock, or injury.
- If using this product in an airplane, observe all instructions of the airline.

 **CAUTION: Do not disassemble this product; there are no user-serviceable parts inside. Refer servicing to qualified service personnel.**

 **WARNING: Do not expose this product to liquid, moisture, or extreme temperatures. Kodak AC adapters and battery chargers are intended for indoor use only. Other instructions and restrictions may accompany the battery charger and should be read and followed before use. The use of controls, adjustments, or procedures other than those specified herein may result in exposure to shock and/or electrical or mechanical hazards.**

Battery Safety and Handling

-  • Use only approved batteries for this product to avoid risk of explosion or fire.
-  • Keep batteries out of the reach of children.
-  • Do not disassemble, install backward, or expose batteries to liquid, moisture, fire, or extreme temperature.
- Remove battery when the product is stored for an extended period of time. In the unlikely event that battery fluid leaks inside the product, contact your local Kodak Customer Service representative.
- In the unlikely event that battery fluid leaks onto your skin, wash immediately with water and contact your local health provider. For additional health-related information, contact your local Kodak Customer Service representative.
- If the battery contacts touch metal objects, the battery may short-circuit, discharge energy, become hot, or leak.
-  • Please dispose of used electronic equipment (WEEE) and batteries at designated collection points for recycling. Kodak encourages customers to protect human health and the environment by taking advantage of any local WEEE and battery recycling programs. For more information, contact your local household waste disposal service.

 **CAUTION: When removing batteries, allow them to cool first; batteries may be hot.**

 For more information, or to contact your local Kodak Customer Service representative, go to:

www.kodak.com/go/super8

Read and observe the following warnings and precautions to ensure correct and safe use of Li-ion batteries.

Danger!

- Do not immerse the battery in water or allow it to get wet.
- Do not use or store the battery near sources of heat such as a fire or heater.
- Do not use any chargers other than those recommended.
- Do not reverse the positive (+) and negative (-) terminals.
- Do not connect the battery directly to wall outlets or car cigarette-lighter sockets.
- Do not put the battery into a fire or apply direct heat to it.
- Do not short-circuit the battery by connecting wires or other metal objects to the positive (+) and negative (-) terminals.
- Do not pierce the battery casing with a nail or other sharp object, break it open with a hammer, or step on it.
- Do not strike, throw or subject the battery to severe physical shock.
- Do not directly solder the battery terminals.
- Do not attempt to disassemble or modify the battery in any way.
- Do not place the battery in a microwave oven or pressurized container.
- Do not use the battery in combination with primary batteries (such as dry-cell batteries) or batteries of different capacity, type or brand.
- Do not use the battery if it gives off an odor, generates heat, becomes discolored or deformed, or appears abnormal in any way. If the battery is in use or being recharged, remove it from the device or charger immediately and discontinue use.

Caution!

- Do not use or store the battery where it is exposed to extreme heat, such as under a window of a car in direct sunlight in a hot day. Otherwise, the battery may be overheated. This can also reduce battery performance and/or shorten service life.
- If the battery leaks and electrolyte gets in your eyes, do not rub them. Instead, rinse them with clean running water and immediately seek medical attention. If left as is, electrolyte can cause eye injury.

Warranty

Limited Warranty

THIS IS A LIMITED WARRANTY FOR KODAK SUPER 8 CAMERA ("Product"). THIS WARRANTY IS ONLY VALID WITHIN THE COUNTRY OF SALE OF THE PRODUCT. YOU MUST PRESENT THIS FORM TOGETHER WITH VALID PROOF OF PURCHASE AND PROOF OF PURCHASE DATE (BILL OF SALE) TO OBTAIN WARRANTY SERVICE.

This Eastman Kodak Company ("Kodak") Product is warranted by Kodak to be free from defects in material and workmanship for one (1) year from the date of purchase or usage of a maximum of 100,000 frames shot, whichever comes first.

During this warranty period if the Product is found to be defective in material or workmanship, Kodak or one of its authorized service facilities will at its sole option, either repair or replace this Product without charge, subject to the conditions, limitations and exclusions set forth herein. The option of repair or replacement is Kodak's only obligation.

1. This warranty extends to the original consumer purchaser only and is not assignable or transferable.
2. This warranty shall not apply to any Product which has been subjected to misuse, abuse, abnormal use, excessive use, negligence, alteration or accident, or has had its serial number altered or removed.
3. This warranty does not apply to any defects or damage directly or indirectly caused by or resulting from the use of unauthorized replacement parts, accessories, attachments; service performed by unauthorized personnel or an unauthorized repair center; failure to follow Kodak's operation, maintenance or repacking instructions; failure to use items supplied by Kodak (e.g., adapters, cables); circumstances beyond Kodak's control or claims made after the duration of this warranty.
4. This warranty does not apply to the batteries and software driver that accompanies this product, film or film processing.
5. Warranty Service is only available within the country where the Products were originally purchased. Customer may be required to ship Products, at customer's expense, to the authorized service facility within the country of purchase.
6. Warranty service will include labor, necessary adjustments and replacement parts. Replacement parts may be remanufactured or may contain remanufactured materials. If it is necessary to replace the entire Product, it may be replaced with a remanufactured Product in Kodak's sole discretion and at its option. Remanufactured Products, parts and materials are warranted for the remaining warranty term of the original Product or 60 days (up to 16,438 frames) after the date of repair or replacement, whichever is longer.

THIS WARRANTY IS MADE EXPRESSLY IN LIEU OF ALL OTHER WARRANTIES, EXPRESSED OR IMPLIED, INCLUDING BUT NOT LIMITED TO ANY IMPLIED WARRANTY MERCHANTABILITY OR FITNESS FOR A PARTICULAR PURPOSE, AND ALL OTHER OBLIGATIONS OF EASTMAN KODAK COMPANY PROVIDED, HOWEVER, THAT IF THE DISCLAIMER OF IMPLIED WARRANTIES IS EFFECTIVE UNDER APPLICABLE LAW, THE DURATION OF ANY IMPLIED WARRANTIES ARISING BY OPERATION OF LAW SHALL BE LIMITED TO THE SHORTER OF ONE (1) YEAR FROM THE DATE OF PURCHASE OR 100,000 FRAMES SHOT OR SUCH LONGER PERIOD AS MAY BE REQUIRED BY APPLICABLE LAW.

KODAK HEREBY DISCLAIMS ANY AND ALL LIABILITY FOR SPECIAL, CONSEQUENTIAL AND INCIDENTAL DAMAGES ARISING OUT OF OR IN CONNECTION WITH THE SALE, PURCHASE OR USE OF THE PRODUCTS REGARDLESS OF THE CAUSE, ANY BREACH OF THIS WARRANTY OR ANY OTHER CLAIM WITH RESPECT TO THIS PRODUCT, INCLUDING BUT NOT LIMITED TO, CLAIMS OF NEGLIGENCE, STRICT LIABILITY IN TORT OR BREACH OF CONTRACT.

SOME STATES DO NOT ALLOW (A) LIMITATIONS ON HOW LONG AN IMPLIED WARRANTY LASTS OR (B) THE EXCLUSION OR LIMITATION OF INCIDENTAL OR CONSEQUENTIAL DAMAGES, SO THE ABOVE LIMITATIONS OR EXCLUSIONS MAY NOT APPLY TO YOU. THIS WARRANTY GIVES YOU SPECIFIC LEGAL RIGHTS AND YOU MAY HAVE OTHER RIGHTS WHICH VARY FROM STATE TO STATE OR BY JURISDICTION.

In order to obtain performance of the warranty obligations, the original purchaser must return the Product together with proof of purchase and proof of purchase date (bill of sale) either in person or addressed to Kodak's authorized repair center. Prior to shipping the camera for service, the camera owner will be required to communicate with a Kodak service representative who will troubleshoot and determine whether or not a repair is required. The service representative will provide instructions and direction upon such determination.

In returning this product for repair or replacement under this warranty, the original consumer purchaser must prepay all postage, shipping transportation, insurance and delivery costs, and the product must be delivered in packaging and shipping materials that afford an adequate degree of protection. Kodak will not be responsible for any loss or damage incurred in connection with the return of this product.

THIS WARRANTY WILL BE VALID ONLY WITH AUTHENTIC PRODUCTS SOLD BY KODAK AND SERVICED THROUGH AN AUTHORIZED REPAIR CENTER.



FCC Notice

This device complies with Part 15 of the FCC Rules. Operation is subject to the following two conditions: (1) this device may not cause harmful interference, and (2) this device must accept any interference received, including interference that may cause undesired operation.

This equipment has been tested and found to comply with the limits for a Class B digital device, pursuant to part 15 of the FCC Rules. These limits are designed to provide reasonable protection against harmful interference in a residential installation. This equipment generates, uses and can radiate radio frequency energy and, if not installed and used in accordance with the instructions, may cause harmful interference to radio communications. However, there is no guarantee that interference will not occur in a particular installation. If this equipment does cause harmful interference to radio or television reception, which can be determined by turning the equipment off and on, the user is encouraged to try to correct the interference by one or more of the following measures:

- Reorient or relocate the receiving antenna.
- Increase the separation between the equipment and receiver.
- Connect the equipment into an outlet on a circuit different from that to which the receiver is connected.
- Consult the dealer or an experienced radio/TV technician for help.

Do not make modifications to the equipment. If such changes/modifications are made, you could be required to stop operating the equipment.

Open Source Software Notice:

The Kodak Super 8 Camera embedded software uses the GStreamer library, licensed under the LGPL and the QuickTime 5 library, licensed under the LGPL 2.1. It also uses WVGA, battery, and USB drivers distributed under terms of GPL v3. For more information, contact Eastman Kodak Company, Attn: General Counsel, 343 State Street, Rochester, NY 14650, 1-585-724-4000.

Only for European Union and EEA (Norway, Iceland and Liechtenstein)

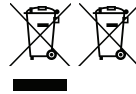

These symbols indicate that this product is not to be disposed of with your household waste, according to the WEEE Directive (2012/19/EU), the Battery Directive (2006/66/EC) and/or national legislation implementing those Directives.

If a chemical symbol is printed beneath the symbol shown above, in accordance with the Battery Directive, this indicates that a heavy metal (Hg = Mercury, Cd = Cadmium, Pb = Lead) is present in this battery or accumulator at a concentration above an applicable threshold specified in the Battery Directive.

This product should be handed over to a designated collection point, e.g., on an authorized one-for-one basis when you buy a new similar product or to an authorized collection site for recycling waste electrical and electronic equipment (EEE) and batteries and accumulators.

Improper handling of this type of waste could have a possible impact on the environment and human health due to potentially hazardous substances that are generally associated with EEE. Your cooperation in the correct disposal of this product will contribute to the effective usage of natural resources.

For more information about the recycling of this product, please contact your local city office, waste authority, approved scheme or your household waste disposal service or visit <http://www.kodak.com/go/recycle>.

CAN ICES-3 (B)/NMB-3(B)

Eastman Kodak Company Rochester, NY USA 14650

Copyright Warning

Unauthorized recording of copyrighted materials may infringe on the rights of copyright owners and be contrary to copyright laws.

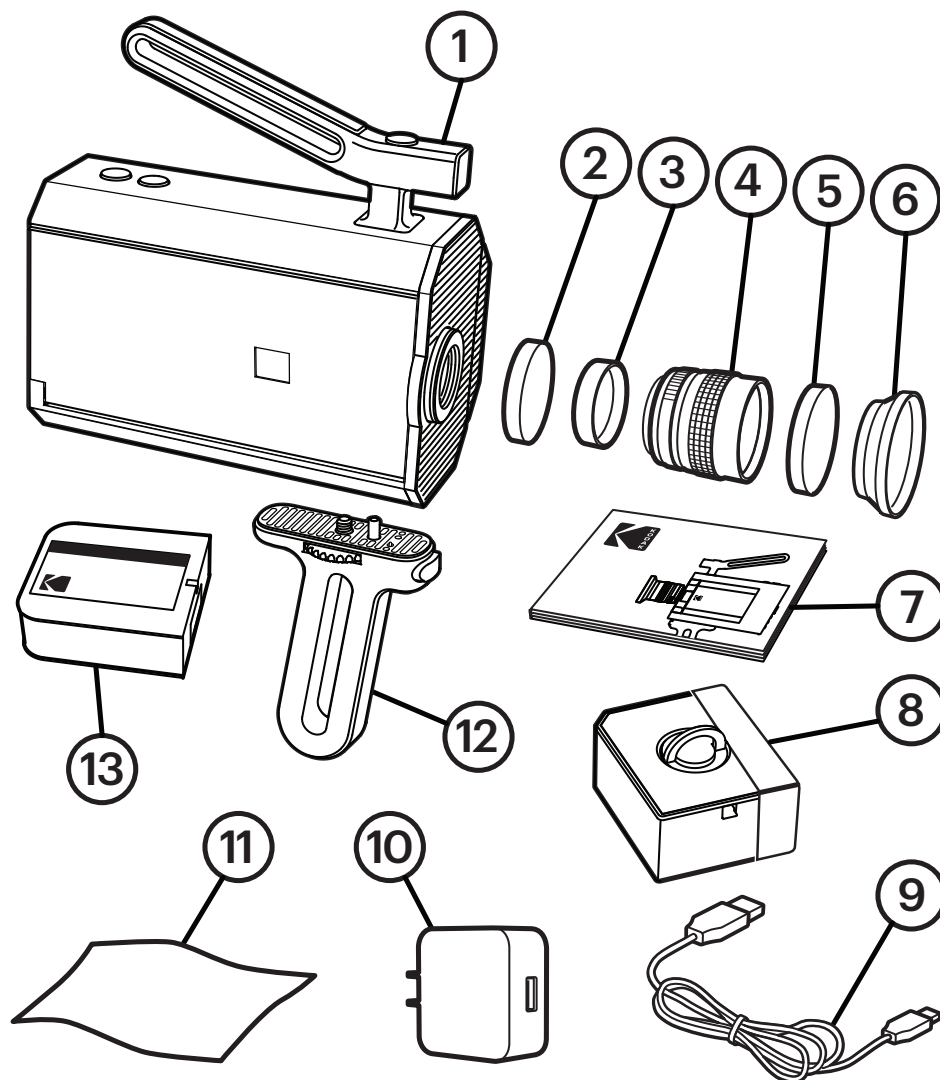

What's in the Box

- | | |
|--|---|
| <ul style="list-style-type: none"> 1 KODAK Super 8 Camera 2 C-Mount Cap 3 Lens Cap 4 Wide Angle 6 mm Lens 1:1.2 5 Lens Cap 6 Lens Hood 7 Getting Started Guide 8 KODAK Super 8 Camera Battery with Cover | <ul style="list-style-type: none"> 9 Micro USB Charging Cable 10 KODAK Super8 Camera USB Power Adapter (US / UK / EU Version) 11 Cleaning Cloth 12 Pistol Grip 13 KODAK TRI-X Reversal Film |
|--|---|

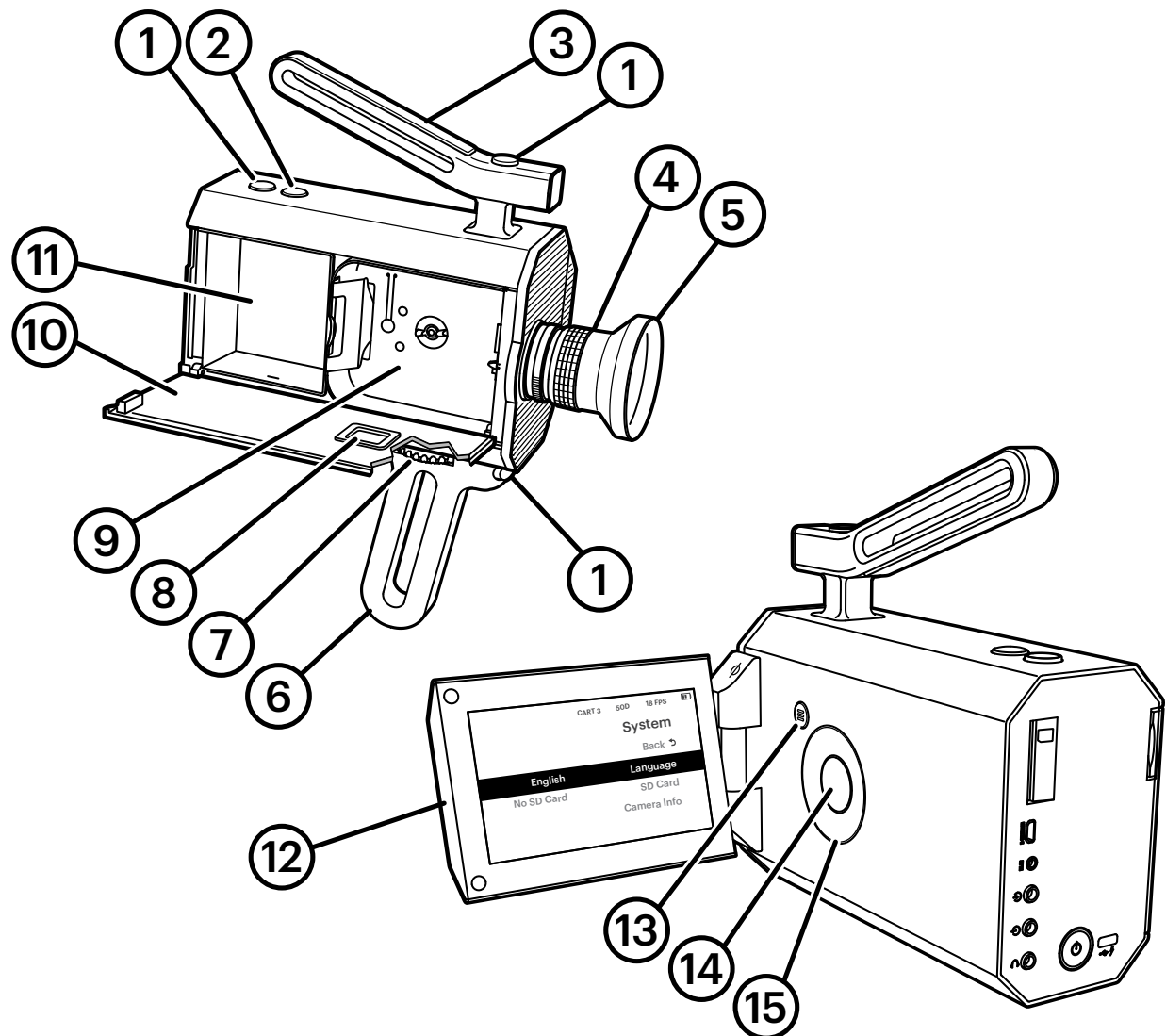

Overview

- | | |
|---|---|
| <ul style="list-style-type: none"> 1 Run Button (starts/stops filming) 2 Function Button (temporarily changes frame rate) 3 Top Handle (for filming at low height) 4 Lens 5 Lens Hood 6 Pistol Grip 7 Thumbscrew 8 Cartridge Window | <ul style="list-style-type: none"> 9 Film Compartment 10 Film Door 11 Battery Compartment 12 LCD Viewfinder 13 Menu Button (toggle between menus and viewfinder) 14 Confirm Button (push to select a menu option) 15 Touch Wheel (scroll menu up/down) |
|---|---|

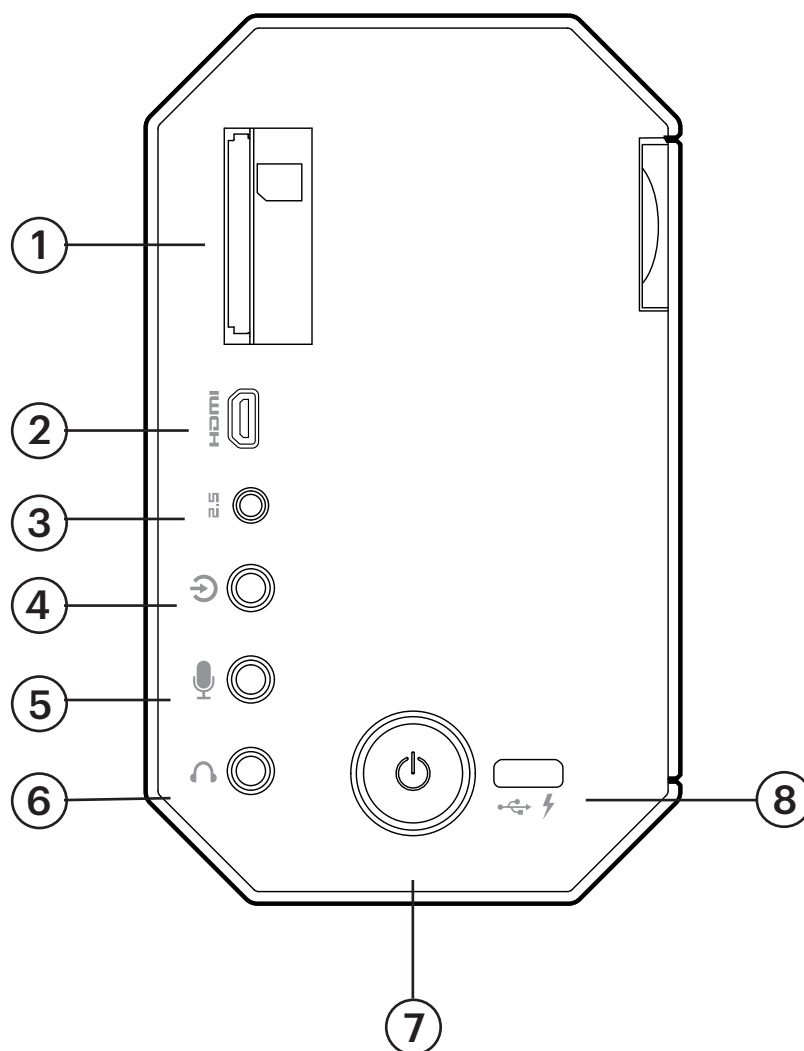

Overview - Back Panel

- | | |
|---|---|
| <ul style="list-style-type: none"> 1 SD Card Slot (audio recordings / firmware updates / file transfer) 2 Micro HDMI (external display) 3 2.5 mm Jack (remote access for Run button) 4 3.5 mm Line Input (audio device input) 5 3.5 mm Mic Input | <ul style="list-style-type: none"> 6 3.5 mm Headphone Output 7 Power Button 8 Micro USB (charging) |
|---|---|

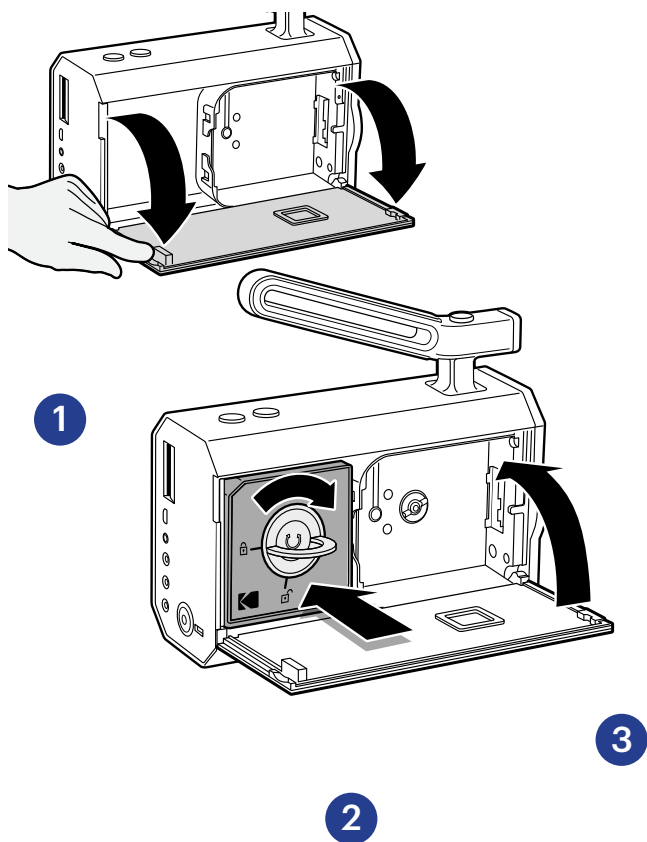

Install the Battery

IMPORTANT: The camera will NOT work without a battery. The battery MUST be fully charged BEFORE using the camera for the first time.

Use only a genuine KODAK Super 8 Camera Battery.

1. Open the film door.
2. Remove the silicone cover from the battery pack
3. Insert the battery and lift and twist the handle clockwise to lock it into place.
4. Close the film door.

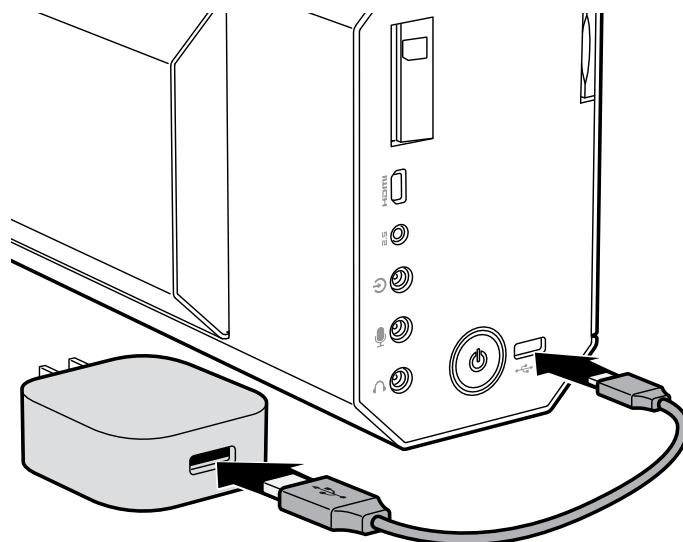

Charge the Battery

Connect one end of the Micro USB Charging Cable to the camera and the other end to the USB Power Adapter. Plug the adapter into a wall outlet.

The camera power button light will turn red when charging and will turn green when fully charged (about 3.5 hours).

IMPORTANT: Only use the Super 8 Camera USB Power Adapter supplied with the camera or purchased separately from Kodak. Your USB power adapter MAY NOT look like the illustration shown here.

IMPORTANT: Fully charge the battery upon purchase and before any shoot. Do not store the battery in the camera. Store batteries in a cool place: $23^{\circ}\text{C} \pm 5^{\circ}\text{C}$ ($73.4^{\circ}\text{F} \pm 9^{\circ}\text{F}$), $65\% \pm 20\% \text{RH}$.

ADDITIONAL INFO:

You should be able to film 10-12 cartridges within a week on a fully charged battery, using the default Auto Off Mode.

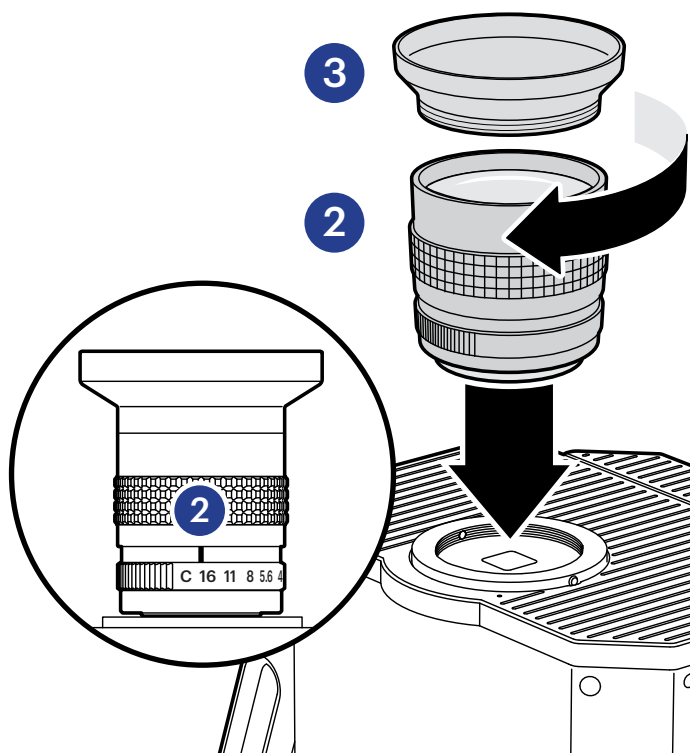

Install the Lens

1. Remove and save all lens and camera caps.
IMPORTANT: Only use C-Mount lenses that are flush with the thread. CS-Mount lenses will damage the thread.
2. With the lens mount facing up, carefully attach the lens by turning it clockwise until secure. The index line must be oriented at the top of the camera.
WARNING: Over-tightening the lens can damage the mount and change the focus of the camera.
3. Install the lens hood (optional): Carefully screw hood into end of lens until secure.
WARNING: Never release or change any of the visible screws on the lens or at the mount.

ADDITIONAL INFO:

Adapters are available to combine other lenses to the C-Mount.

The lens hood keeps light from hitting the lens from the sides, to prevent glare and lens flare, and protects the lens from accidental fingerprints and scratches.

Using a Filter

The camera does not have any integrated filter (85) for using a tungsten film stock under daylight condition.

Any filtering for adjusting the color temperature or neutral density needs to be done in front of the lens. As the built in lightmeter works through the lens, the density of the filter in use will be compensated for exposure.

ADDITIONAL INFO:

When the KODAK Super 8 camera is used with the included 6mm / 1:1.2 lens, the filter size for the lens is **40.5mm**, if the lens hood is attached, the filter size will be **62mm**.

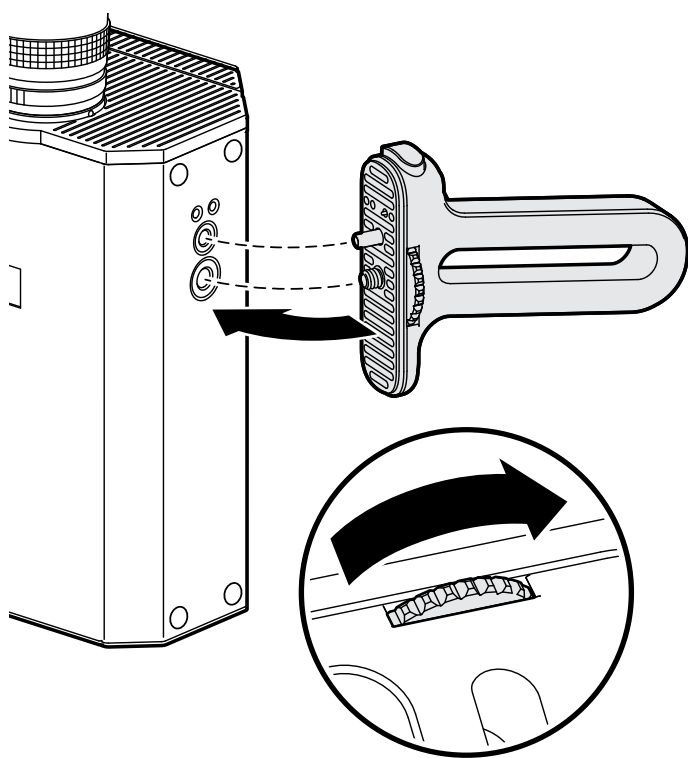

Install Pistol Grip

To install the pistol grip, align it with run button towards front of camera. Turn the thumbscrew until tight.

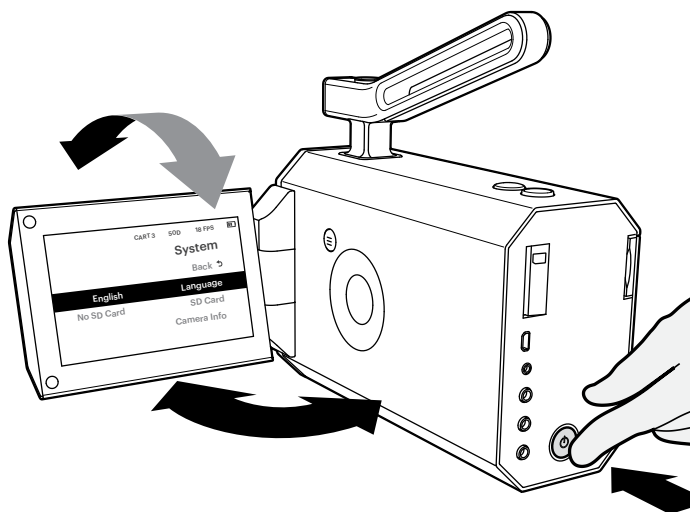

Power On

1. Open the LCD viewfinder.
2. Press the power button to turn the camera on.

Power Off

1. Open the LCD viewfinder.
2. Press and hold the power button for at least 3 seconds to turn the camera off.
3. If the LCD is open, close it.

TIP: To prevent damage to the LCD screen, close the LCD viewfinder when the camera is not in use.

NOTE: The first time you press the power button, you may need to hold it in for approximately 5 seconds. After that first time, the camera defaults to Auto Off Mode and have to push the power button to turn it on.

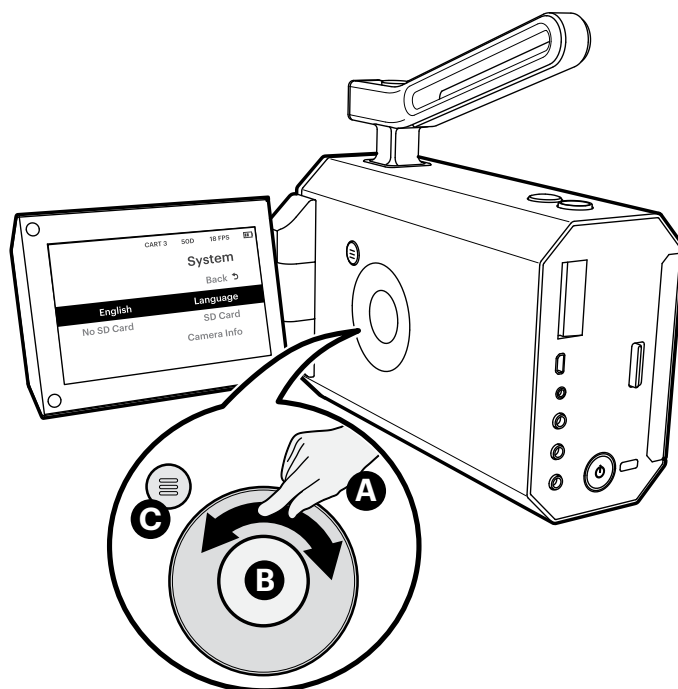

Setup

1. Go to the System screen.
2. Set your Language.

A: Drag your finger around the touch wheel to navigate through a list - clockwise to scroll down, counter clockwise to scroll up.

B: Press the confirm button to choose an item.

C: Press the menu button to toggle between the menu and the viewfinder display.

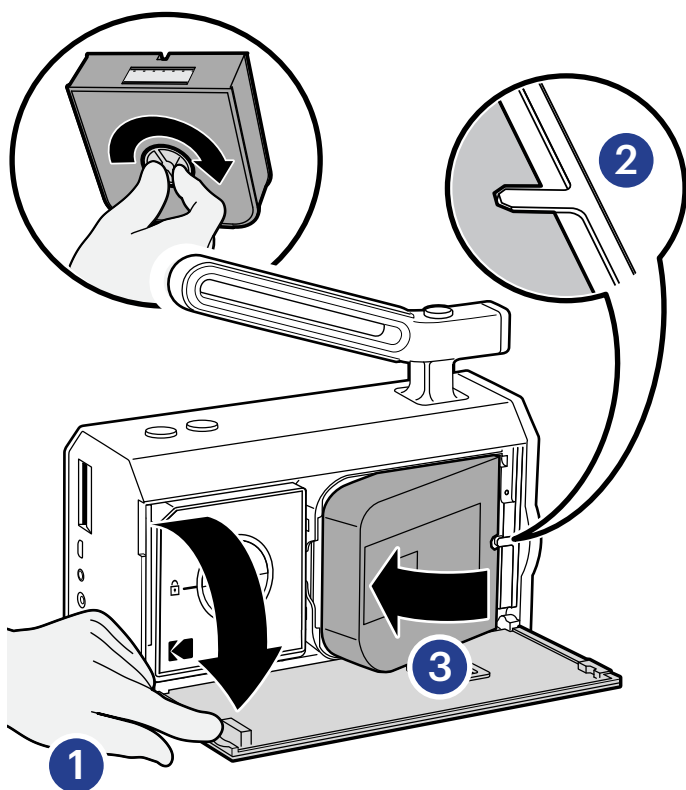

Load the Film Cartridge

Before you load the cartridge, take the cartridge in your hand, label to the backside and the filmstrip to the top. Turn the cartridge transport wheel clockwise to take up slack in the film. 3 turns should take you past the “hump” in the film.

IMPORTANT: Turning the wheel counterclockwise will damage the cartridge.

1. Open the film door.
2. With the power on, insert the cartridge, with the notches toward the front of the camera and the label facing out. Align the cartridge notch with the registration pin.
3. Push cartridge down until it snaps into place.
4. Close the film door.

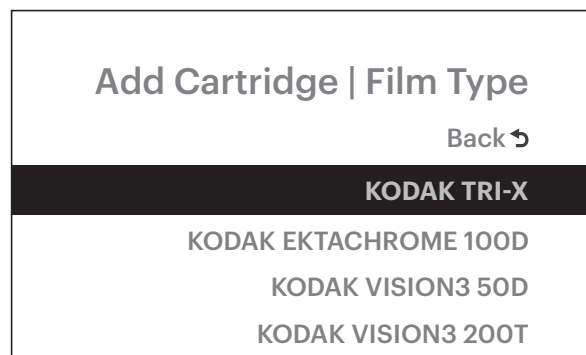
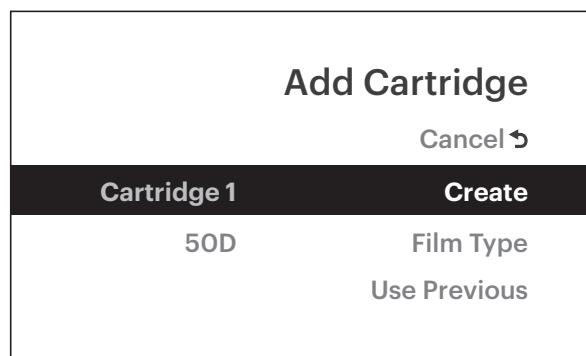

Create Cartridge / Set Film Type

With the power on, the camera detects when a cartridge has been loaded. The Add Cartridge screen will display.

1. Select Create to create “Cartridge1”. You’ll be reminded to mark the cartridge later with that name/number.
2. Select Film Type and then select the type you loaded. The camera automatically adjusts the exposure range for each film type.
3. If you select “Other Film” the camera light meter is disabled. You can expose any film individually by using an external light meter in cine mode.
4. Selecting “Other Film” will simplify cartridge changes by reducing menu selection steps.

TIP: Shoot a practice roll of film to get familiar with your camera and its functions.

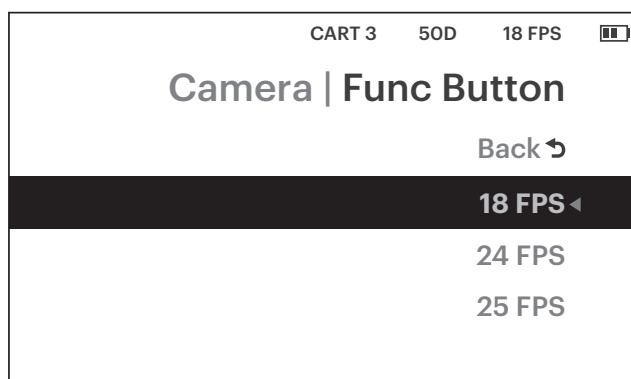
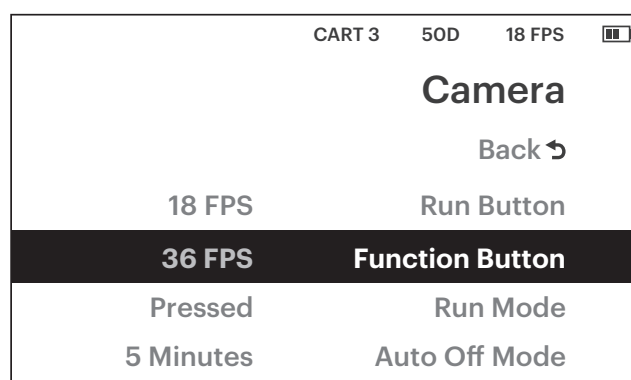
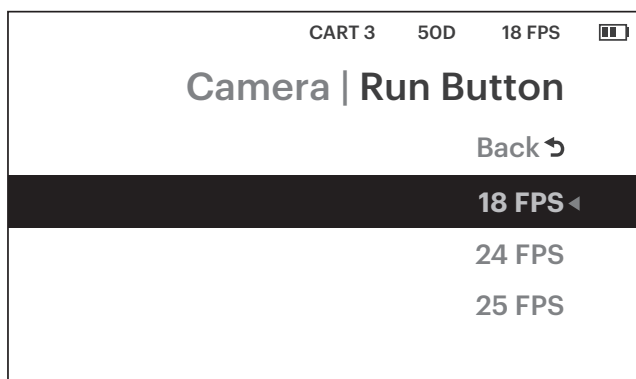
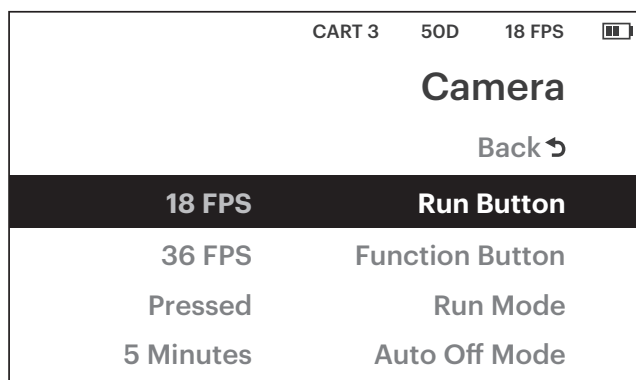

Set Frame Rate

1. Go to the Camera screen.
2. Select Run Button.
Choose the primary frame rate.

FPS = Frames Per Second

18 FPS: ~ 3 minutes, 20 seconds run time (default)

24 FPS: ~ 2 minutes, 30 seconds run time

25 FPS: ~ 2 minutes, 24 seconds run time

36 FPS: ~ 1 minute, 40 seconds run time
(for slow motion on playback)

IMPORTANT: Audio recording is only available for frame rates of 24 FPS and 25 FPS.

Set Alternative Frame Rate (Function Button)

You can temporarily change the frame rate during a scene with the function button. For example, while shooting at 18 FPS, you can switch to 36 FPS for a slow motion effect.

1. From the Camera menu, select Function Button and choose the frame rate.

NOTE: The default value is 36 FPS.

The Function Button is disabled during audio recording.

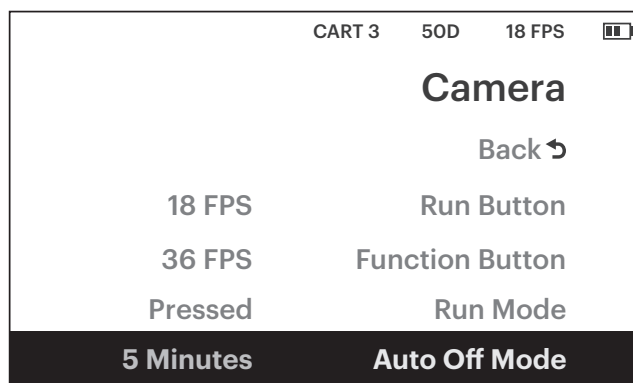
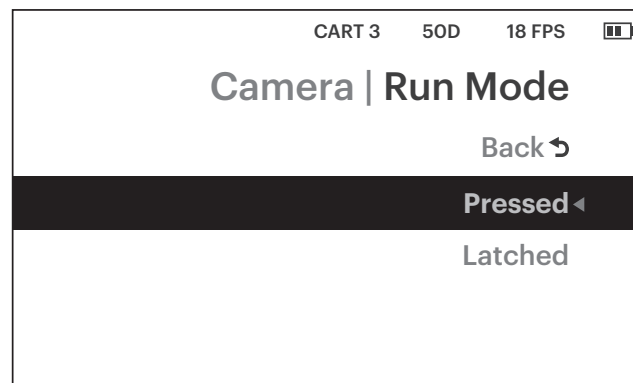
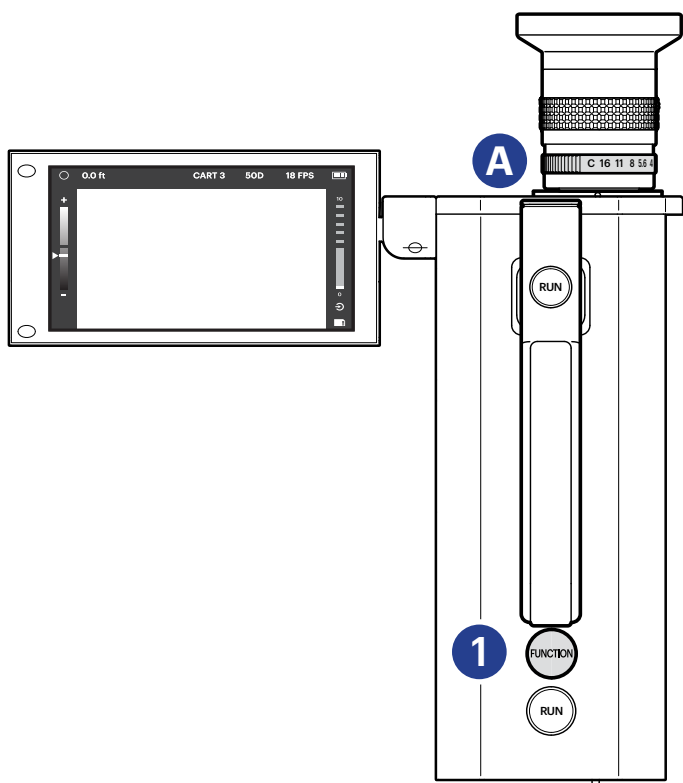

Use Alternative Frame Rate (Function Button)

When shooting, press and hold the function button (while run is still engaged) to change the frame rate.

Filming tip: Changing the frame rate influences the exposure; you may need to adjust the aperture (A) by $+\frac{1}{2}$ stop from 18 to 24/25, or $+1$ stop from 18 to 36 FPS.

1. Release the function button to return to the original frame rate.

Set Run Mode and Auto Off Mode

The run button's **Run Mode** can be set to:

- **Pressed:** press and hold the run button to shoot film, and release the button to stop.
- **Latched:** press and release the run button to start shooting, then press and release again to stop.

Auto Off Mode

- Camera powers off after 15 minutes of idle time. This is the default setting which can be changed in the menu "Camera". This mode helps conserve power when the camera is not in use.
- Press the Power button to turn camera on.

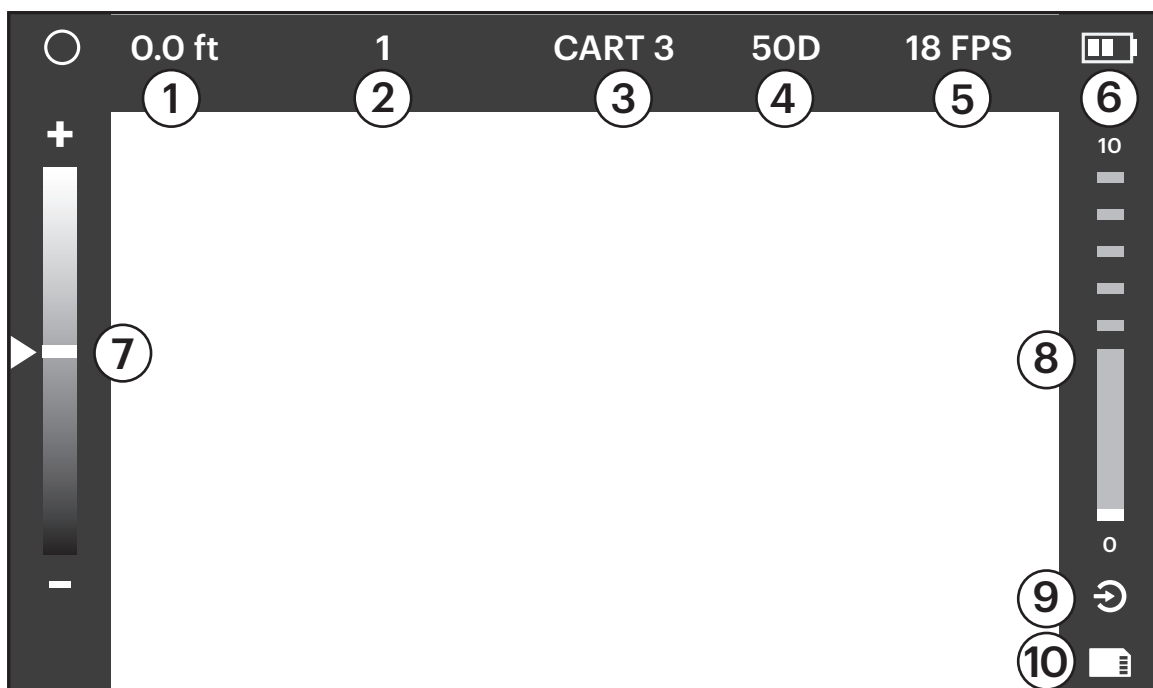

Viewfinder Overview

The Viewfinder is based on an integrated **Video Assist System**, where the image through the lens is bypassed and projected on a frosted ground glass, when the shutter is closed. This technique is also used in video assists on 16 & 35mm motion picture cameras. The projected image is captured with a CMOS camera to get displayed on the LCD. This internal optical path causes a **visible texture** on the viewfinder image, which is an unchangeable part of this optical system.

1 Film Counter: how much film in the cartridge has been used, or remains, in Frames, %, Feet, or Meters. It will turn red when the cartridge is down to the last 5 feet (1.5 m), that is, 10-20 seconds remaining, depending on FPS. Select feet or meters in Viewfinder menu. (Viewfinder > Film Counter)

2 Scene Counter: incremented each time you press the run button. It starts at 1 for each new cartridge. (Viewfinder > Scene Counter)

3 Cartridge Number: the number assigned when you loaded and created a new cartridge

4 Film Type: the cartridge type you selected (Cartridge > Film Type)

5 Frame Rate: the frame rate (for run button, or function button when pressed) (Camera > Run Button/Function Button)

6 Battery Condition: battery charge remaining

7 Light Meter: shows light level; adjust exposure accordingly (Viewfinder > Light Meter)

8 Volume Meter: shows volume level for external mic or line input (Audio > Volume Meter)

9 Audio Input Type: displayed if external mic or line input present (Audio > Input Type)

10 SD Card: displayed if SD Card present

Reminder: Press the menu button to toggle between the menu and the viewfinder display.

Compose the Scene: View Gate / Aspect Ratio Overlay

The camera always exposes the film in an Extended Super 8 gate frame.

NOTE: The Extended Super 8 gate frame is closer to a 16:9 format; a regular Super 8 gate frame is closer to a 4:3 format.

You can set the viewfinder to simulate a Super 8 frame with a vertical bar as a visual aid. (Viewfinder > View Gate)

You can then create a Super 8 frame width during post-production.

You can set the viewfinder to frame a specific aspect ratio as a visual aid. (Viewfinder > Aspect Ratio Overlay)

You can then edit to your chosen aspect ratio during post-production.

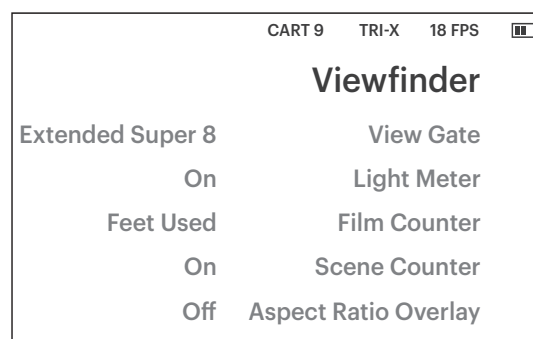
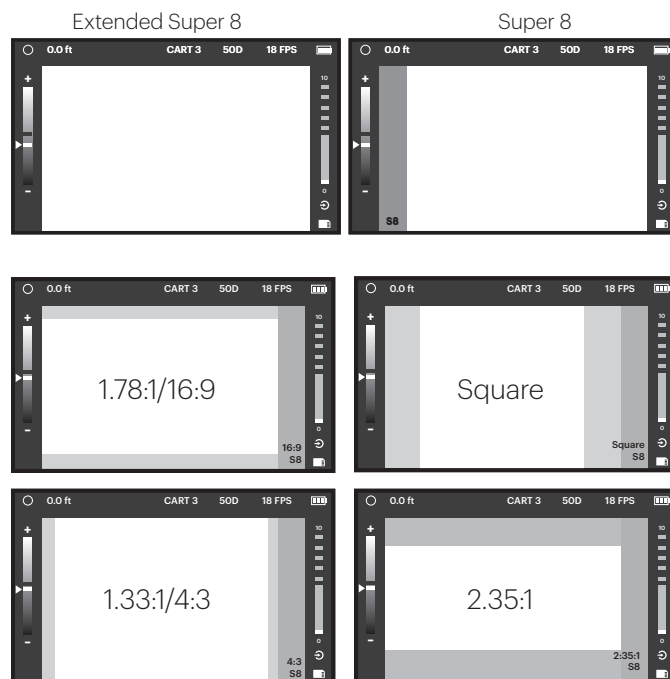

External Display as Viewfinder or Control Monitor

On the backplate of the camera you will find a Micro-HDMI port, where any external display can be connected via HDMI cable. Once the camera is switched on and the HDMI cable is connected to an external display, only the full image from the camera will be exposed on the Super8 film.

The image on Viewfinder LCD display is transferred to the external display and will show as a mirrored image from the LCD viewfinder.

NOTE:

1. Viewfinder information that shows on the camera LCD will not show on the external display.
2. While the camera is connected to an external display via HDMI, the camera UI is inoperable. To use the camera UI you will have to disconnect the camera HDMI from the external display.
3. Please have the camera in the "Viewfinder" mode prior to connecting to an external display via HDMI. If you are using the camera's UI, please select "Back" or press the "Menu Button" to get to the "Viewfinder" mode prior to re-connecting to an external display via HDMI.
4. Any overlay for aspect ratio and cropping guidelines as displayed on the LCD Viewfinder are also displayed on the external monitor.

Sample:

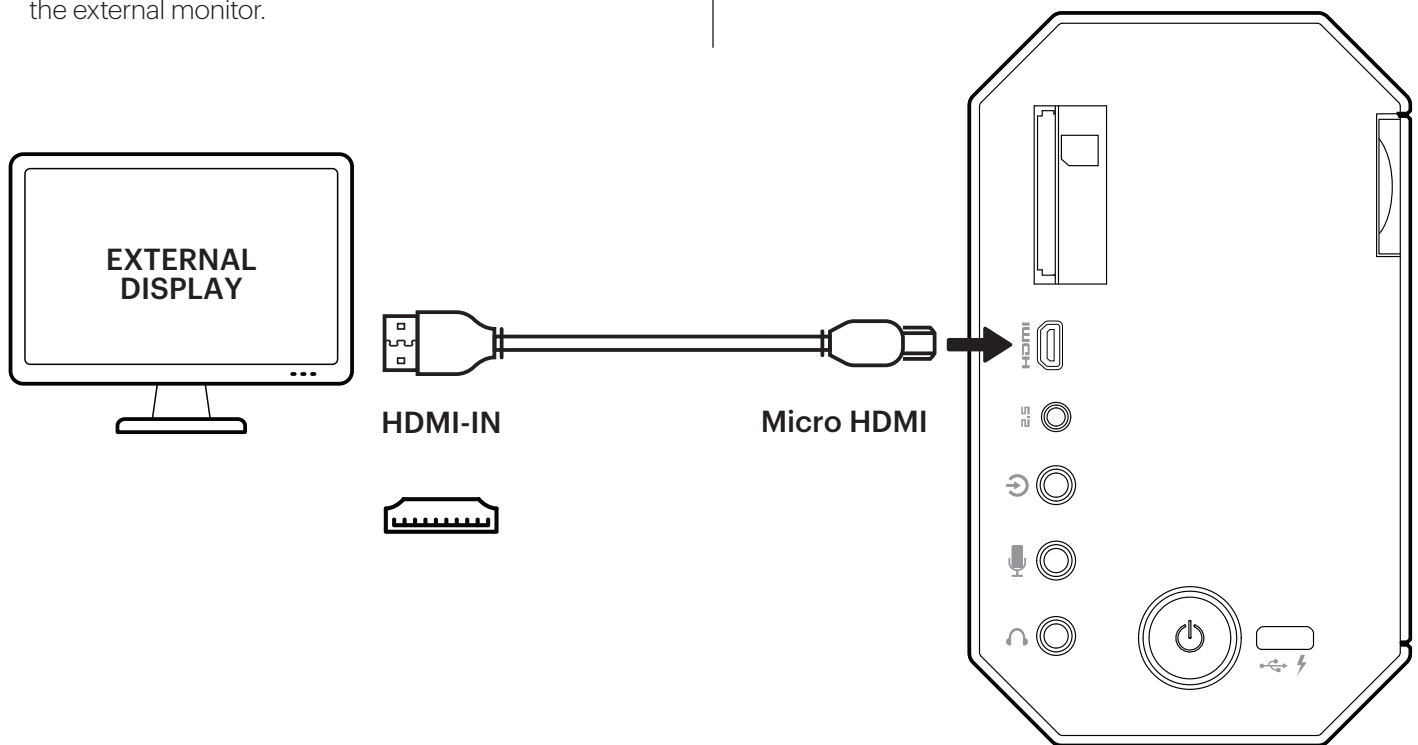
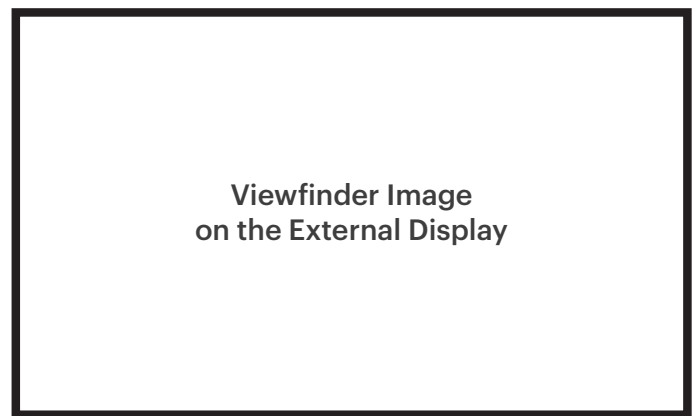
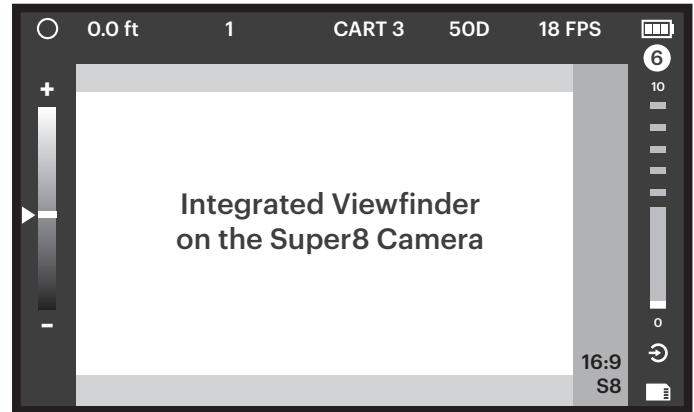

Connecting the Camera with a remote

The KODAK Super 8 Camera can be started and stopped by one of both integrated Run buttons on the camera or with the trigger on the pistol grip, once it is attached and connected.

In addition to that an external Start/Stop button (3rd party product) can be connected to the backplate of the camera.

There you can find a 2.5mm jack connector, where a remote button or an external trigger can be plugged in.

Make sure, that the 2.5mm jack connector is just using a two phase circuit for start/stop, the external monitor.

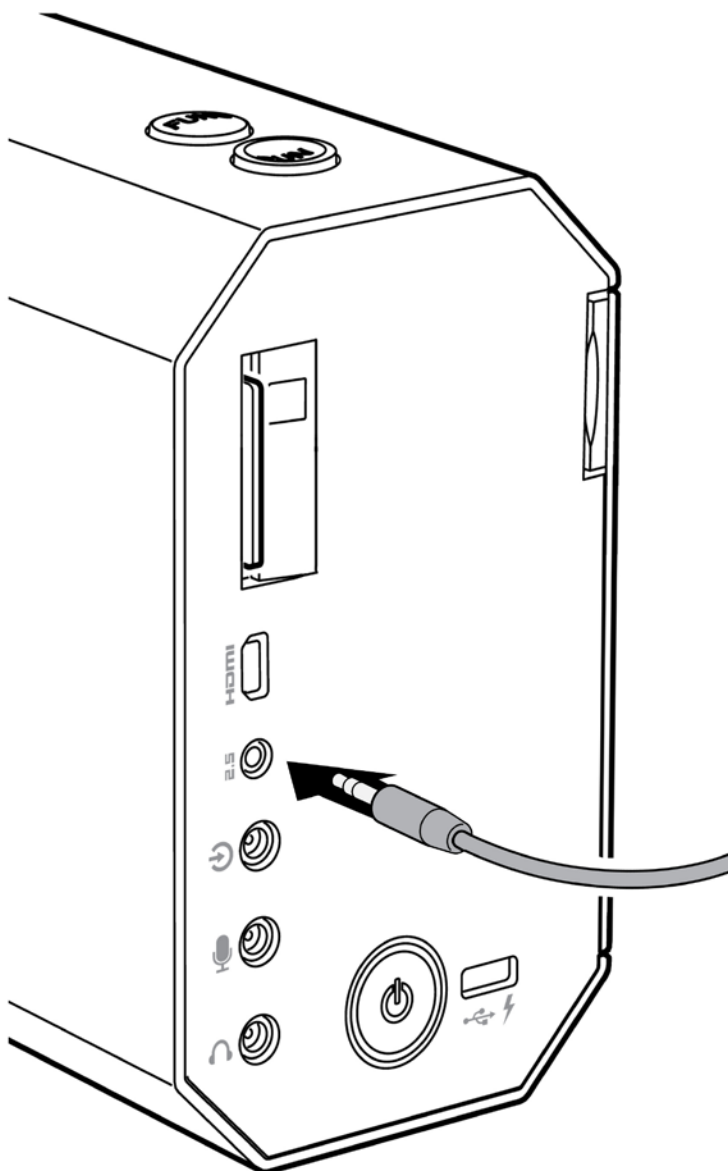
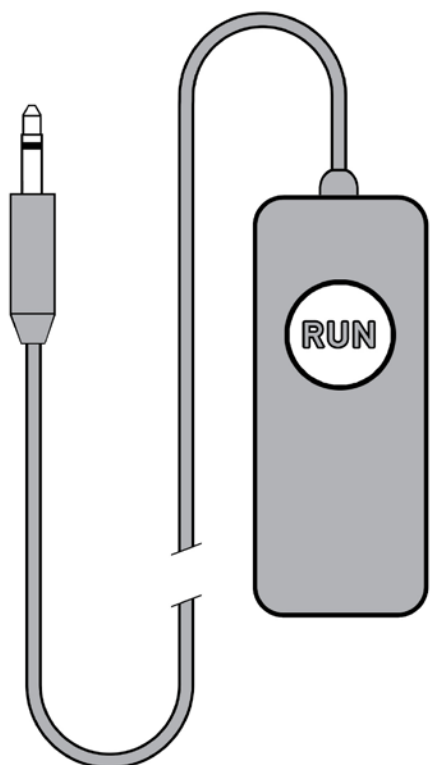

Depending on the setup for the RUN button at the CAMERA menu ("pressed" or "latched") the external remote is replicating the selected setting.

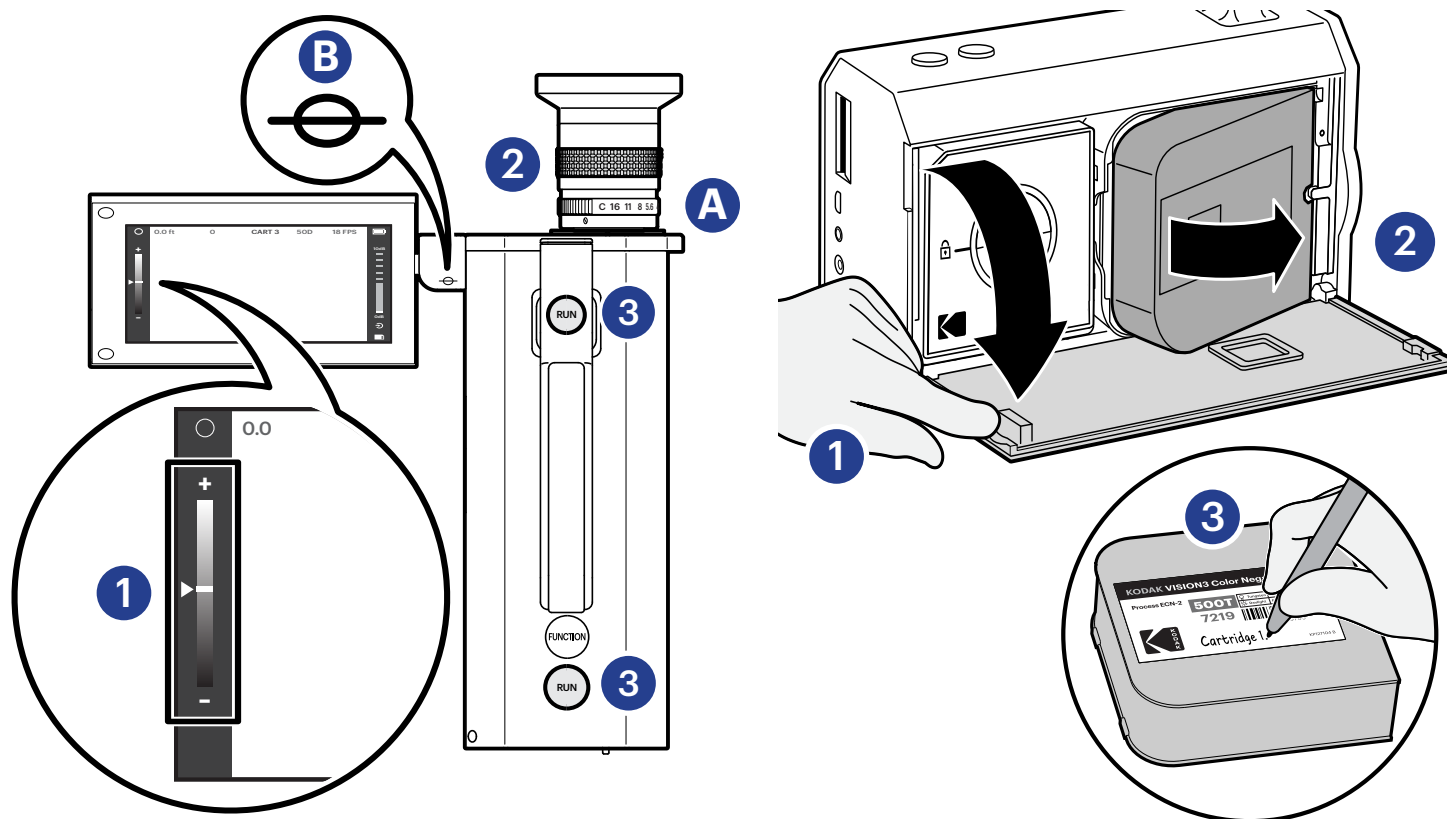

Adjust Exposure, Focus, and Shoot

1. Based on the light meter display, adjust the exposure with the aperture ring (A).
NOTE: The image in the LCD viewfinder is not affected by the exposure setting; it always displays an optimally exposed image, for use in all lighting conditions.
2. Adjust focus with the focus ring.
TIP: For precise focus to the object, measure the distance to the object from the film plane mark (B) on the camera.
3. Shoot film: Press the run button to begin shooting. Shooting will continue until you release the run button, or press it again, depending on how you set the run mode.

Each time you start and stop shooting, you create a scene, starting with Scene1.
Scenes are numbered per cartridge.

See shooting tips at www.kodak.com/go/super8.

Unload and Process Film

To unload the cartridge:

1. Open the film door.
2. Lift the cartridge and pull it out.
CAUTION: To avoid damaging the film gate, do NOT use any tool to pry the film cartridge from the camera.
3. If you haven't already labeled the cartridge with the assigned cartridge number (e.g. Cartridge1), do it now. (A permanent marker works well.)

Super 8 Film processing lab directory is available at: www.kodak.com/go/super8

TIP: Be sure to note the cartridge number.

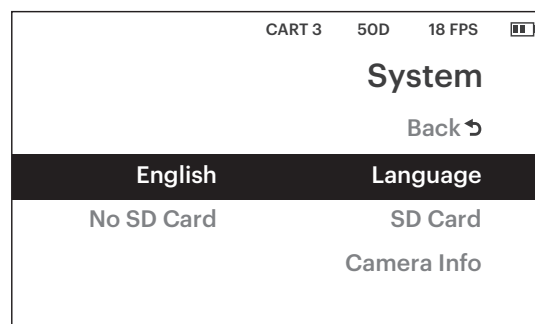
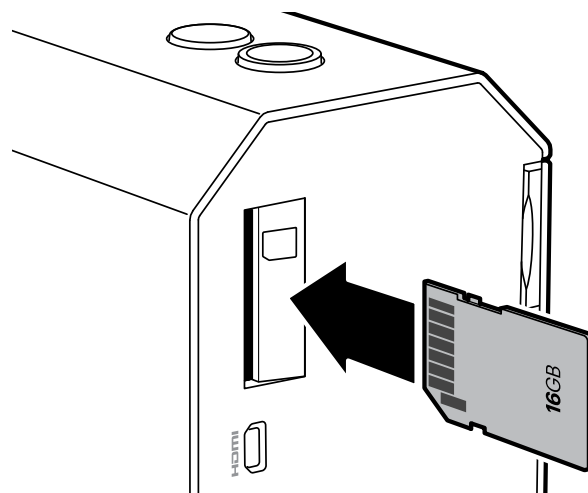

Recording Audio: SD Card

With an external microphone or audio device, you can record audio to an SD card while shooting film.

An audio file is created each time you press the run button, and is named CxxxSyyyFnxxx.wav:

- Cxxx: Cartridge #, starting at C001
- Syyy: Scene #, starting at S001
- Fnxxx: Frame counter value

When shooting, use a clapperboard with the cartridge number, scene number, and frame rate (FPS). This information will be used to synchronize the audio file during edit.

NOTE: Audio recording is only available for frame rates of 24 FPS and 25 FPS. The Function Button is disabled during audio recording.

NOTE: Film footage will be exposed without audio.

Insert and Format SD Card

A 16GB SD card (purchased separately) is recommended. Maximum size: 32GB

1. Insert the SD card.
2. Format the SD card:
 - a. From the System menu, select SD Card.
 - b. Select Erase and Format.

NOTE: Average file size for 1 minute of audio - 11MB.

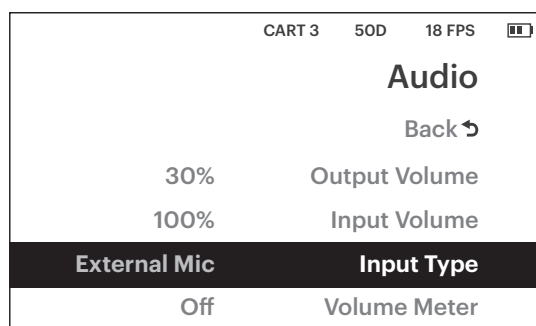
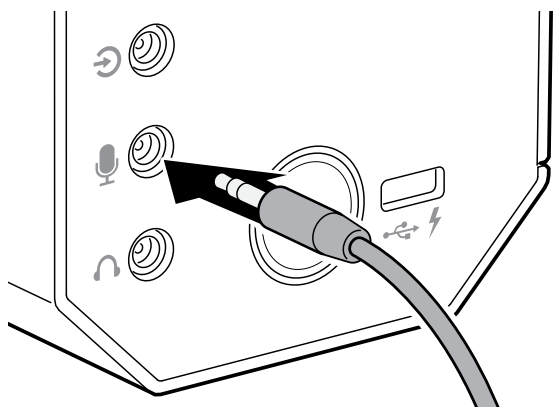

Connect Microphone or Line Input

1. Plug an external microphone (sold separately) into the 3.5mm mic input, OR, plug an external audio device (sold separately) into the 3.5mm line input.
2. From the Audio menu, select Input Type (External Mic or Line Input).
3. For external mic: Adjust the Input Volume as needed, and choose whether to display a Volume Meter.

Line Input: fixed volume input.

NOTE: The 3.5mm mic input does not supply power to the mic.

TIP: You can record audio from an external audio device, such as a digital music or CD player, audio mixer, or musical instrument.

Audio File Management

The digital audio recorded files are saved in .wav format in a specific folder on the SD card.

For every new cartridge, the system generates a new cartridge number folder. The cartridge number assigned by the camera is incremental, starting with default of (1) when the camera is turned on and a cartridge is inserted for the first time. Audio files in the folder are named in the following manner for ease of post-processing. (Example: C0001S0001F0001 where C0001 = Cartridge number, S0001 = Scene number, and F0001 = Frame number). Within the folder the Audio files are stacked with the latest Audio file on top of the stack.

Audio recording is allowed only when shooting at 24fps or 25fps *and* audio input devices are connected and selected. Every start/stop of the RUN button will generate a separate Audio .wav file, provided the Audio file recording conditions are met.

To work with the sound files, the SD card should be inserted in a computer to move or copy the files from the SD card.

NOTE:

- Do not rename the file names on the SD card. Please keep the original file naming and file structure to avoid any conflicts in the camera Audio log files when the SD card is inserted again into the camera.
- You may rename the folders or files only on the external computer or storage device. But not on the SD card used in the camera.

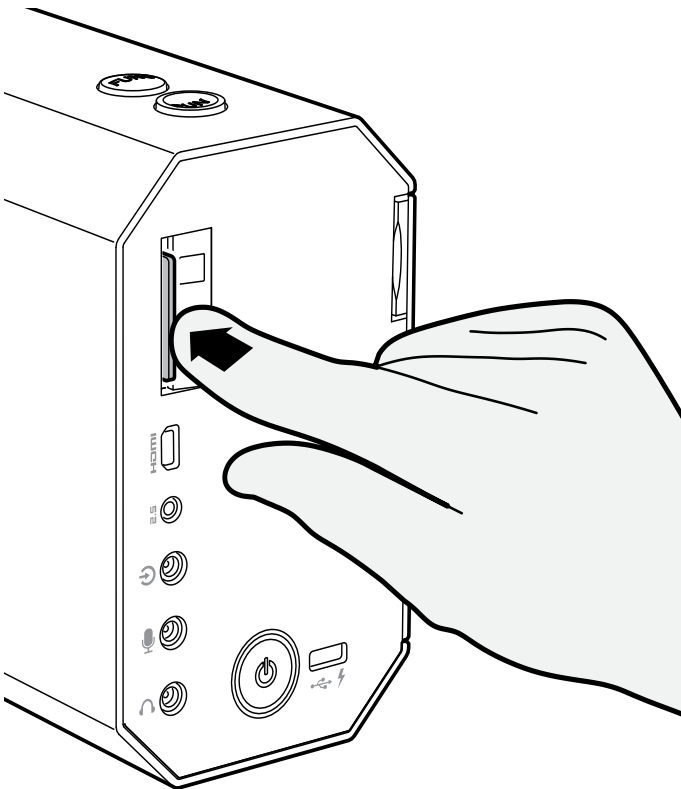

Transfer Audio Files: SD card

1. Gently push in the SD card to eject it.
2. Transfer audio files from the SD card to your computer.

You can synchronize audio with your digital scans using your preferred video editor, such as Final Cut, Premiere, Vegas, etc.





You are good to go when...

1. The battery is fully charged.
2. The camera is powered on.
3. All lens caps have been removed.
4. The film cartridge is fully seated.
5. The lens aperture ring is open (not on "C").

If the LCD screen is black/blank after checking the above:

6. Power on the camera.
7. Reset your film type for optimal exposure.

Troubleshooting

Icon/Problem	Problem/Solution
	Battery is almost empty. Charge the battery.
	Battery is empty. Charge the battery.
	The SD card is almost full. Transfer files to your computer, and then delete files off the SD card, or insert a new SD card.
	The SD card is full. Transfer files to your computer, and then delete files off the SD card, or insert a new SD card.
Camera will not turn on.	Ensure that the battery is correctly inserted and charged.
LCD is difficult to see.	Adjust the screen brightness.
LCD viewfinder view is blurry.	Ensure that the lens is set correctly in focus and is clean. Ensure that the subject is within the right focal distance.
LCD viewfinder does not display on an external monitor.	Ensure that a HDMI Cable is properly connected directly to the monitor input. Ensure that the monitor settings are correct for an HDMI connection.
Film exposure does not look right.	Select your correct exposure set up (aperture & FPS) based on correct film type selection and indicated exposure control. Use the exposure control on the display or an external lightmeter to get correct aperture settings. Critical light situations will probably need individual exposure offsets. NOTE: The image in the LCD viewfinder is not affected by the setting of the aperture ring; it always shows a well balanced image to use the viewfinder in all lighting conditions.

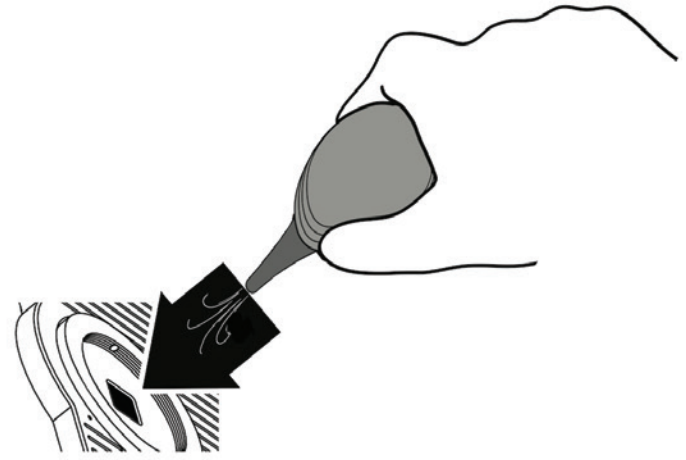
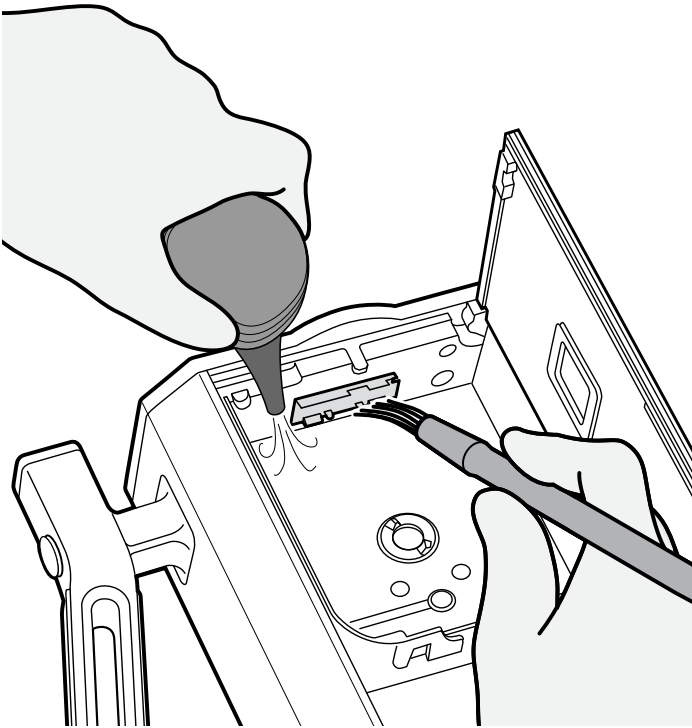

Proper Care of Your Camera

Your camera should be kept in a dry and dust-free environment.

Cleaning: Use a soft microfiber cloth for the body, and a lens cleaning cloth/paper for the lens and LCD.

Clean the film gate after every few cartridge insertions, to remove accumulated film emulsion and dust.

1. Open the film door, and hold the camera with the lens up, so that dust will not fall onto the rear of the lens.
2. Carefully clean the gate with a film camera cleaning brush, making sure nothing gets caught in the gate.
WARNING: Never use any metal to clean the gate.
3. Use a manual air blow bulb to remove all particles at the gate. You can also carefully blow with an air bulb into the c-mount opening to remove small particles and fluffs on the viewfinder ground glass.
WARNING: Never use compressed air out of a can and keep away from mechanical parts!
4. Remove the battery from the camera for extended storage.

See Super 8 tips at: www.kodak.com/go/Super8

Use the camera within this temperature/humidity range:

Temperature	-7°C to 49°C ±2°C (19°F to 120°F ±3°F)
Humidity	15% to 86% RH ±5%RH

Film Storage

Important information on film storage, filters, warm up times and more can be found in the Technical Data specs on the KODAK Super 8 film site.

	Short Term (under 6 months)	Long Term (over 6 months)
Unexposed film in original, sealed package	13°C (55°F) RH below 60%	-18 to -23°C (0 to -10°F) RH below 50%
Exposed film, package unprocessed	<ul style="list-style-type: none"> • -18 to -23°C • (0 to -10°F) • RH below 20% 	<ul style="list-style-type: none"> • Not recommended • Process film promptly

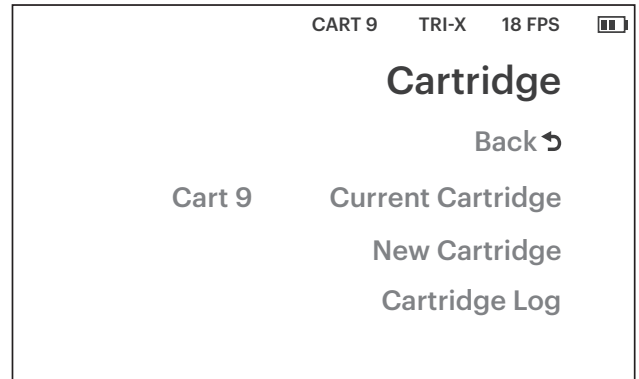
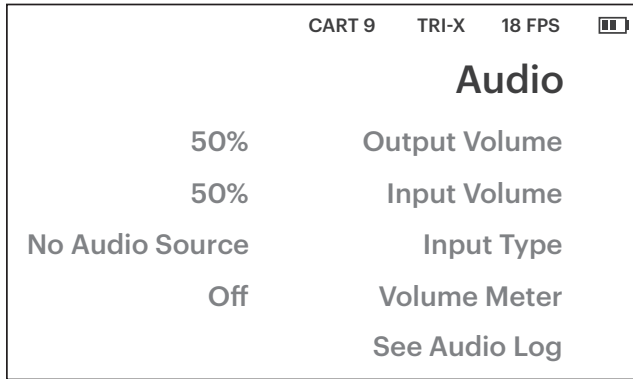

Audio Menu

Setting	Options
Output Volume	<ul style="list-style-type: none"> 0 to 10 (default 5)
Input Volume	<ul style="list-style-type: none"> 0 to 10 (default 5)
Input Type	<ul style="list-style-type: none"> External Mic No Audio Source
Volume Meter	<ul style="list-style-type: none"> On Off (default)
See Audio Log	<ul style="list-style-type: none"> Cartridge <ul style="list-style-type: none"> Scene <ul style="list-style-type: none"> Play Delete

Note: Menu available only, when sound files are created and stored on SD card

Cartridge Menu

Setting	Options
Current Cartridge	<p>View and set options for the currently installed cartridge:</p> <ul style="list-style-type: none"> Film Type <ul style="list-style-type: none"> KODAK TRI-X (default) KODAK EKTACHROME 100D KODAK VISION3 50D KODAK VISION3 200T KODAK VISION3 500T OTHER FILM Audio Log <ul style="list-style-type: none"> Lists all audio clips for the current cartridge, by scene. Scene # <ul style="list-style-type: none"> Play: play the audio clip for that scene Delete: delete the audio clip Delete: delete the cartridge from the camera log.
New Cartridge	<p>Add a new cartridge to the camera. The cartridge is assigned the next available number.</p> <ul style="list-style-type: none"> Create Film Type <ul style="list-style-type: none"> KODAK TRI-X (default) KODAK EKTACHROME 100D KODAK VISION3 50D KODAK VISION3 200T KODAK VISION3 500T OTHER FILM Use Previous (Add Cartridge only)
Cartridge Log	<p>Lists all cartridges added to the camera, by Date, Film Type, and Cartridge number.</p> <ul style="list-style-type: none"> Use this Cartridge Delete

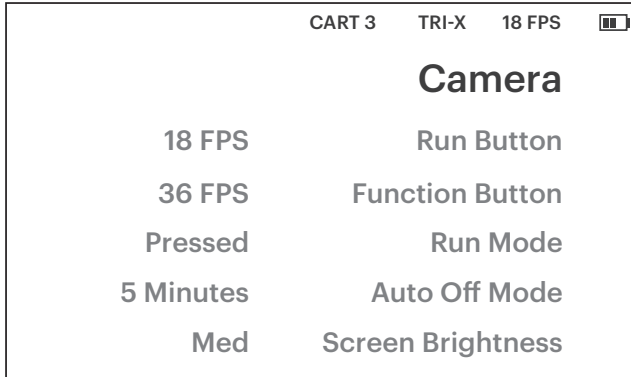

Camera Menu

Setting	Options
Run Button	<p>The Run button starts/stops filming. This setting is the primary frame rate.</p> <ul style="list-style-type: none"> • 18 FPS (default): ~ 3 minutes, 20 seconds run time per cartridge • 24 FPS: ~ 2 minutes, 30 seconds run time per cartridge • 25 FPS: ~ 2 minutes, 24 seconds run time per cartridge • 36 FPS: ~ 1 minute, 40 seconds run time per cartridge; slow motion <p>FPS = Frames Per Second</p>
Function Button	<p>The Function button, when pressed and held while the Run button is pressed, temporarily changes the frame rate. This setting is the temporary frame rate.</p> <ul style="list-style-type: none"> • 18 FPS • 24 FPS • 25 FPS • 36 FPS (default)
Run Mode	<ul style="list-style-type: none"> • Pressed (default): press and hold the run button to shoot film, and release the button to stop. • Latched: press and release the run button to start shooting, then press and release again to stop.
Auto Off Mode	<p>Auto Off Mode: Camera powers off after 15 minutes of idle time. This is the default setting which can be changed in the menu "Camera". This mode helps conserve power when the camera is not in use.</p> <ul style="list-style-type: none"> • Press the Power button to turn camera on • 5 minutes • 15 minutes (default) • 30 minutes • 60 minutes • No Audio Off
Screen Brightness	<ul style="list-style-type: none"> • Min • Low • Med (default) • High • Max

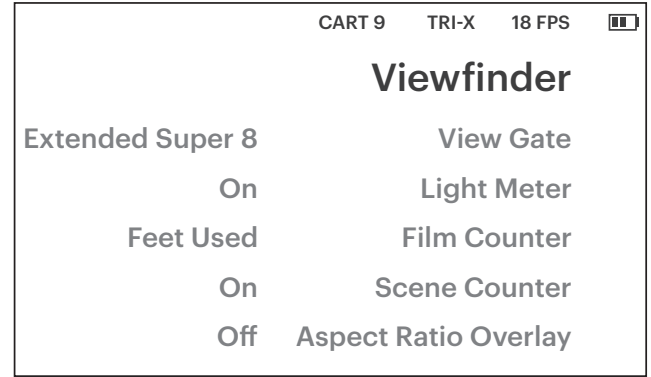

Viewfinder Menu

Setting	Options
View Gate	<ul style="list-style-type: none"> • Extended Super 8 (default) • Super 8
Light Meter	<ul style="list-style-type: none"> • On (default) • Off
Film Counter	<ul style="list-style-type: none"> • Frames used • Frames remaining • % used • % remaining • Feet used (default) • Feet remaining • Meters used • Meters remaining
Scene Counter	<ul style="list-style-type: none"> • On (default) • Off
Aspect Ratio Overlay	<ul style="list-style-type: none"> • Off (default) • 2.35:1 • 1.78:1/16:9 • 1.33:1/4:3 • Square

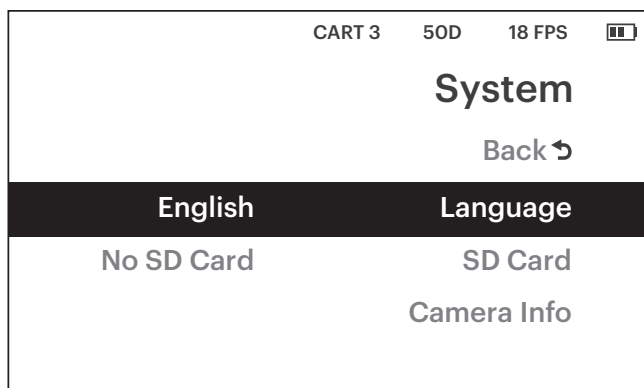

System Menu

Setting	Options
Language	<ul style="list-style-type: none"> • English (default) • German • French • Spanish • Italian
SD Card	Displays GB used and %Full <ul style="list-style-type: none"> • Erase • Format
Camera Info	<ul style="list-style-type: none"> • Update Firmware • Restore Defaults: returns all camera settings to factory defaults • Displays Version • Displays Frames used

Update Firmware

To update the camera firmware, go to:
www.kodak.com/go/super8
 Follow the download instructions.

Update using the SD card*:

1. Copy the firmware file to the SD card, then insert the card into the camera.
2. From the System menu, select Camera Info.
3. The option Update Firmware will appear after the camera detects the file on the SD card. Select Update Firmware, and wait for the update to complete.

* If you have not previously formatted the SD card with the camera, do this first:

4. Insert the SD card.
5. Format the SD card:
 - a. From the System menu, select SD Card.
 - b. Select Erase and Format.

