

KODAK GRAPHIC USERS ASSOCIATION

USER FORUM OVERVIEW



Welcome to the NEW GUA User Forum!

We are excited to introduce the new GUA user forum, designed to help you connect, share, and learn with other KODAK PRINERGY Software users. Below is a guide to help you get started and make the most of this community.

In order to request access to the GUA Forum, you must be registered to use the KODAK Customer Portal.

RETURNING KODAK CUSTOMER PORTAL MEMBERS

1. **Log into the Customer portal**
 - Visit <https://customer.kodak.com>
2. **Click “Manage Applications” menu from profile menu (top right corner).**

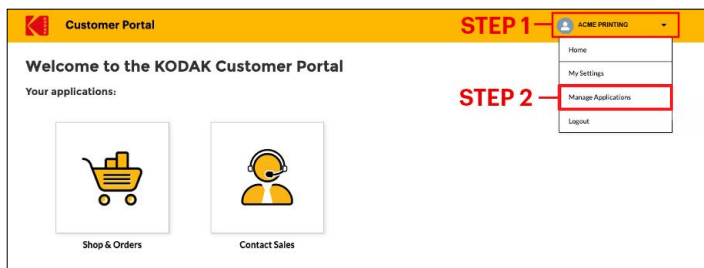

3. **Go to “Available Applications” tab then choose “GUA Forum” module and click “Request Applications” button.**

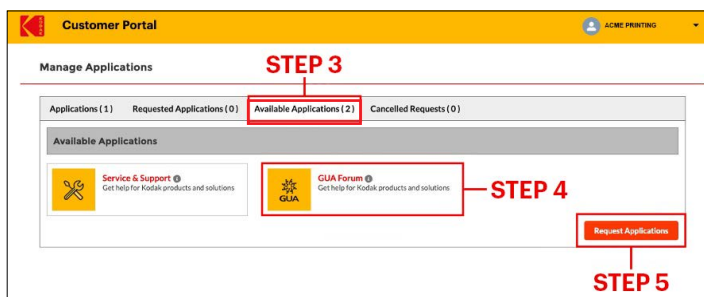

NEW KODAK CUSTOMER PORTAL MEMBERS

1. Visit <https://customer.kodak.com> or scan QR code:



2. **Select “New User Request” and follow the prompts.**

3. **Verify your email address through the confirmation email sent to you (Email will be sent within 24 hours).**

Login:

- You will receive notice via email when your account has been confirmed.
- Use your registered email and password/one-time code to log in.
- Register for the GUA forum by following the instructions shown on the left.

4. **That's it! A Kodak team member will review your request and respond accordingly.**

GUA FORUM GUIDELINES

APPROPRIATE TOPICS FOR THE FORUM

Technical Support:

- Post questions and solutions related to software issues, troubleshooting, and best practices.

Feature Requests:

- Suggest new features or improvements for future software updates.

Tips and Tricks:

- Share useful tips, shortcuts, and workflows that enhance productivity.

Announcements:

- Stay updated with the latest news, updates, and events related to KODAK PRINERGY.

INAPPROPRIATE USE OF THE FORUM

Personal Attacks and Profanity:

- Any form of harassment, bullying, or personal attacks will not be tolerated.
- Foul language will not be tolerated.
- Critique ideas, not individuals.

Off-Topic Discussions:

- Keep discussions relevant to KODAK PRINERGY software. Off-topic posts may be removed.
- Avoid posting advertisements or political content.

Confidential Information:

- Do not share sensitive or confidential information about your company or clients.

We hope you find the Kodak GUA User Forum a valuable resource.

For user assistance, please contact your Kodak Sales Representative.

GETTING THE MOST OUT OF THE FORUM

Search Before Posting:

- Before posting, search for similar topics to avoid duplicates.
- Use clear titles for new threads.

See Popular Trends:

- Review emerging trends and stay ahead of the curve.

Be Respectful:

- Treat all members with respect and courtesy.

Stay Engaged:

- Regularly check the forum for new posts and updates.
- Participate in discussions to help and learn from others.

Enjoy the Community:

- Share experiences and insights and enjoy engaging with others.
- Be open to learning from diverse perspectives.

Understand Limitations:

- This forum is designed for community discussions and shared experiences. It is not intended for software support issues.
- For assistance with technical problems, reach out to our official support team.

