

Kodak ESP 7

All-in-One Printer

print copy scan



User Guide

Kodak

Eastman Kodak Company

Rochester, NY 14650

© Eastman Kodak Company, 2010

Kodak is a trademark of Eastman Kodak Company.

The Bluetooth® word mark and logos are owned by the Bluetooth SIG, Inc., and any use of such marks is under license.

©1989-2007 I.R.I.S. (Image Recognition Integrated Systems), All Rights Reserved

P/N 1K5943

March 2010

Table of contents

1 Getting Help

Help menu	1
Getting answers to frequently-asked questions	2
Contacting Kodak Customer Service & Support	2
Support at Kodak.com	2

2 Printer Overview

All-in-one printer features	3
Major components of the ESP 7 all-in-one printer	4
Support for connecting digital memory devices to the printer	5
Memory card slots	5
Memory cards supported	5
USB host port	6
Control panel layout	6
LCD screen	7
Using the control panel	8
Adjusting the control panel position	8
Using the 4-way navigation buttons	9
Using the OK button	10
Using the Menu button	10
Using the Zoom buttons	10
Using the Start button	11
Using the Cancel button	11
Using the on-screen keyboard	11
Using the printer menus	12
Menu layout	12
Menu structure	13
Status lights	14
Home Center Software	17
Home Center for Windows	17
Home Center for Macintosh	18

3 Setting Up Your Printer

Selecting a printer location	19
Configuring printer settings	19
Configuring basic settings	19
Printer Settings options	20
Setting your printer as the default	20
Configuring network settings	21
Networking resources	21
Configuring an Ethernet network connection	21
Configuring a wireless network connection	22
What you need to know before you connect	23

Configuring basic wireless (Wi-Fi) settings.....	23
Network Settings options.....	24
Wi-Fi setup wizard.....	24
Scanning for wireless networks.....	26
Setting up an IP address.....	27
Verifying network configuration.....	27
Printing network configuration.....	28
Installing your printer on additional computers on the same network.....	28
Changing the printer connection type.....	29
For Windows.....	29
For Macintosh.....	30
4 Handling Paper	
Handling paper.....	32
Loading the paper trays.....	32
Things to keep in mind.....	32
Loading plain paper.....	33
Loading photo paper.....	34
Loading envelopes.....	35
Loading legal size paper.....	35
Loading originals.....	36
Loading an original for copying or scanning.....	36
5 Viewing and Printing Photos	
Viewing photos.....	37
Configuring photo print settings.....	38
Print Photos options.....	39
Printing photos.....	40
Printing photos from a PictBridge camera.....	40
Printing photos from non-PictBridge digital cameras, memory cards, and USB flash drives.....	40
Printing tagged images.....	42
Printing from a Bluetooth-enabled device.....	42
Printing multiple photos.....	43
Printing panoramic photos.....	43
Zooming and cropping photos.....	44
Transferring images to a computer.....	45
Transferring images to a Windows computer.....	45
Transferring images to a Macintosh computer.....	46
6 Copying	
Simple copying.....	47
Adjusting copy settings.....	47
Copy Document options.....	48
Copy Photo options.....	49

7 Scanning

Before you start	50
Simple scanning	51
Simple document scans	51
Simple image scans.....	51
Scanning multiple originals simultaneously	52
Adjusting scan settings	52
Scan options.....	53

8 Maintaining Your Printer

General care	54
Cleaning the scanner glass.....	55
Cleaning the scanner lid.....	55
Monitoring and adjusting the printer's performance	56
Maintenance options.....	57
Replacing ink cartridges	57
Replacing the printhead	60
Upgrading the printer software - for Windows	65
Upgrading the printer software - for Macintosh	66

9 Troubleshooting

Troubleshooting "quick start"	67
General troubleshooting	67
Printer fails to power on.....	67
Device not recognized.....	68
Ink cartridge not recognized	69
Multiple paper feed.....	69
Multiple pictures not scanned properly.....	69
No communication with computer	70
No paper feed	71
One or more of the colors on the calibration sheet is missing	71
Paper jam.....	72
Printer not responding.....	72
Transfer pictures failure.....	72
User guide on the CD is obsolete	73
Wrong paper size	73
Macintosh OS X troubleshooting.....	73
Windows Vista troubleshooting.....	74
Home Center software on Windows works incorrectly following software upgrade	74
Print troubleshooting	74
Envelope printing incorrect	74
PictBridge camera not detected.....	75
Picture cropped	76
Picture print smudged	76

Picture will not print.....	76
Poor print quality	77
Print skewed or slanted	77
Print spotted	77
Print too dark.....	78
Print too light	78
Printing slow	78
Printing stops.....	78
White edges on borderless prints.....	79
Copy troubleshooting.....	79
Copy cut off.....	79
Scan troubleshooting.....	79
Scan fails.....	79
Scanned image blank.....	80
Network troubleshooting.....	81
Wired network troubleshooting	81
Wireless troubleshooting.....	85

10 Product Safety Specifications

Print Performance.....	90
Photo Printing Features.....	90
Copy Document Features.....	91
Copy Photo Features	91
Scanning Features	91
Paper Tray Features	92
Ink Tanks.....	92
Connectivity	92
Software Support.....	92
Physical Specifications	93
Warranty.....	93
System Requirements.....	93
Windows PC.....	93
Macintosh.....	94
Papers Supported	94
Paper Sizes for PC and Macintosh computers.....	95
Safety Specifications.....	96
Parts.....	96
Power.....	96
Location.....	97
Environment.....	97
Regulatory Compliance.....	98
FCC Compliance and Advisory	98
FCC and Industry Canada	98

IC Radiation Exposure Statement.....	99
Canadian DOC Statement.....	99
European Compliance Statement.....	99
German Compliance Statement	99
Waste Electrical and Electronic Equipment Labeling.....	100
Declaration of Conformity	101

Glossary

Appendix A: If You Need to Call Customer Support

Getting Help

This user guide helps you learn to operate your all-in-one printer from the control panel. Kodak also provides online help in the Home Center Software installed when you set up your printer, and helpful information about common tasks from the LCD screen on the printer control panel.

NOTE: Home Center Software must be open on your computer to access its help.

NOTE: The “Start Here” booklet that came in the printer box provides instructions for setting up and configuring your printer.

Help menu

You can get instructions for performing the following tasks from the menu displayed on the LCD screen.

Help Menu Options
Install Ink Cartridges
Copy a Document
Copy a Photo
Print a Photo
Scan a Document
Scan a Photo
Wi-Fi Setup
WiFi Setup

To display Help menu information on the LCD screen:

1. From the printer control panel, press **Menu**.
2. Press ▼ until **Help** is the highlighted option on the Main menu, and then press **OK**.
3. As needed, press ▼ until the desired option is highlighted, and then press **OK**.
4. Follow the prompts on the LCD screen to view the available information.



Tip: Press ▲ and ▼ as needed to scroll up and down to see all the available information.

Getting answers to frequently-asked questions

See [Chapter 9, Troubleshooting](#) for help resolving a number of issues about printing, copying, scanning, and configuring the wireless service on your printer.

Contacting Kodak Customer Service & Support

Kodak provides several resources to help you answer questions about your printer.

Support at Kodak.com

Support	Description	Internet Address
All-in-one printer support	Support Center home page	www.kodak.com/go/support
	Get support for your product (FAQs, troubleshooting information, etc.). Tip: Print a test page before contacting Kodak support (see If You Need to Call Customer Support, page 106).	www.kodak.com/go/faqs
	Purchase a full range of digital camera and printer accessories.	www.kodak.com/go/accessories
	Download latest printer software, firmware, drivers, setup booklet, and user guide for your printer.	www.kodak.com/go/downloads
Software	View online tutorials for using Home Center Software (Windows only).	www.kodak.com/go/howto
	Get information on KODAK EASYSHARE Software.	www.kodak.com/go/easysharesw
	Get help with the Windows operating system and working with digital images.	www.kodak.com/go/pcbasics
Wi-Fi and Ethernet	Get help with Wi-Fi and Ethernet.	www.kodak.com/go/inkjetnetworking
Other	Learn ways to use your printer to create fun and memorable projects	www.kodak.com/eknec and then click the Tips & Projects Center tab on the page
	Register your printer.	www.kodak.com/go/register
	Locate Telephone Customer Support numbers in various countries	www.kodak.com/go/contact

The KODAK ESP 7 All-in-One Printer allows you to print, copy, and scan images and documents. Although many functions can be operated directly from the control panel, you may also print, store, and manage digital images from a Windows or Macintosh computer connected to the printer via Kodak's Home Center Software, which installs during the printer setup process. In addition, this printer supports networking, allowing you to access the printer over a wireless (Wi-Fi) or wired (Ethernet) network.

All-in-one printer features

This printer includes:

- A printhead system with two Kodak high-quality pigmented ink cartridges
- An integrated printing accessory that produces two-sided printing from a connected computer
- A bottom paper tray that supports multiple media, including A4, Letter, Legal, 8x10, 5x7, 4x6, 4x7, and 4x12 paper, transparencies, and envelopes
- A top paper tray that supports 4x6, 4x7, and 5x7 photo paper and engages and disengages automatically
- A scanner capable of scanning up to A4 (length) and Letter-width originals
- Multi-format memory card support
- A Universal Serial Bus (USB) host port on the front of the printer for connecting a variety of external devices to the printer, including Picture Transfer Protocol (PTP) enabled digital cameras, USB flash ("thumb") drives, and Kodak Bluetooth USB 2.0 adapters ("dongles")
- A client USB device port on the back of the printer, for connecting the printer to host Windows or Macintosh computers
- Energy-saving low power mode
- Networking capability, including wireless (Wi-Fi) and wired (Ethernet)
- A control panel with push buttons, light indicators, and a 3-inch LCD screen
- One network (Ethernet) port

Major components of the ESP 7 all-in-one printer

The graphics below show the main components of the printer.



Number	Component Name
1	Scanner lid
2	LCD screen
3	Top paper tray
4	Bottom paper tray extender tab
5	Bottom paper tray
6	Paper-edge guide
7	Paper output tray
8	USB host port
9	Memory card slots
10	Control panel
11	Recessed handle for printer access door
12	Power cord connection port
13	Ports for connecting printer to the computer or Ethernet
14	Two-sided printing accessory
15	Scanner glass
16	Paper output tray extender
17	Rear-access cleanout area
18	Printer access door
19	Printhead

Support for connecting digital memory devices to the printer

Your printer allows you to connect both digital camera memory cards and USB-connected devices for previewing and printing. You can also transfer photos and document files to your connected computer.

CAUTION:

Connect only one external memory device to your printer at a time. If both memory card slots, or any memory card slot and the host USB port, have a device connected to them simultaneously, the printer cannot access the photos or documents contained on any of them. If your printer cannot recognize a device you have connected to it, make sure that only one device is connected at a time.

Memory card slots

The printer has two card slots; insert and use only **one** memory card at a time.



WARNING: Do NOT remove the memory card while the light blinks, or you may damage the card.

A blue light, located above the memory card slots, blinks while the card is being accessed and stays lit while the card remains in the slot and the printer is on.

Memory cards supported

The printer supports the following memory cards, used in most digital cameras:

- **XD** xD-Picture Card
- **MS** Memory Stick, Memory Stick Pro and Magic Gate
- **SD** Secure Digital Card, Multi-Media Card
- **CF** Compact Flash type I and type II, including micro drives
- **SDHC** Secure Digital High Capacity cards



Additionally, the printer supports the following memory cards used with Memory Stick and SD/MMC card slot adapters, which you will need to purchase separately:

- Memory Stick Duo and Memory Stick Duo Pro
- miniSD
- MicroSD (TransFlash)

USB host port

This printer works with most digital cameras. Using the USB port located on the front of the printer, you can connect one of the following devices to the printer at a time:

- PictBridge camera
- USB portable storage drive
- Kodak Bluetooth dongle
- Digital cameras

NOTE: This printer can read only one memory card OR one portable USB drive OR one Kodak Bluetooth dongle at a time.

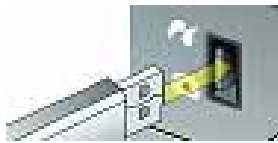

Control panel layout

The legend describing the numbered parts of the control panel illustration is in the table below.

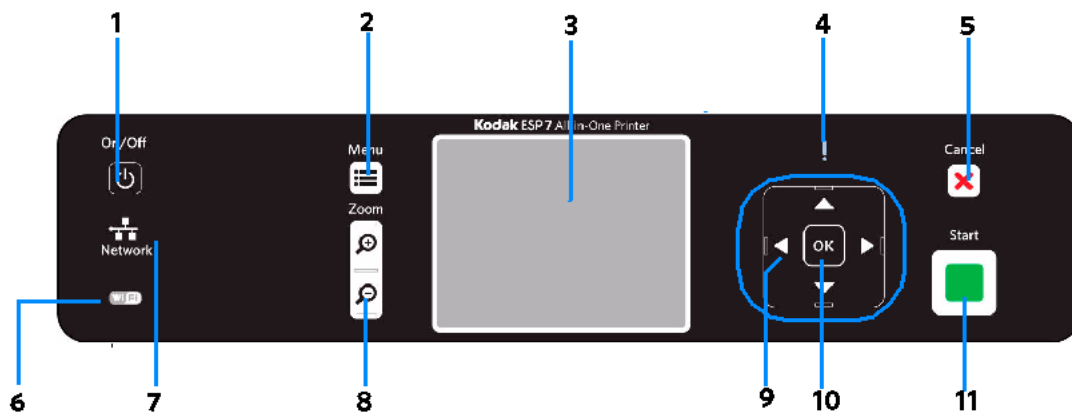

Number	Name	Description
1	On/Off button	Powers the printer ON or OFF.
2	Menu button	Displays the menu, and toggles between parameters screens and preview screens.
3	Screen	Displays photos, messages, status, and menus.
4	Attention light	Blinks or flashes when an error occurs.
5	Cancel button	Cancels the current operation and control panel navigation, and returns you to the menu.
6	Wireless network status light	When lit, signals that a wireless (Wi-Fi) network connection is active. If the LED is illuminated, you may not be connected to the network yet. Go to Network Settings, View Network Configuration, and verify that it says it is Network and Connected. Blinks when searching for an available Wi-Fi network within range, or when the existing signal is too weak to transmit or receive wireless signals.
7	Ethernet network status light	When lit, signals that an Ethernet network connection is active.
8	Zoom buttons	Let you zoom in and out of a photo.
9	4-way navigation buttons	Enable you to navigate menus and photos, and pan around a zoomed photo.
10	OK button	Enables you to complete a menu selection or photo print command, or allows you to continue with the current operation.
11	Start button	Starts the following operations: copy, scan, print, and transfer.

NOTE: See [Adjusting the control panel position, page 8](#) for instructions on raising and lowering the control panel so that it is easier to use.

LCD screen

The LCD screen displays photos, messages, instructions, and menu items. Menu navigation is accomplished with the 4-way Navigation buttons on the control panel.

The LCD Start-Up screen displays when the printer is ready for operation but is not performing a task. The screen also displays the current level of black and color ink.



The first time you use your printer and press the **Menu** button (described on [Using the control panel, page 8](#)) on the control panel, the Main menu displays on the LCD screen.

The contents displayed in the Main menu include:

- Copy Document
- Copy Photo
- View and Print Photos
- Scan
- Network Settings
- Printer Settings
- Maintenance
- Help

To review the tasks you perform when you use the options available on the Main menu, see [Using the printer menus, page 12](#).

Using the control panel

Adjusting the control panel position

The position of the control panel can be adjusted from its default position (flush against the front of the printer) to lifted upward at an angle.



To adjust the control panel position:

1. On the rear side of the control panel, locate the release tab.
2. Press the front of the control panel and the release tab toward each other with your thumb and fingers; maintain this position and pull the control panel toward you gently.
3. When you are satisfied with the position of the control panel, let go.
4. To return the control panel to its default position, squeeze the release tab and gently push the control panel away from you. Let go when the panel is seated against the front panel of the printer.

Using the 4-way navigation buttons

NOTE: The **OK** button is located in the center of the 4-way navigation buttons on the control panel. Its use is described in [Using the OK button, page 10](#).

- Pressing ▼ highlights the next row down in the visible menu. When the last row in a menu is highlighted, pressing ▼ causes the visible page to be replaced with the following page in a multi-page menu, with the top row highlighted; in a one-page menu, this action highlights the top item.
- Pressing ▲ returns you to the previous page in a multi-page menu.
- After you have initiated the process of zooming when a photo is shown on the LCD screen, pressing ▼ or ▲ pans the focus up or down. (See [Using the Zoom buttons, page 10](#).)

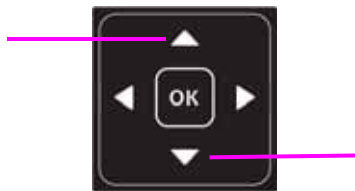

Tip: When you have selected a photo or document shown on the LCD screen to be printed, pressing ▲ or ▼ increases or decreases the output quantity. If you have selected more than one item for printing, you can specify a different quantity for each one. The LCD screen displays the number of copies of each selected item to be printed. Using this feature does not change the number of files stored on your camera or portable USB drive, however.

- When there are two or more options for the setting shown on the selected menu row, the current value is displayed between the ◀ and ▶ symbols. Pressing ◀ or ▶ on the control panel scrolls through the choices.

Preview ◀ Yes ▶



- When a photo is displayed on the LCD screen, after you have pressed the **Zoom+** button pressing ◀, ▶ moves the focus in the direction you have used.

NOTE: The **Zoom+** and **Zoom-** buttons on the control panel are discussed in [Using the Zoom buttons, page 10](#).

- When you are viewing a group of photos stored on a portable memory storage device such as a USB drive, pressing the ◀ or the ▶ button allows you to scroll through the images.
- Continuing to press any of the 4-way navigation buttons causes them to repeat the action until you release it.

Using the OK button

Press **OK** to:

- Accept the setting displayed in the selected row in the current menu.
- Accept the preview on the LCD screen of something that you want to print, copy, or scan.
- Select a photo for printing.



Tip: When previewing a group of images from a digital camera, portable USB drive, or memory card connected to the printer, press and hold **OK** to select all images not previously selected for printing in the default quantity stored in your printer. (Images already selected will not be affected.) Press and hold **OK** again to deselect all images.

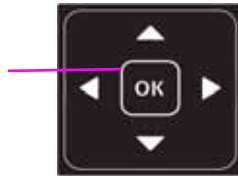

Using the Menu button

Press **Menu** when:

- You want to set up a new task and anything other than a menu is visible on the LCD screen.
- You are viewing an image on the LCD screen and want to use the Photo Options menu.
- You want to view the parent of the last menu displayed.



Using the Zoom buttons

Press **Zoom+** when an image is displayed on the LCD screen and you want to adjust the area to be printed, copied, or scanned. When this feature is available, the printer displays a prompt to press **Zoom** on the image shown on the LCD screen.

Once you have activated zoom for the selected item, you can then use both the **Zoom+** (zoom in) and the **Zoom-** (zoom out) buttons.

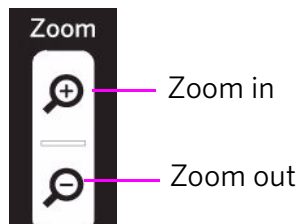

Using the Start button

Press **Start** to initiate the print, copy, or scan task you are working on with the current settings.



Using the Cancel button

Press **Cancel** when:

- You want to interrupt an operation that has already started.
- You are viewing a menu that you opened by selecting an option on a different menu, and then decide that you want to view the previous one.

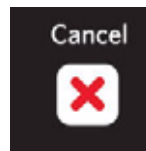

Using the on-screen keyboard

The on-screen keyboard displays in the LCD screen for entering authentication information, such as a security string, for connecting the printer to a wired (Ethernet) or wireless (Wi-Fi) network, in the Network Settings menu

To maneuver around the on-screen keyboard, use the 4-way navigation buttons, described in [Using the 4-way navigation buttons, page 9](#), and the OK button, described in [Using the OK button, page 10](#).

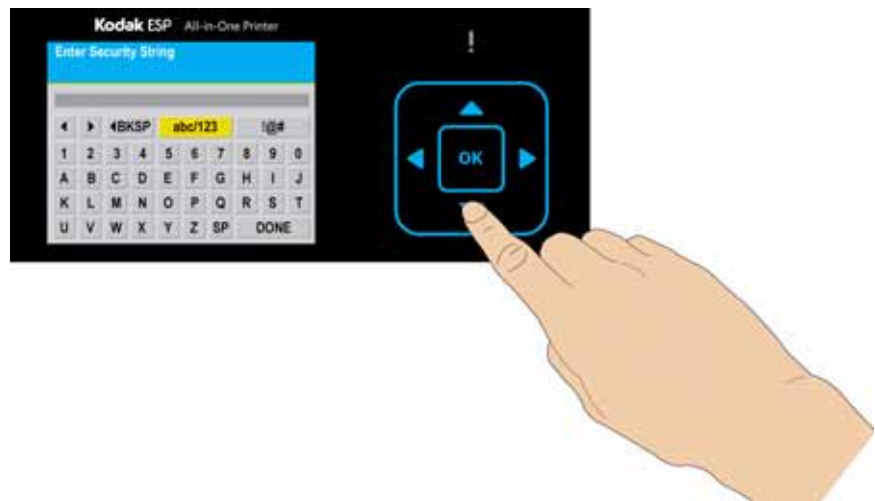

Using the printer menus

Use the menus on the LCD screen to select stand-alone tasks (that is, tasks that can be performed without your computer), such as copying documents or photos; or printing photos stored on memory cards, USB drives, Kodak Bluetooth adapter (“dongle”), or digital cameras plugged into the printer; or sending a fax.

Using the appropriate menu, you can also initiate tasks that will be completed on a computer connected to the printer, such as transferring photos from a compatible device connected to the printer (such as a memory card, digital camera, or USB drive) to the computer.

Your printer updates the content of the menu dynamically, according to the tasks you perform.

Menu layout

A description of how the menus are displayed in the printer control panel is shown in the illustration and the legend below.

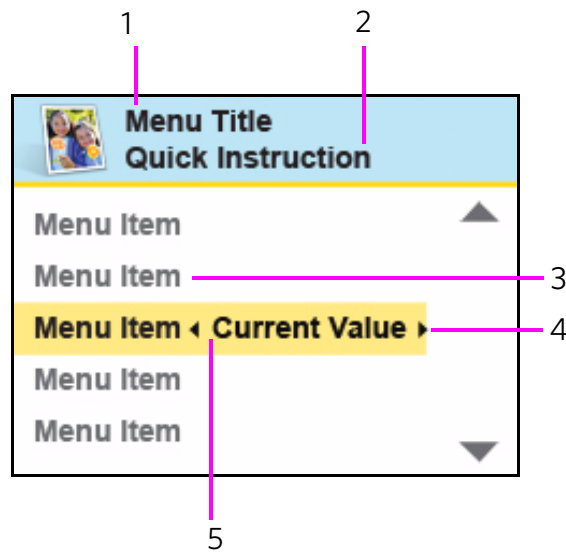

Number	Description
1	The Menu Title displays at the top of the menu. It names the category of available options. For example: Copy Document Options, Print Photo Options, etc.
2	The text displayed in the Quick instruction section, when displayed below the Menu Title, describes how to activate the selected menu option. For example: Press OK to continue, etc.
3	Any option in a row with a white background has not been selected. To use the option in a white row, you must navigate to it by pressing either the ▼ or the ▲ button on the control panel. See Using the 4-way navigation buttons, page 9 .
4	The Current Value content displayed between ◀ and ▶ symbols indicates the active setting only when you have more than one setting available. For example: On/Off, Yes/No, a number representing a quantity, etc.
5	The option in the row with the golden background is the selected option. Its functionality is enabled when you press the appropriate control panel button. When ▼ or ▲ are pressed, the selected menu option changes according to the direction used. See Using the 4-way navigation buttons, page 9 .

Menu structure

The top-level menu on your printer is the Main menu. When you press **OK** on most Main menu items, another menu displays. You can press **Start** as specified in the Quick instruction section beneath the menu title (see item 2 in the “Menu layout” illustration and accompanying table, above) to initiate a task.

You can review details about each menu available in your printer using the information below:

Main menu option	When you press OK:	To review details about the option:
Copy Document	Displays Copy Document Options menu	See Copy Document options, page 48
Copy Photo	Displays Copy Photo Options menu	See Copy Photo options, page 49
View and Print Photos	Displays Print Photos Options menu	See Print Photos options, page 39
Scan	Displays Scan Options menu	See Scan options, page 53
Network Settings	Displays Network Settings menu	See Network Settings options, page 24
Printer Settings	Displays Printer Settings menu	See Printer Settings options, page 20
Maintenance	Displays Maintenance menu	See Maintenance options, page 57
Help	Displays Help menu	See Help menu, page 1

Status lights

The tables below describe the meaning of each light and condition, and offer tips on what action to take.

On/Off Lights		
Light Status	Cause	Action/Solution
Off	The printer is turned off.	Press On/Off to turn the printer on.
	The printer does not have power applied.	Ensure that the printer power cord is properly plugged into the back of the printer. Verify that the power supply and/or power cord LED is lit. Check that the power supply is connected to the power cord, and that it is properly connected to the electrical outlet. ^a
Blinks	The printer is initializing or busy.	None. Allow the printer to finish the initialization process.
On	The printer is ready.	None.

^aMost power supplies used with this printer are equipped with a status light which illuminates when electricity is applied. If you cannot determine if the power supply is working properly, contact Kodak Service & Support for assistance.

Printer Power Cord Light		
Light Status	Cause	Action/Solution
Off	The printer power cord is not properly connected to the printer.	Reconnect the printer power cord plug to the printer.
	The electrical power cord is not properly connected to your electrical outlet.	Reconnect the cord to the electrical outlet. Ensure that the electrical power cord is fully connected to the alternating current (AC) adapter at the end of the printer power cord.
	The electrical outlet has no power.	Plug a working device into the wall outlet to test it, or have it checked by an electrician.
	The problem may lie with the power supply.	Check the power supply status light, if available. As needed, visit Kodak.com for additional troubleshooting steps, or contact Kodak Service & Support.
On	The power supply is supplying power to the printer.	None.

Attention Light	
Light Status	Error
Off	None.
Blinks (slow) The LCD screen describes the error.	Paper jam. Paper tray empty. Paper carriage stall. Paper size or type mismatch. Change ink cartridge. Ink cartridge not readable. Printhead not calibrated. Unit open, scanner lid open, rear access door open. Too many image sources. Printhead not installed. Unable to read memory card or USB host device.
Blinks (slow)	Ink cartridge(s) inserted incorrectly. Ink cartridge(s) not installed.
On	Media sensor failure. Printhead failure. Scanner failure.

Memory Card Slot Light		
Light Status	Cause	Action/Solution
Off	Either the memory card is not inserted or is improperly inserted in the card slot.	Remove and reinsert the memory card.
Blinks	The internal card reader is initializing or communicating with a memory card.	None.
On	A memory card is properly inserted in the card slot.	None.

Wi-Fi Status Light		
Light Status	Cause	Action/Solution
Off	This indicates that the Wi-Fi radio is turned off and the printer is not connected to a wireless network.	None.
Blinks continuously	The Wi-Fi radio is turned on and the printer is searching for available wireless networks within range.	None, unless you want to stop the connection process. If so, turn the Wi-Fi radio off.
Blinks intermittently The LCD screen displays an error message	The Wi-Fi radio is turned on and: <ul style="list-style-type: none"> ▪ The printer cannot find any available wireless networks within range. or ▪ The Wi-Fi network connection has been interrupted, or is too weak to send signals to and from the printer. 	Press OK to turn off the error message on the LCD screen and then turn the Wi-Fi radio off. Run the Wi-Fi Setup Wizard to find and connect to an available wireless network within range. ^a
On	The Wi-Fi radio is turned on and there is a working connection between the printer and a wireless network.	None.

^aIf you acknowledge the error message by pressing **OK**, the light will go off. However, if the Wi-Fi radio is not turned off and the printer cannot establish a connection to an existing Wi-Fi network, the light will resume blinking, and the error message will display again.

Home Center Software

Home Center Software is installed on your computer during the setup process. The software functionality for Windows or Macintosh users is described below.

Home Center for Windows

Once installed, Home Center Software allows you to print, copy, scan, and configure your printer from your Windows XP or Vista computer.

To open the Home Center Software window on your computer, use the Home Center icon on the Desktop or in the Start Menu.



From the Home Center main menu, selecting one of the six menu items enables you to:

- Scan pictures and documents
- Enhance and copy pictures
- Enhance and print images
- Configure settings for printing, copying, and scanning from the control panel
- Access the Kodak Tips and Projects Center Web site
- Order supplies from the Kodak Web site

The functions of the three small icons located in the upper-right corner of the Home Center window are shown below:



Returns you to the main Home Center window



Displays the Status Monitor



Displays a Help panel for the Home Center Software

Home Center for Macintosh

After installing the software on your Macintosh OS X computer, you can select the Home Center from the System Preference's **Print & Fax** pane by selecting your printer in the Printer List, clicking the **Print Queue** button, and clicking the **Utility** icon. Or, you can use the Home Center icon displayed in your Dock.



The Home Center window displays three tabs: Select, Setup, and Maintenance.

From the **Select** tab, you can select your printer from a list of connected printers.

From the **Setup** tab, you can configure stand-alone printing, copying, and scanning settings:

- **AiO Printer:** This option lets you:
 - Synchronize your printer's date and time to the computer
 - Select what quality you prefer for printing on plain (not photo-quality) paper
 - Specify whether a date will be printed on the front of a photo printed from the printer
 - Specify whether the printer automatically applies "scene balance" to digital pictures it prints
 - Change the name of the printer
- **Scan:** This option lets you configure settings for scanning, saving, and specifying the application(s) used for opening and editing scanned pictures and documents.

From the **Maintenance** tab, you can:

- Print a test page
- Align the printhead
- Run a printhead nozzle correction
- Clean the printhead
- Click **About this Printer** to view the printer model number, its Kodak Service Number, and the version of printer firmware used to operate the printer

From both the **Setup** and **Maintenance** tabs you can:

- **Order Supplies:** This option allows you to order supplies online from the Kodak web site.
- **View/Hide Status:** This option opens a drawer displaying the configuration status of your printer.

Use this chapter to set up and start using your all-in-one printer.

Selecting a printer location

Place your printer on a clean, flat surface in a dry, well-ventilated location, away from direct sunlight. Avoid areas with high levels of dust and debris. Do not expose the printer and paper to ventilation ducts, open doors, or high traffic, as airborne particles can affect picture quality.

Allow enough space on all sides of the printer to comfortably connect and disconnect cables, change ink cartridges, and remove or load paper.

To ensure getting good signals from your networked computer(s), minimize obstacles between the network router and the printer (and other wireless devices, such as Bluetooth-enabled camera phones, etc). The printer will function best with as clear a “line of sight” as possible between it and the router.

In addition, keep the printer away from microwaves, and away from 2.4 GHz wireless telephone handsets.

Configuring printer settings

Printer settings can be adjusted in two ways: via the control panel or the Home Center Software that comes with your printer (see Home Center Help for more details).

Configuring basic settings

1. From the control panel, press **Menu**.
2. Press ▼ until **Printer Settings** is selected, and then press **OK**.
3. Press ▼ until the parameter you want to configure is selected, and then press **OK**. To review the available options and settings, see [Printer Settings options, page 20](#).
4. Press ▼ or ▲ to configure the **Date and Time, Tagged Image Printing, Control Panel Settings, Language, or Reset All Settings**.
5. Press ◀ or ▶ as needed to change the default value. The default value is displayed at the right margin of the setting. When the setting is highlighted, the current value is bracketed between the ◀ and ▶ symbols.
6. Press **OK** to save the setting(s).

Printer Settings options

Menu Options	Options	Settings
Date and Time ^a	Year	2007 - 2099
	Month	January - December
	Day	1 - 31
	Hour	0 - 12 or 0 - 23
	Minute	00 - 59
Tagged Image Printing	On	
	Off	
Control Panel Settings	Button Sounds	On
		Off
	Time to Low Power	1-4 hours, in .5 hour increments
Language	English (U.S.)	
	English (International)	
	Deutsch	
	Français	
	Français (Canada)	
	Italiano	
	Español	
	Castellano	
	Português	
	Nederlands	
NOTE: Restoring the factory defaults from the Reset All Settings option will not change the settings for any of the following: Language, Date and Time .		

^aSetting the date and time via the control panel is a separate task from stamping the date and time on photo prints. You can also synchronize the printer's date and time using the Home Center Software.

Setting your printer as the default

For Windows XP

1. Click **Start**, point to **Settings**, and then double-click **Printers and Faxes**.
2. Right-click the icon for the KODAK ESP 7 All-in-One Printer, and then select **Set as the Default Printer** on the shortcut menu.

For Windows Vista

1. Click **Start**, and then click **Control Panel**.
2. Click **Hardware and Sound**, and then click **Printers**.
3. Right-click the icon for the KODAK ESP 7 All-in-One Printer, and then select **Set as the Default Printer** on the shortcut menu.

For Macintosh

Whenever a new printer is installed on the Macintosh operating system, it becomes the default printer. If you have more than one printer connected to your computer, use the following steps to change your default printer.

1. Click **System Preferences**.
2. In the **Hardware** section, click **Print & Fax**.
3. Select the KODAK ESP 7 All-in-One Printer from the list of available printers as the default.

Configuring network settings

You can connect your printer to a wired (Ethernet) network or to a wireless (Wi-Fi) network. You may refer to the “Start Here” booklet that came with your printer, or review the following sections as needed.

Networking resources

This section only covers how to set up your printer with your existing network. It presumes you have a working understanding on how your network is configured. Additional resources for related topics, information, and network troubleshooting are available at www.kodak.com/go/inkjetnetworking.

If you are unsure of how your network is configured, please contact your network administrator or your internet service provider for assistance.

Configuring an Ethernet network connection

You will need the following items to connect the printer to a wired (Ethernet) network:

- A functional Ethernet network that includes a router, switch, or hub with an Ethernet port
- A CAT-5 (or higher) Ethernet cable

Ethernet setup

1. Plug one end of the Ethernet cable into the Ethernet port located on the back of the printer and the other end into an available port on your Ethernet router or hub.

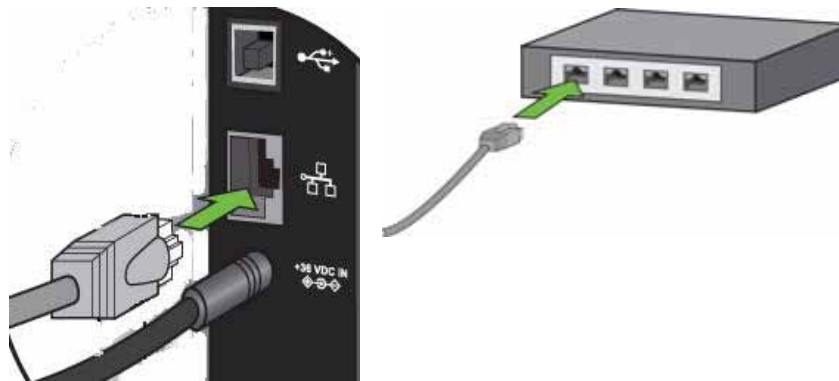

2. Turn on the printer, if necessary.
3. From the control panel, press **Menu**.
4. Press ▼ until **Network Settings** is selected.
5. Press **OK**.
6. Verify the connection.

Configuring a wireless network connection

You can connect your printer to a 802.11 wireless (Wi-Fi) network from the printer control panel.

The wireless (Wi-Fi) network status light on your printer has the following conditions:

LED Status	Description
Fully lit	When lit, signals that a wireless (Wi-Fi) network connection has authenticated to the router, but your connection may not be active. You can verify the connection through the Network Settings menu.
Blinking	Blinks when <ul style="list-style-type: none"> ▪ searching for an available Wi-Fi network within range ▪ existing signal is too weak to transmit The LED has a repetitive cycle of blinking, then resting for 15 seconds, followed by blinking again. The Wi-Fi radio will continue to attempt connection to the network until a connection is established.

What you need to know before you connect

To connect your printer to a wireless network, you will need the following:

- A laptop or desktop computer equipped with a network interface card or wireless networking support, and the Kodak software installed
- A working 802.11 wireless network. Kodak recommends that you use a wireless access point/router that uses Dynamic Host Configuration Protocol (DHCP)
- Internet access (preferably Broadband access such as cable or DSL)
- Your network name (SSID). You can obtain your SSID from the wireless router or the access point using the router's embedded web server. See the manufacturer's documentation provided with your wireless system for more information.
- Your WEP key or WPA passphrase. You can obtain your WEP Key or WPA passphrase from the wireless router or the access point using the router's embedded web server
- Your network security string, if applicable
- Disable your firewall or accept the firewall prompts to allow installation

If you are unsure about any of the items listed above, please contact your network administrator or your internet provider for assistance.

Configuring basic wireless (Wi-Fi) settings

NOTE: You will need to know the network name (SSID) of the Wi-Fi network, and its security string to connect your printer to the network successfully. Contact your Internet provider or the person who helped you configure your network to assist you.



CAUTION:

If there is an Ethernet cable plugged in to the Ethernet port on the back of the printer, unplug it before starting this task.

1. From the control panel, press **Menu**.
2. Press **▼** until **Network Settings** is selected, and then press **OK**.
3. If the message states **Turn Wi-Fi Radio On**, press **OK**. If the message states **Turn Wi-Fi Radio Off**, move to the next step.
4. As needed, press **▲**, **▼**, **◀** or **▶** to view or configure an item, and then press **OK**.

Network Settings options

If the printer has not been configured to connect to the Wi-Fi network or the printer Wi-Fi radio is turned off, the LCD screen displays the options below:

Menu Options	Settings / Action
Wi-Fi Setup Wizard	Press OK to start the Wizard.
Turn Wi-Fi Radio On / Off	Press OK to toggle between the Wi-Fi radio on or off states.
View Network Configuration	Press OK to view the configuration on the LCD screen.
Print Network Configuration	Press OK to print the network configuration.
Manual IP Address	Press OK to display the Manual IP Address menu.

Wi-Fi setup wizard

Review the procedures below and use the one that suits your network setup.

Connecting to a listed network

1. Complete Steps 1 and 2 of [Configuring basic wireless \(Wi-Fi\) settings, page 23](#).
2. **Wi-Fi Setup Wizard** is the first option; press **OK** to select it.

NOTE: The Wi-Fi radio is turned on automatically when **Wi-Fi Setup Wizard** is selected.

3. The printer searches for available Wi-Fi networks detected, then displays the list in alphabetical order on the LCD screen. The illustration below shows an example list. The row containing each <Network name> listed also shows the strength of the signal (shown below as xx%) as a percentage between 0 and 100, where 100 is the highest possible strength.
 - For best performance the signal strength should be at least 50%.
 - If more Wi-Fi networks are within range than can be shown on the LCD screen, the display includes the ▼ (page down) symbol and/or the ▲ (page up) symbol on the LCD screen. As appropriate, press ▼ or ▲ on the control panel until you locate the network you want to use.

As appropriate, press ▼ or ▲ on the control panel until you locate the network you want to use.

The last two options displayed are **Unlisted network** and **Rescan for wireless networks**.

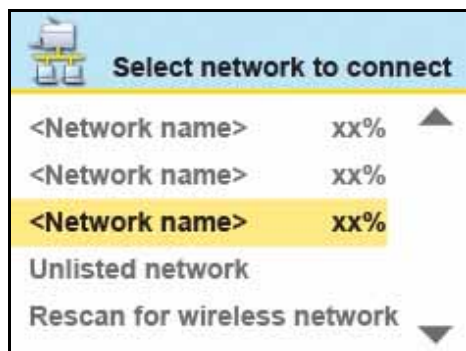

NOTE: In your setup, instead of **<Network name>** as shown in the illustration above, the LCD will show the actual network name (SSID), without the brackets, and the signal strength, displayed as a percentage, of each available Wi-Fi network within range.

4. With the desired network selected, press **OK**. You may need network identification information, such as a security string, in order to authenticate your connection.

NOTE: You will need to know the network name (SSID) of the Wi-Fi network and its security string to connect your printer to the network successfully. Contact your Internet provider or the person who helped you configure your network to assist you.

5. If you are looking for a Wi-Fi network that does not broadcast its SSID, see [Connecting to an unlisted network, page 26](#).

NOTE: If your printer was last connected to an available network on the list, the network settings are saved and the printer will automatically attempt to reconnect you to that network.

6. If the network requires the entry of a security string, the keyboard will be shown on the LCD. Press **▲**, **▼**, **◀** or **▶** to select a key. Press **OK**.
7. Enter the security string. The correct upper and lower case characters and numbers are required.

NOTE: To erase any letters or numbers entered in error, select **<BKSP >** (backspace) and press **OK**.

Key/Passphrase/ Security String	Description
WEP key	5 or 13 ASCII characters; case-insensitive or 10 or 26 Hexidecimal digits; case-insensitive
WPA/WPA2 phrase	8-63 printable ASCII characters; case-sensitive

8. After completing your entry, select the **DONE** key, and then press **OK**.

LED Status	Description
Fully lit	When lit, signals that a wireless (Wi-Fi) network connection has authenticated to the router, but your connection may not be active. You can verify the connection through the Network Settings menu.
Blinking	Blinks when <ul style="list-style-type: none"> ▪ searching for an available Wi-Fi network within range ▪ existing signal is too weak to transmit The LED has a repetitive cycle of blinking, then resting for 15 seconds, followed by blinking again. The Wi-Fi radio will continue to attempt connection to the network until a connection is established.

The LED will be continuously lit when you are connected to a wireless network. This does not guarantee you are connected. You must verify that you are connected. See [Verifying network configuration, page 27](#).

Connecting to an unlisted network

1. **Wi-Fi Setup Wizard** is the first option; press **OK** to select it.
2. If your network does not appear in the list and is configured to not broadcast its SSID, select **Unlisted Network** and press **OK**.
3. Follow the prompts to enter the network name using the keyboard visible on the LCD screen. Press **▲**, **▼**, **◀** or **▶** to select a key. Enter the alphanumeric string accurately, using the same upper and lower case letters as your SSID. After completing your entry, select the **DONE** key, and then press **OK**.
4. Select **WEP** or **WPA/WPA2** as required for your network's security setup, and then press **OK**.
5. Enter the security information required using the LCD screen keyboard.
 - Press **▲**, **▼**, **◀** or **▶** to select a key. Select **<BKSP>** to erase any incorrect characters. Then select **DONE** and press **OK**.
6. After the confirmation message appears on the LCD screen, press **OK** to display the Network Settings menu.

Scanning for wireless networks

If you don't see your network in a list or want to change your network:

1. Select **Rescan for wireless networks**.
2. Press **OK**.

Setting up an IP address

If you have discovered that you are connected to the access point but you are not connected to the network, you may need to set up your IP address on the printer.

1. From the Network Settings menu, select **Manual IP Address** and press **OK**.
2. Select one of the options displayed:
 - **Dynamic (DHCP)**
 - **Automatic (Private)**
 - **Manual (Static)**
3. Then press **OK** to continue.
4. Depending on the IP address type specified, you may be prompted to enter an IP address, a Subnet Mask, a Gateway Address; and a DNS Server address. Press **OK** after making each entry. See your network provider for more information.

All address entries are made in the following format: 000.000.000.000. Any address or subnet mask that has only 2 characters between stops shall have a leading zero entered in front of that number. For example:

Address or Subnet Mask Format	Printer Entry Format
149.89.138.149	149. 089 .138.149
149.2.40.149	149. 002.040 .149

To obtain the IP Address on a Windows operating system:

You must use a computer on your network.

- a. Select **Start > Run**.
- b. Type **cmd**.
- c. Type **ipconfig** and then press **Enter**. If configured, IP Address, Subnet Mask and Gateway Address (Default Gateway) are shown.

Tip: Your Gateway Address is usually the router address.

To obtain the IP Address on a Macintosh operating system:

You must use a computer on your network.

- a. Open **System Preferences**.
- b. Under **Internet and Network**, click **Network**. Select the **Wireless Network**. Your IP address will be shown.

Verifying network configuration

You can verify that you are connected to a network from your printer menu.

1. Press ▼ until **Network Settings** is selected, and then press **OK**.
2. Press ▼ until **View Network Configuration** is selected, and then press **OK**. When you select this menu item, the printer displays the configuration settings for both Ethernet and Wi-Fi networks on the LCD screen.

3. Press ▼ until the second page appears.
4. Look for the text **Connected Network SSID**. Your network name should be listed.

Printing network configuration

When you select this option, a print of your current network configuration settings is generated. Settings with no values will be displayed as zeros.

1. Press ▼ until **Network Settings** is selected, and then press **OK**.
2. Press ▼ until **Print Network Configuration** is selected, and then press **OK**.

Installing your printer on additional computers on the same network

For Windows

To install the printer on another computer in your network, use the following steps.

1. Install the software that came with your printer on the target computer.
2. Run the KODAK Printer Network Setup Utility. This is located at **Start > All Programs > Kodak > Kodak Printer Network Setup Utility**.
3. Select **Connect via Network - Wireless / Wi-Fi** then click **Next** to proceed. The printer should be detected and driver installations begin. If you have more than one printer connected to your network, select the printer, then click **Next**.
4. After the driver installation completes, click **Next** to proceed.

The printer will be named KODAK ESP 7-XXXX, where XXXX is a number unique to your printer.

For Macintosh

To install the printer on another computer in your network, use the following steps:

1. Install the software that came with your printer on the target computer.
2. Click **System Preferences**.
3. Click **Print & Fax**.
4. Click the + sign to add the printer.
5. Select the KODAK ESP 7 All-in-One Printer from the list of available printer(s).

The printer will be named KODAK ESP 7-XXXX, where XXXX is a number unique to your printer.

Changing the printer connection type

You can change the way you connect to your printer at any time.

For Windows

USB to Wi-Fi

To convert the USB connection from a PC to a wireless network connection:

1. Disconnect the printer from the computer.
2. Use the Windows Control Panel to delete the printer from you computer.
3. Configure the wireless network from the printer front panel. See [Configuring a wireless network connection, page 22](#).
4. Press **Menu**.
5. Press **▼** until **Network Settings** is selected, and then press **OK**.
6. Select **View Network Configuration** and confirm you have an IP address.
7. Run the KODAK Printer Network Setup Utility. This is located at **Start > All Programs > Kodak >Kodak Printer Network Setup Utility**.
8. Select **Connect via Network - Wireless / Wi-Fi**, then click **Next** to proceed. The printer should be detected and driver installations begin. If you have more than one printer connected to your network, select the printer and then click **Next**.
9. After the driver installation completes, click **Done** to proceed.
10. The printer will be named KODAK ESP 7-XXXX, where XXXX is a number unique to your printer.

USB to Ethernet

To convert the USB connection from a PC to an Ethernet connection:

1. Disconnect the printer from the computer.
2. Use the Windows Control Panel to delete the printer from you computer.
3. Connect the printer to the network (LAN port on Router) with an Ethernet cable
4. Run the KODAK Printer Network Setup Utility. This is located at **Start > All Programs > Kodak >Kodak Printer Network Setup Utility**.
5. Select **Connect via Network - Ethernet cable** then click **Next** to proceed. The printer should be detected and driver installations begin. If you have more than one printer connected to your network, select the printer and then click **Next**.
6. After the driver installation completes, click **Done** to proceed.
7. The printer will be named KODAK ESP 7-XXXX, where XXXX is a number unique to your printer.

Wi-Fi to Ethernet

To convert the Wi-Fi connection from a PC to an Ethernet connection:

1. Connect the printer to the network (LAN port on the Router) with an Ethernet cable.

Ethernet to Wi-Fi

To convert the Ethernet connection from a PC to a Wi-Fi connection:

1. Disconnect the Ethernet cable from the printer.
2. Configure the wireless network from the printer front panel. See [Configuring a wireless network connection, page 22](#).
3. Press **Menu**.
4. Press ▼ until **Network Settings** is selected, and then press **OK**.
5. Select **View Network Configuration** and confirm you have an IP address.

For Macintosh

USB to Wi-Fi

To convert the USB connection from a Macintosh to a wireless network connection:

1. Disconnect the printer from the computer.
2. Configure the wireless network from the printer front panel. See [Configuring a wireless network connection, page 22](#).
3. Press **Menu**.
4. Press ▼ until **Network Settings** is selected, and then press **OK**.
5. Select **View Network Configuration** and confirm you have an IP address.
6. Open **System Preferences** and then click **Print & Fax**. Click + button to view a list of available printers that can be added. Network printers are labeled "Bonjour" under "Kind".
7. The printer will be named KODAK ESP 7-XXXX, where XXXX is a number unique to your printer.
8. Select your printer and click **Add**.

USB to Ethernet

To convert the USB connection from a Macintosh to an Ethernet connection:

1. Disconnect the printer from the computer.
2. Connect the printer to the network (LAN port on Router) with an Ethernet cable
3. Open **System Preferences** and then click **Print & Fax**. Click + button to view a list of available printers that can be added. Network printers are labeled "Bonjour" under "Kind".
4. The printer will be named KODAK ESP 7-XXXX, where XXXX is a number unique to your printer.

5. Select your printer and click **Add**.

Wi-Fi to Ethernet

To convert the Wi-Fi connection from a Macintosh to an Ethernet connection, connect the printer to the network (LAN port on the Router) with an Ethernet cable.

Ethernet to Wi-Fi

To convert the Ethernet connection from a Macintosh to a Wi-Fi connection:

1. Disconnect the Ethernet cable from the printer.
2. Configure the wireless network from the printer front panel. See [Configuring a wireless network connection, page 22](#).
3. Press **Menu**.
4. Press **▼** until **Network Settings** is selected, and then press **OK**.
5. Select **View Network Configuration** and confirm you have an IP address.

Your printer accepts print stock of various types and sizes, including letter-and legal-size plain paper, photo paper, transparencies, T-shirt transfers, envelopes, cards, and labels. It automatically detects the size and whether or not photo paper is loaded into the paper tray. Kodak photo paper contains bar codes that allow your printer to detect the paper type that optimizes your photo prints.

The bottom paper tray accepts media from 6 to 9 inches wide, and from 7 to 14 inches long (see the Note in [Loading plain paper, page 33](#)); its capacity is 100 sheets of 20 lb. plain paper. The top tray capacity is 40 sheets of 4X6, 4X7, or 5X7 inch paper.

Handling paper

Follow the precautions below when handling paper:

- Hold the paper by the edges; avoid placing your fingerprints on it.
- Do not touch the glossy side of photo paper.
- Store paper flat, away from direct sunlight and heat (such as in a car parked in the sun).

Loading the paper trays

Things to keep in mind

- Before you start loading any type of media into the printer, lift the paper output tray.



- Pull the paper stop (at the edge of paper output tray) until it is fully extended.
- If the paper you are going to use is less than A4 size, lift the hinged end of the paper stop toward you until it perpendicular to the paper stop. This prevents the printed paper from sliding off of the paper output tray as it exits the printer.

- If the paper you use is longer than A4 size, including Legal and panoramic photo paper, make sure that the hinged end of the paper stop lays flat and is NOT pulled up. The longer paper should balance on the paper output tray without sliding off.

 CAUTION:

This is crucially important when you are printing two or more sheets of long paper. Long paper that cannot extend straight to its full length when output from the printer can fold behind the object ahead of it. The curl can result in a job that dissatisfies you, and it can also causes a blockade preventing paper still being printed from exiting the printer properly.

Although a paper curl should not interrupt a job involving just one sheet of long paper, when a sheet's clean exit from the printer is impeded because the sheet before it is curled by the paper stop, the current sheet also curls upon itself, generally behind rather than atop the sheet that came before. This process repeats until the trapped sheets jam the paper inside the printer.

Loading plain paper

NOTE: Review [Things to keep in mind](#) above.

1. Pull the bottom paper tray toward you.

NOTE: To load media that is more than A4 size, such as 4X12 inch panoramic photo paper or Legal plain paper, you must first extend the lower paper tray to its full length. To do so:

- a. Remove all paper from the tray, as needed.
- b. Press and hold the paper tray extension-release, located on the inside of the front of the lower paper tray.



- c. Pull the tray extension toward you gently until it stops moving easily. DO NOT pull the extension far enough to disengage from the paper tray.
- d. Let go of the tray release, and then load the paper in the tray.

 **Tip:** To return the lower paper tray to its default size, press and hold the extension-release and push the tray until the extension stops moving, and then let go.

2. As needed, squeeze and slide the paper edge guide on the tray to the left so that it does not block the paper from laying flat.

3. Insert the media into the paper tray, print side down with its near edge against the paper stop.
4. As needed, squeeze and slide the paper edge guide to align it to the left edge of the media.
5. Lower the paper output tray.
6. Gently push the tray forward until it is aligned with the edge of the paper output tray.



Loading photo paper

NOTE: Review [Things to keep in mind, page 32](#).

1. Remove all other paper from the paper tray you plan to use.
2. Insert photo paper into the paper tray print-side down, with the short edge forward. Do not overload the tray.
3. Slide the paper forward until it stops.
4. Squeeze the paper edge guide and slide it to the right until it just touches the loaded paper.
5. Lower the paper output tray.
6. Gently push the tray forward until it is aligned with the edge of the paper output tray.



Loading envelopes



CAUTION:

Do not load envelopes with cutouts or cellophane windows in this printer.

NOTE: Review [Things to keep in mind](#), page 32.

1. Remove all other paper from the paper tray you plan to use.
2. Place one or more envelopes along the right edge of the paper tray, with the front side down and the envelope flaps pointing toward the left side of the tray.
3. Squeeze the paper edge guide and move it to the right until it just touches the loaded envelope(s).
4. Close the paper tray and lower the paper output tray.



Loading legal size paper

1. Remove all other paper from the bottom tray.
2. Press and hold the paper tray extension-release, located on the inside of the front of the bottom paper tray.



3. Pull the tray extension toward you gently until it stops moving easily. **DO NOT** pull the extension far enough to disengage from the paper tray.
4. Let go of the tray release and then load the paper in the tray.
5. Squeeze the paper edge guide and move it to the right until it just touches the loaded paper.
6. Squeeze the paper edge guide and move it towards the printer until it just touches the loaded paper.
7. Push the paper tray in towards the printer.

8. Press the bottom paper extender tab on the front left edge of the tray while pushing the paper tray in towards the printer.



Loading originals

Loading an original for copying or scanning

To copy or scan a document or photo, place your original directly on the scanner glass, print side-down, against the silver arrow on the right-front corner.



5

Viewing and Printing Photos

You can print JPEG (.jpg) photo images directly from PictBridge cameras connected to the front panel of your printer. You can print virtually any file type from digital cameras, USB flash (“thumb”) drives, and memory cards connected to the front panel on your printer. You can also print files from a PC or MACINTOSH computer connected to your printer.

NOTE: For assistance on printing from a connected computer to your printer, refer to the instructions from the software application (such as a word-processing or image-editing program) used to send the file to the printer or review your computer’s operating system instructions.

Although your printer is compatible with the Kodak 8-in-1 USB card reader (sold separately) as well as other Kodak USB card readers, it may not be compatible with other manufacturers’ card readers.



WARNING: Do not remove a storage device (memory card, USB drive, or digital camera) from the printer while it is being accessed, or you may damage the files on it. Safely remove or disconnect the device.

You can safely remove the storage device when the blue status light located above the memory card slots stops blinking.

Viewing photos

Insert one of the following devices into the appropriate opening:

NOTE: Always use the USB host port on the front of the printer. To avoid an error, use only one slot or port at a time.

Device Type	Printer Slot
Memory Card	Memory Card Reader
Portable Storage Drive	USB port
Digital Camera	USB port
Kodak Bluetooth dongle	USB port

NOTE: If Tagged Image Printing is enabled on this printer (see [Configuring printer settings, page 19](#)), it detects a Digital Print Order Format (DPOF) file when you insert a memory card. The printer LCD screen prompts you to verify that you want to print tagged images. See [Printing tagged images, page 42](#).

Most memory cards will work with this printer. When you insert a memory card, or connect a camera or portable flash drive to the printer, the last photo taken is displayed first.



CAUTION:

Do not insert more than one device, such as a USB thumb drive or memory card, into the printer at a time, or you will get an error message. Also, never remove or disconnect a memory card from its slot unless the blue light near the slot is not blinking.

NOTE: Photos stored on a PictBridge camera are displayed on the camera's LCD screen only. See [Printing photos from a PictBridge camera, page 40](#), as needed.

Configuring photo print settings

You can change the factory default print settings for your printer using the control panel. Windows users may adjust some settings using Home Center software (see Home Center Help, discussed in [Home Center Software, page 17](#), for information on using Home Center).

1. Insert a memory card into the appropriate slot, or plug a USB flash drive or (PTP) digital camera to the front panel USB port. The last photo is displayed first.
2. From the control panel, press **Menu**.
3. Press **▼** until the option you want to configure is selected, and then press **OK**.
4. As needed, press **◀** or **▶** to change the setting.
5. Press **OK** to save the setting for the current print job.
6. To save the setting as the default value, select **Save as Default** and press **OK**.
7. As needed, press **▲** or **▼** until **View Photos** is selected in the Print Photos menu, and then press **OK** to return to viewing and selecting photos for printing. Or, press **Start** to print the selected photo(s) with the selected settings.

Print Photos options

Menu Options	View Settings / Select	Settings
View Photos	OK	
Transfer All to PC	OK	
Rotate This Photo	OK	
Quantity	◀ or ▶	1- 99
Tray Selection	◀ or ▶	Top Tray
		Bottom Tray
Print Size	◀ or ▶	3.5x5
		4x6
		4x7 (High Def)
		4x12 (Panoramic)
		5x7
		8x10
		8.5x11
		(2x3) Wallet
Quality^a	◀ or ▶	Normal
		Best
		Draft
Color	◀ or ▶	Color
		Black & White
Scene Balance^b	◀ or ▶	On
		Off
Add Date to Prints^c	◀ or ▶	No
		Yes
Save as Defaults	OK	

^aYour printer automatically adjusts the print output to the best available quality for images printed on photo paper. You need to set **Plain Paper Quality** to Draft, Normal or Best only when printing images or documents on plain printer paper.

^bThis printer is capable of automatically adjusting scene balance improvements (or the brightness) of photos printed from camera cards and USB connected devices. The default is **On**.

^cThe default setting does not print the date on the photo print.

Printing photos

Printing photos from a PictBridge camera

You can print photos directly from a PictBridge camera, which controls photo selection and printing.

1. Load the desired paper tray with photo paper, print side down.
2. Connect a PictBridge camera to the USB port located on the front panel of your printer.
3. Use your PictBridge camera to select and print the photos.

Printing photos from non-PictBridge digital cameras, memory cards, and USB flash drives



CAUTION:

This printer does not support portable USB “flash” drives that:

- Require third party access software
- Are encrypted
- Contain multiple partitions
- Were formatted using any of the following file storage systems:
 - New Technology File System (NTFS)
 - Mac OS Standard (HFS) or Mac OS Extended (HFS Plus)

The printer can read data stored on USB flash drives formatted using only the File Allocation Table (FAT) system.

If a flash drive is plugged into the USB port on the front panel that the printer cannot read, the printer does not display photos, makes an audible sound (“beep”), and displays an error message on the LCD screen.

See the first Tip below for a work-around if your flash drive cannot be read by your printer.



Tip: If you would like your printer to print photos stored on a non-FAT formatted device, or stored as non-.jpeg files, you must first send the files to your computer to be read.

- Windows computers can read NTFS-formatted drives
- Macintosh computers can read HFS- and HFS Plus-formatted drives
- Third-party applications which run on either Windows or Macintosh computers can read many different image file types

Use your computer to explore the files stored on the flash drive while it is still plugged in. Navigate to and open the file in the computer, or transfer the file(s) to the computer hard drive. Then, print the file from your computer.

1. Connect a digital camera or portable USB drive to the front panel USB port, or insert a memory card to the appropriate card reader on the front panel.
The printer displays the photos on the LCD screen, last photo first.
2. Load the paper tray with photo paper, print side down.
3. On the control panel, press ◀ or ▶ until a photo you want to print is displayed on the LCD screen.
4. Press **OK** to select the photo. A check mark displays on the LCD screen to indicate your action. If you change your mind and want to de-select the photo from printing, press **OK** again; the check mark is removed.



Tip: To select and print all the photos on a memory card or portable USB device which have not yet been selected, hold down the **OK** button for 2 seconds. Holding down the **OK** button again for 2 seconds de-selects all the photos.

5. If you are satisfied with the image shown, you can modify the quantity of copies to be printed by pressing ▲ until the number you want is shown on the LCD. To decrease any quantity greater than 1 shown, press ▼ until the number you want displays.
6. If you want to specify different print parameters for the photo, press **Menu** to display the **Print Photos Options** menu. A sample of the menu is shown in the illustration below.

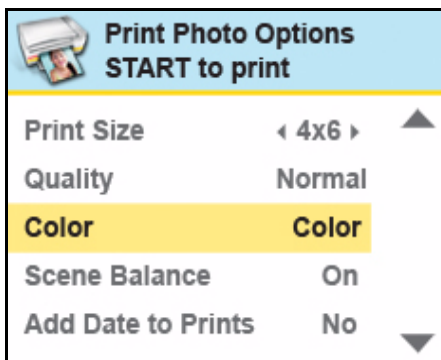

7. Here you can press ▼ until the parameter you want to adjust is selected. If a value is displayed between the ◀ and ▶ symbols in the row, press ◀ or ▶ to select the value you want.
8. Press **Start** to print the selected photo, or press ▲ until **View Photos** is selected.
9. Press ◀ or ▶ until you view another photo you want to print.
10. Repeat this process as needed.

NOTE: Each photo is automatically deselected after it has been printed.

Printing tagged images

The Digital Print Order Format (DPOF) is an industry-standard file that can be created by some digital cameras. Camera selected photos are photos you tag for printing with your digital camera. When you select photos with your camera, the camera creates a DPOF file that identifies which photos have been tagged for printing. Your printer can read the DPOF file from the memory card so you do not have to re-select the photos to print.

NOTE: Not all digital cameras support tagging or the creation of tagged image (DPOF) files. Refer to your camera's user guide to ensure it supports this function.

When you print tagged photos, the selected layout is applied unless your camera allows selection of sizes. If not specified by the DPOF information, the current default print photo size and other settings will be used.

Printing from a Bluetooth-enabled device

Bluetooth wireless technology allows wireless connectivity between compatible electronic devices. Your printer allows you to print .jpg images from a Bluetooth-enabled device, using an optional Kodak USB Bluetooth 2.0 USB adapter. You can purchase the Kodak Bluetooth adapter from Kodak at www.kodak.com/go/accessories.

The Kodak Bluetooth adapter (shown below) supports connectivity between your printer and the following Bluetooth-enabled devices:



- Mobile camera phones
- Personal Digital Assistants (PDAs)
- Digital still cameras
- Computers

The Bluetooth adapter will not work when plugged directly into computers, Kodak printer-docks, other types of Kodak printers or devices made by other manufacturers. This adapter works exclusively with KODAK All-in-One Printers.

To enable Bluetooth wireless connectivity, plug the Kodak Bluetooth adapter into the USB port located on the front panel of your printer.

NOTE: Before you can transmit photos to your printer from a Bluetooth-enabled device, you must first “pair” the printer and the device so that they can communicate. This “pairing” is performed from your device’s interface. Review the instructions for pairing that came with your Bluetooth-enabled device, as needed.

When the device is searching for other Bluetooth-enabled devices to pair with, if your printer is within range of the device (see [Range](#) below), your printer will appear in the list, with a name starting with **ESP**. (Your device may allow you to rename it, as appropriate.)

If your device prompts you for the printer’s personal identification number (PIN) to authenticate and initiate the connection, enter **1111**.

Bluetooth devices do not use a Print command. You must use the device’s Send function to transmit an image stored on it to the printer. Only one file can be sent from the device at a time. Once received, your printer will print the image automatically using the default settings.

Range

When the device and the printer are connected, you can send photos from your Bluetooth device to the printer. Your printer supports connectivity to one Bluetooth device at a time.

For the highest transfer speed, Kodak recommends keeping a maximum distance of 10 meters (32.8 feet) between Bluetooth devices, as they may not work reliably beyond this range.

Printing multiple photos

When you select a print size that is smaller than the paper size, this printer automatically lays out multiple photos using the least amount of space, minimizing paper waste when separating the photos.

Printing panoramic photos

You can print a panoramic photo on 4 x 12 paper, or two panoramic photos on U.S. letter or A4 paper; some cropping will occur.

Zooming and cropping photos

Your printer enables you to zoom in or out on a specific area of a photo. When you print the photo, the photo is cropped so only the area bounded by the crop boundaries is printed.



CAUTION:

You cannot use the zoom or crop functions of this printer on photos located on a PictBridge camera connected to the printer. All changes made to photos stored on a PictBridge camera are conducted on the camera.

NOTE: The changes you make to the photo apply only to viewing and printing the photo, and will not be saved on the memory card or storage device.

1. Select an image from the display. As needed, see [Printing photos from non-PictBridge digital cameras, memory cards, and USB flash drives, page 40](#).
2. As desired, press **Menu** to display the **Print Photos Options** menu. The first option is Print Size. Press the ◀ and ▶ navigation buttons on the control panel to change the size of the output that you want for the image, which will affect the zoom and crop displays. Press **OK** when you are satisfied.
3. Press **Zoom +** to enable the zoom and crop function. You can enlarge the photo in .25X increments, up to a 5X magnification. Press **Zoom -** to decrease the magnification in .25X increments, to 1X.



NOTE: The changes you make to the photo apply only to viewing and printing the photo; they are not saved on the memory card or storage device.

4. Use the ◀, ▲, ▼, and ▶ navigation buttons on the control panel to display the part of the picture you want to print.
5. Press **OK** when finished. The photo is displayed with the original view, and a border ("crop box") is displayed around the area you want to use.



Tip: You can make more precise zoom and crop adjustments to your photos on your computer using photo editing software. To send a photo from the printer to your computer, see [Transferring images to a computer](#) below.

6. If you are satisfied with the image shown, press **Start** to print the area displayed in the crop box. If you want to specify additional print parameters for the photo, press **Menu** to display the **Print Photos Options** menu. A sample of the menu is shown in the illustration below.

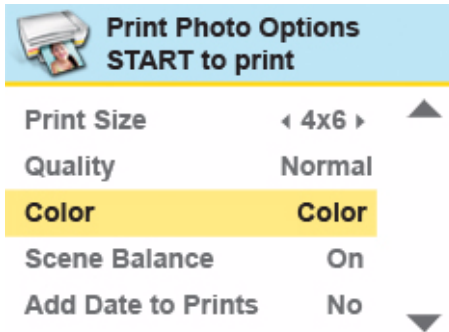

7. Here you can press ▼ until the parameter you want to adjust is selected. If a value is displayed between the ◀ and ▶ symbols in the row, press ◀ or ▶ to select the value you want.
8. Press **Start** to print the selected photo, or press ▲ until **View Photos** is selected. Press **OK**.
9. Press ◀ or ▶ until you view another photo you want to print.
10. Repeat this process as needed.

NOTE: If you want to print multiple copies of a photo displayed on the LCD screen, you can press ▲ until the number you want is shown. To decrease any quantity greater than 1 shown, press ▼ until the number you want displays.

Transferring images to a computer

You can transfer .jpg, .mov, or .wav files to your Windows or Macintosh computer from a digital camera, memory card, device connected to your printer via a Kodak Bluetooth dongle, and portable (USB) thumb drive connected to the printer.

NOTE: To transfer large files, such as video files, from a memory card to a computer, Kodak recommends using a card reader attached directly to the computer instead of transferring the file(s) via the printer.

Likewise, Kodak recommends transferring large groups of image files (400 or more) stored on a memory card to a computer via a card reader connected to the computer.

Transferring images to a Windows computer

1. Connect the device to the appropriate slot on the front panel of your printer.
2. From the control panel press **Menu** to display the **Print Photos** menu on the LCD screen.
3. Press ▼ until **Transfer All to PC** is highlighted, and click **OK**.

4. Press **Start**.
5. Follow the prompt on the computer.

Transferring images to a Macintosh computer

1. Connect the device to the appropriate slot on the front panel of your printer.
2. From the control panel, press **Menu** to display the options on the computer monitor (for a PictBridge camera) or the printer LCD screen (all other devices).
3. Press ▼ until **Transfer All to PC** is highlighted.
4. Press **OK**.
5. Press **Start**.
6. Use iPhoto or Image Capture to complete the transfer.

You can copy both images and documents directly from the control panel of your printer. The printer produces high-quality color or black and-white copies on a variety of paper types, including transparencies.

NOTE: Before using your printer to copy a document or photo for the first time, review the procedures for loading paper and originals in [Chapter 4, Handling Paper](#).

Simple copying

Copy Document is the first setting on your printer. This enables you to place a one-page document on the scanner glass, and, if you have no need to change the default quantity, press **Start** from the Main menu to quickly initiate a copying job.

1. Place the original (document or photo) face down at the right front corner of the scanner glass .
2. From the control panel, press **Menu**.
3. **Copy Document** is the first menu option. As needed, press ▼ to select **Copy Photo**.

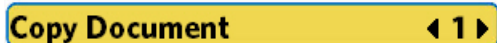

4. Modify the quantity of copies to be printed by pressing ▶ on the control panel until the number you want is shown between the ◀ and ▶ symbols displayed in the menu. To decrease any quantity greater than 1 shown, press ◀ until the number you want displays.
5. Press **Start** to initiate copying the document or photo.

Adjusting copy settings

You can change the default copy document settings for your printer using the control panel. Depending on whether you are copying a photo or a document, select the appropriate option submenu from the main menu.

1. From the control panel, press **Menu**.
2. **Copy Document** is the first option. As needed, press ▼ to select **Copy Photo**.
3. Press **OK** to display the **Copy Document Options** (or **Copy Photo Options**) menu.
4. You can press ▼ until the option you want to adjust is selected. If a value is displayed between the ◀ and ▶ symbols in the row, press ◀ or ▶ to select the value you want.
5. Any changes you make to the copy settings apply only to the current copy operation unless you save them as your default settings. To keep the settings as permanent, press ▼ until **Save as Defaults** is selected; press **OK**, and then select **Yes** and press **OK** to save the change(s) as the new default settings.
6. Press **Start** to initiate copying the document (or photo).

The available copy settings are shown in the table below.

Copy Document options

Menu Options	View Settings / Select	Settings
Quantity	◀ or ▶	1- 99
Copy Size ^a	◀ or ▶	Same size
		20%-500%
Photo Paper Quality		Automatic
Plain Paper Quality ^b	◀ or ▶	Normal
		Best
		Draft
Color	◀ or ▶	Color
		Black & White
Brightness	◀ or ▶	-3 to +3
Save as Defaults	OK	

^a Scaling is anchored to the upper left corner of the original.

Same Size The copy is the same size as the original. Cropping occurs if the original is larger than the paper size. The copy will contain white space if the original is smaller than the paper size.
Same Size is the default copy setting.

Scaling	Press ◀ or ▶ to set the scaling for your image.
----------------	---

^b Plain paper quality output:

Draft	Produces the fastest print speed, but the lowest quality.
Normal	Delivers high-quality output and is the default setting. Normal prints faster than Best
Best	Produces the highest quality for all paper and eliminates the banding (striping) effect that sometimes occurs in Draft and Normal modes. Best is the slowest print speed. If Kodak photo paper is loaded in the paper tray, this setting is used.

Copy Photo options

Menu Options	View Settings / Select	Settings
Quantity	◀ or ▶	1- 99
Copy Size	◀ or ▶	4x6
		4x7 (High Def)
		4x12 (Panoramic)
		5x7
		8x10
		8.5x11
		(Wallet) 2x3
Photo Paper Quality^a		Automatic
Plain Paper Quality^a	◀ or ▶	Normal
		Best
		Draft
Color	◀ or ▶	Color
		Black & White
Brightness	◀ or ▶	-3 to +3
Preview	◀ or ▶	No
		Yes
Save as Defaults	OK	

^a You need to specify a quality only for plain paper. If photo paper is loaded in the paper tray, the printer will output the best available quality using the **Automatic** setting. To review the settings for plain paper copying, see "Plain Paper Quality" under [Copy Document options, page 48](#).

Scanning converts text and images from documents and pictures placed on the scanner glass into electronic data, and then sends the data to your computer. To scan using the ESP 7 All-in-One printer, the printer must be connected to a computer. You can scan to the following destinations:

- Kodak Home Center
- Memory card or USB flash drive connected to the printer using the appropriate opening on the front panel of the computer
- Third-party scanner software application
- As a file on your computer

Before you start

Before you start scanning with this All-in-One printer, Kodak recommends that you use the Home Center software to configure the default scan settings. This way, you can easily manage the scan in your computer. See [Home Center Software, page 17](#) for additional information.

Using the Home Center software, you can adjust the following default settings for scanned photos and documents:

- Applications used for file destination(s).

 CAUTION:

If you save a document scan to an application, the scan cannot be later accessed by optical character recognition (OCR) software. If you want to be able to edit the text of the document after scanning it, save the scanned document as a file.

- File type used to save the scan.
 - The default setting for saved documents is .pdf (Portable Document Format). With third-party .pdf viewer software installed, this type of file can be viewed on Web pages or computers. You may also save a scanned document as .rtf (Rich Text Format). This is a standard file type which can be opened and edited in standard word-processing software applications.
 - The default setting for image files is .jpeg (Joint Photographic Experts Group) format. This standard file type can be opened and edited in standard image editing software applications, and can be viewed on Web pages.
- File storage location for saved scans.
 - Windows: Document scans are saved by default in the My Documents folder, and images are saved in the My Pictures folder. They are stored by default in these locations in a folder titled with the current date.
- Rule for naming scan files.
 - By default, scans are named "scan1", "scan2", etc.
- Default scan resolution and photo enhancement preferences.

- Color or black-and-white (Windows only).
- Print quality for scanning documents.

Before initiating a scan, you can also preview the scan in Home Center, and crop the output as desired. When you are satisfied with the intended results, you can initiate the scan directly from Home Center. See Home Center Help for instructions. To review how to access Home Center help, see [Home Center Software, page 17](#).

Scanning with Macintosh computers is accomplished by using the twain driver available with your Kodak software. Scanning is supported with any twain-enabled software application.

Simple scanning

Simple document scans

1. Place the original document at the right front corner of the scanner glass.
2. From the control panel, press **Menu**.
3. Press ▼ until **Scan** is selected. Press **OK**.
4. Press ▼ until **Scan To** is selected. Note that, if your printer is connected to a local computer, the default setting is **USB Connected Computer**. If you are connected to a network, all of the available computers are listed in alphabetical order.
5. Note that the default **Scan What** setting is **Document**.
6. Press ▼ until **Scan Destination** is selected. As needed, press ◀ or ▶ to specify which application on the computer will open the file. Kodak Home Center software appears on the list by default.
7. Press **Start**.
8. When the Scanner dialog window displays on your computer, follow the prompts to finish the scanning process.

Simple image scans

1. Complete Steps 1–4 from [Simple document scans, page 51](#).
2. Press ▼ until **Scan What** is selected. Press ▶ to specify **Photo**.



CAUTION:

Although you can scan a document using the Photo option and save it as an image (.jpeg) file, you will not be able to edit the text later in your computer. If you want to edit a scanned document later, make sure that you scan it as a Document, not as a Photo.

3. Complete Steps 6–8 from [Simple document scans, page 51](#).

Scanning multiple originals simultaneously

When the **Scan What** option is set to **Photo** in the Home Center software, your All-in-One printer can detect multiple photos placed on the scanner glass. Allow some space on the scanner glass between each item, and use the Home Center software to save each photo as a separate file. Any images on the scanner glass that overlap are interpreted by the software as a single image file.



CAUTION:

Home Center cannot interpret two or more documents, photos, or a combination of documents and photos, as separate scanned items when the Scan What option is set to Document.

Adjusting scan settings

You can change the default scan settings for your printer using the control panel. When you change scan settings from the control panel, the settings apply only to the current scan job. To apply scan settings to all future scan jobs, you can save your changes.

1. From the control panel, press **Menu**.
2. Press ▼ until **Scan** is selected.
3. Press **OK** to display the **Scan Options** menu. A sample of the menu is shown in the illustration below.

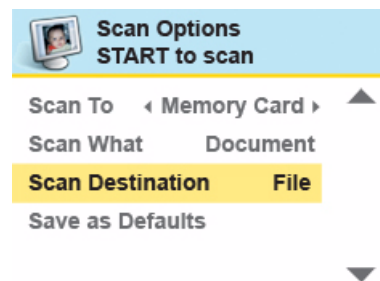

4. Here you can press ▼ until the option you want to adjust is selected. If a value is displayed between the ◀ and ▶ symbols in the row, press ◀ or ▶ to select the value you want.
5. Any changes you make to the scan settings apply only to the current scan operation. To keep the settings as permanent, press ▼ until **Save as Defaults** is selected, and then press **OK**.
6. Press **Start** to initiate the scan.

The available scan settings are in the following table:

Scan options

The available scan settings are in the following table:

Menu Options	View Settings / Select	Settings
Scan What^a	◀ or ▶	Document
		Photo
Scan To^b	◀ or ▶	Computer
		Memory Card
Scan Destination^c	◀ or ▶	File
		[Application Name]
Save As Default	OK	

^aIf you select **Document** and save the scan to a **File**, the scan is saved as a document (.pdf or .rtf) file, even if the original is a photo. If you select **Photo**, a text document will be scanned as an image file, and cannot be read by optical character recognition (OCR) software.

^bIf your printer is connected to a network, more than one computer name will appear in this list. If your printer is connected to a printer by the USB cable, the computer name in the menu is called **USB Connected Computer**.

^cYou must create a list of one or more applications using Home Center software for any to display by name in the **Scan Destination** settings. Each application will appear as a separate setting in the display. (Kodak Home Center software is displayed by default; you do not need to configure your destinations to include it.)

In addition, before using a **Scan Destination** setting of **File**, familiarize yourself with the location where the files will be saved and with the file naming setting. This will prevent problems later in finding the scan file on your computer.

Maintaining Your Printer

Your printer requires little maintenance. However, Kodak recommends cleaning the scanner glass and lid backing regularly to remove dust and fingerprints. Fingerprints and other debris on the glass or lid backing could slow down the printer's performance, and affect the quality and accuracy of scanning.

Service agreements are available in some countries. Contact dealers for Kodak products for more information.

For recycling and or disposal information, contact your local authorities. In the U.S., visit the Electronics Industry Alliance Web site at www.eiae.org.

General care

 CAUTION:

Always disconnect the power on the printer before cleaning it. Do not use harsh or abrasive cleaners or organic solvents on the printer or any of its parts.

- To clean the printer, wipe the outside with a clean, dry cloth.
- Keep the surrounding area vacuumed and litter-free.
- Protect the printer from tobacco smoke, dust, sand, other small particles (such as crumbs), and liquid spills.
- Avoid placing objects on the printer.
- Keep the printer supplies away from direct sunlight and out of high-temperature environments.
- Do not allow chemicals, such as suntan lotion, to come into contact with the painted surface of the printer.
- If the printer has been exposed to bad weather or has water inside it, turn it off and let it dry completely. If this does not solve the problem, contact customer support (see [Contacting Kodak Customer Service & Support, page 2](#)).

Cleaning the scanner glass

For good copies and scans, ensure the printer's scanner glass and lid backing are clean; dust the exterior as needed.



WARNING: Do not use abrasives, acetone, benzene, or carbon tetrachloride on the glass, as they can damage it. Do not place or spray liquid directly on the glass. The liquid might seep under the glass and damage the device.

1. Unplug the printer and raise the lid.



2. Clean the glass with a soft cloth or sponge slightly moistened with a nonabrasive glass cleaner.
3. Dry the glass with a lint-free cloth.
4. When finished cleaning, plug in the printer.

Cleaning the scanner lid

Minor debris can accumulate on the document backing located underneath the scanner lid of the Kodak printer.



WARNING: Do not use paper-based wipes, as these might scratch the underside of the scanner lid. Do not use harsh or abrasive cleaners or organic solvents on the printer or any of its parts.

1. Unplug the printer and raise the lid.



2. Clean the underside with a soft cloth or sponge, slightly moistened with a mild soap and warm water.
3. Wipe the underside gently to loosen debris. Do not scrub.
4. Dry the underside with a chamois or soft cloth.
5. If further cleaning is needed, repeat the previous steps using isopropyl (rubbing) alcohol, and wipe the underside thoroughly with a damp cloth to remove any residual alcohol.
6. When finished cleaning, plug in the printer.

Monitoring and adjusting the printer's performance

From the control panel, you can perform many tasks to keep this printer in good working order. For example, you can check the status of the printer's inkjet nozzle to ensure high-quality prints. Kodak recommends that you run a nozzle check if you are experiencing changes in image quality. You can also use the **Printhead Alignment** function if you see degradation in print quality.

1. Make sure that there are 5-10 sheets of plain paper loaded in the bottom paper tray.
2. Press **Menu** to display the main menu.
3. Press ▼ until **Maintenance** is selected.
4. As needed, press ▼ until the desired option is selected.
5. Press **OK**.
6. Follow the prompts on the LCD display to initiate or cancel the task.

Maintenance options

Menu Options	Select
Check Ink Levels	OK
Check Paper Levels	OK
Nozzle Check	OK
Printhead Alignment	OK
Clean Printhead	OK
Print Test Page	OK
Format Memory Card	OK



WARNING: Formatting will erase all the data on a memory card.



TIP: A printhead alignment and a check of the inkjet nozzle can also be initiated from the Home Center software.

Windows: Open the Home Center Help panel by clicking Help  on the Home Center window, as needed. Click **Maintenance**, and then click **Nozzle Check** or **Printhead Alignment**.

Macintosh: Open Home Center window from the dock, and click **Maintenance**, and then click **Nozzle Correction** or **Printhead Alignment**.

Replacing ink cartridges

Your printer uses separate black and color ink cartridges. The ink levels are shown on the control panel and in the printer software.



CAUTION:

For the best quality prints, store ink cartridges in locations where the temperature does not exceed 85°F (30°C).



WARNING: Use genuine Kodak ink cartridges to ensure best results and avoid printhead damage not covered under warranty. Third-party ink cartridges may not work with your printer.

1. Make sure the printer is turned on.
2. Open the printer access door by lifting from the recessed hand-holds on the sides of the unit.



The printhead moves to an accessible position for handling the ink cartridges. The ink cartridges are seated in the printhead.

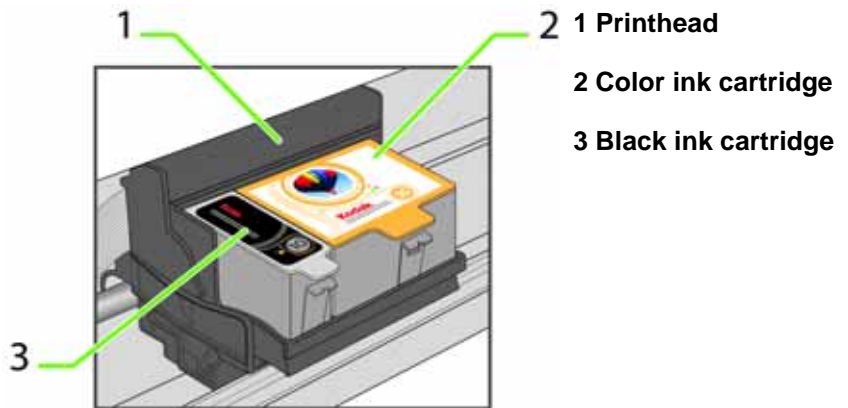

3. Wait until the printhead stops moving, then pinch the latch on the old ink cartridge with your thumb and forefinger and lift it out of the printhead.

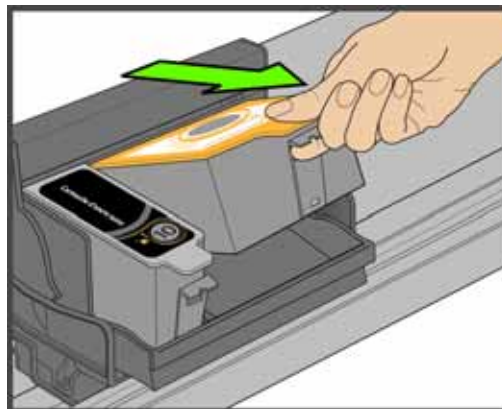

NOTE: You can take your used ink cartridges to most office supply or electronics stores for safe disposal.

4. Open the box containing the new ink cartridge.
5. Remove the bagged ink cartridge from the box, tear open the bag at the notch, and remove the ink cartridge.



CAUTION:

Insert the ink cartridge immediately to prevent any drying of the ink.

6. Remove the orange cap from the cartridge by grasping the top edge and pulling/rotating it off the ink cartridge. Discard the orange cap.

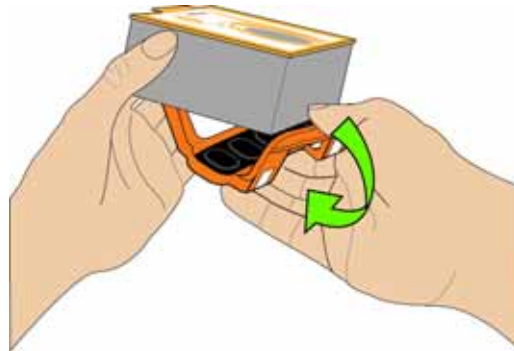

7. Insert the ink cartridge into the printhead.

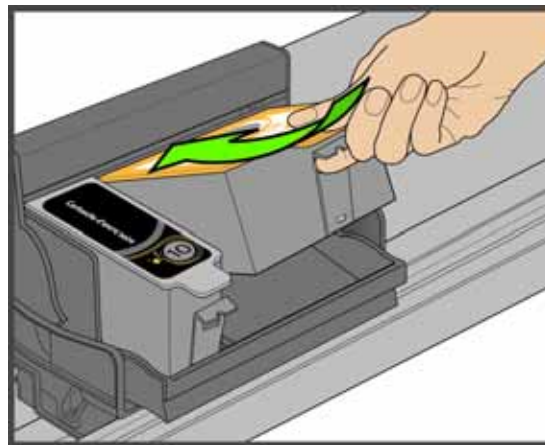

8. Press down on the tab until you hear a click and feel the latch snap into position.

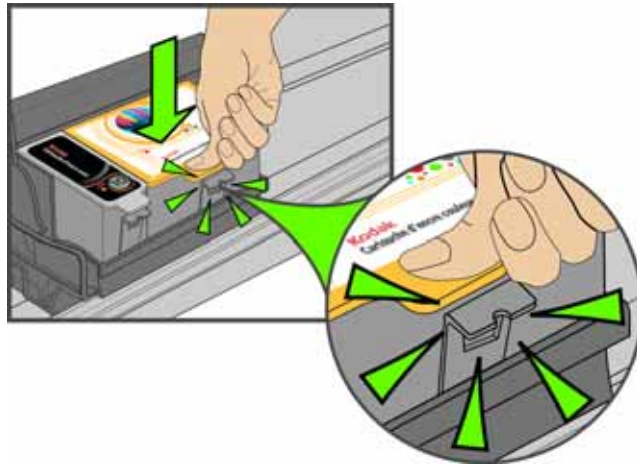

NOTE: Listen carefully during this step; make sure you hear the ink cartridges click into place in the printhead. This seats the cartridges properly, and prevents ink from being dispensed incompletely during your print or copy jobs.

9. Close the printer access door. The printhead moves to its ready position and prepares the new ink cartridge for use (this could take up to a minute).

Replacing the printhead

If your printhead is damaged or broken, you may replace it yourself.

1. Make sure your printer is turned on.
2. Open the printer access door by lifting from the recessed hand-holds on the sides of the unit.



The printhead moves to an accessible position for handling the ink cartridges. The ink cartridges are seated in the printhead.

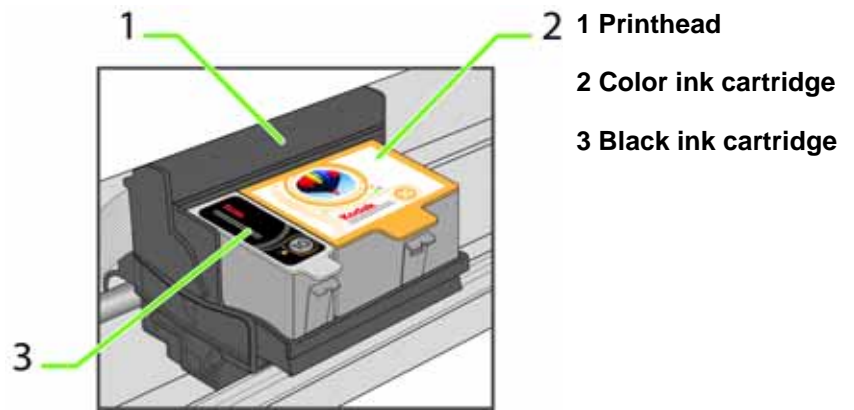

- Pinch the latch on the ink cartridge with your thumb and forefinger and lift it out of the print head. Remove both ink cartridges.

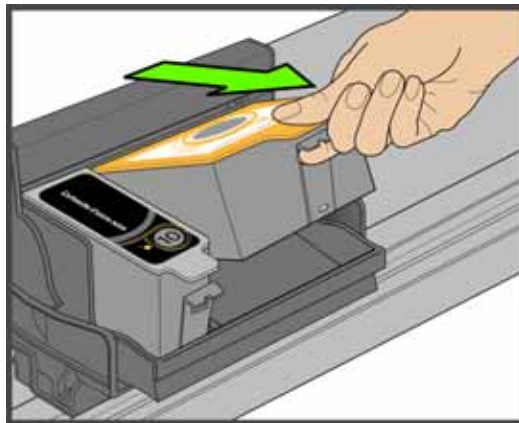

CAUTION:

Insert the ink cartridges into the newly installed printhead as soon as possible to prevent any drying of the ink.

- Unlatch the printhead by lifting the rectangular latch on the top of the printhead.

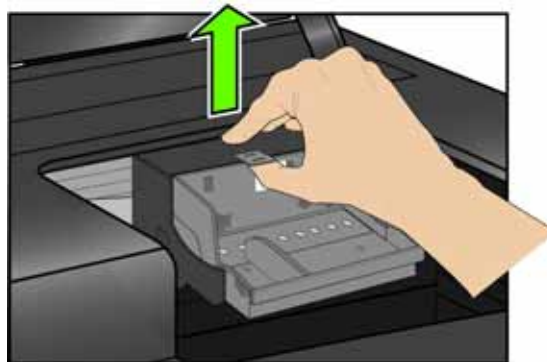

- Remove the old printhead from the carriage.



6. Remove the new printhead from its bag.



 **CAUTION:**
Do not touch copper contacts on the printhead, as this may damage it.

7. Remove and discard the black plastic casing and the orange protective cap.

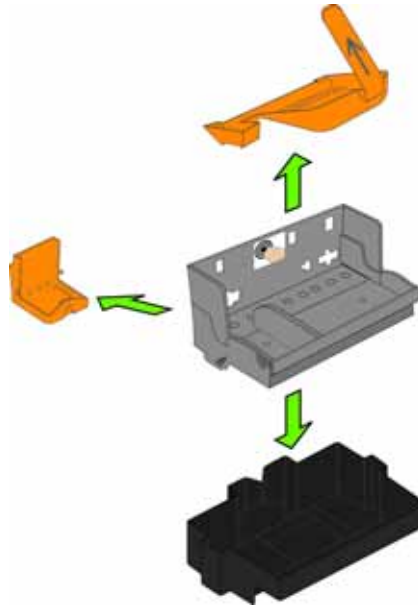

8. Place the new printhead into the carriage.

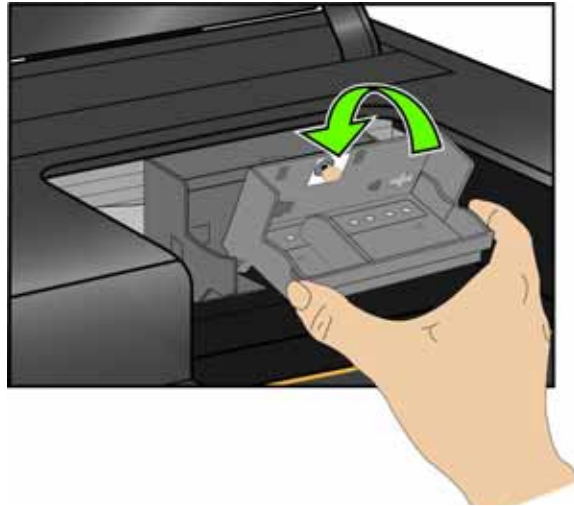

9. Push firmly against the target label on the printhead until you hear it click into place.

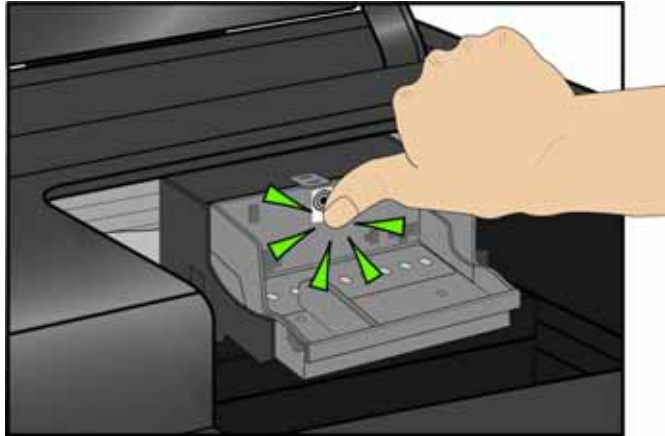

10. Reinstall the ink cartridges. As needed, see [Replacing ink cartridges, page 57](#).

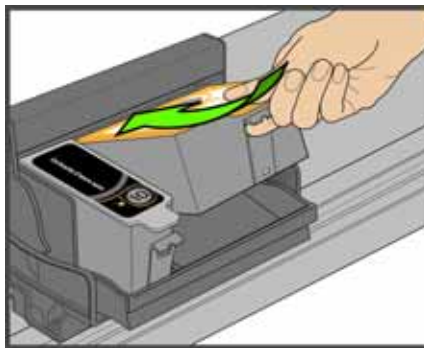

Listen carefully during this step; make sure you hear the ink cartridges click into place in the printhead. This seats the cartridges properly, and prevents ink from being dispensed incompletely on your print or copy jobs.

11. Close the printer access door. The printer should now complete a printhead calibration to ensure that it is ready for normal operation.

Upgrading the printer software - for Windows

You can upgrade the software and firmware for in your printer with the most recent release available. This requires an Internet connection.

NOTE: The firmware cannot be upgraded when your printer is connected via a network or Wi-Fi. Your printer must be connected to the computer with a USB cable in order to perform a firmware upgrade.

1. If your connection is via Ethernet, disconnect the Ethernet cable. If your connection is via Wi-Fi, press **Menu**. Navigate to **Network Settings** menu and press **OK**. Select **WIFI Radio off**.
2. Connect the printer to the computer with a USB cable. The computer must be connected to the internet.
A pop-up window appears at the bottom right corner of your computer monitor stating "Found New Hardware KODAK ESP 7 AIO," then changes to "Found New Hardware. Your new hardware is installed and ready to use."
3. Open the Kodak AiO HomeCenter.
4. Click the **Help** button to open the Help Panel.
5. Under the General Links, click **Maintenance**. If there is an update available, you will receive a pop-up window or you can click on **Firmware Upgrade**.
6. Click **OK** to upgrade. The printer software will begin to load. Do not turn off your printer while the update is in progress.
7. When the update is complete, click **OK**.
8. Close the maintenance window. The printer firmware is updated.
9. Next you will update the Home Center software, as well as the printer and scanner drivers.
10. Under the **Web Links** on the Help Panel, click on **Check for updates**.
11. If an update is available, download it to your computer.
12. When the update is complete, disconnect the USB cable and reconnect your printer to the Ethernet or Wi-Fi network.
13. Use the **Windows Control Panel** to delete the printer from your computer. The USB printer is named Kodak ESP7 AiO. This will remove the USB drivers.

Upgrading the printer software - for Macintosh



You can upgrade the software and firmware for in your printer with the most recent release available. This requires an Internet connection.

NOTE: The firmware cannot be upgraded when your printer is connected via a network or Wi-Fi. Your All-in-One printer must be connected to the computer with a USB cable in order to perform a firmware upgrade.

1. If your connection is via Ethernet, disconnect the Ethernet cable. If your connection is via Wi-Fi, press **Menu**. Navigate to **Network Settings** menu and press **OK**. Select **WIFI Radio off**.
2. Connect the printer to the computer with a USB cable. The computer must be connected to the internet.
3. Open a browser window and enter the following URL:
<http://www.kodak.com/go/aiosupport>.
4. Select your printer model.
5. Under **Downloads**, select **Software Driver and Firmware Downloads**.
6. Select your operating system from the drop down list.
7. Download the software.
8. Double-click on the *.dmg file.
9. Double-click on **Install Software**.
10. Follow the onscreen prompts on the installer.
11. Upon completion of the install, click **Restart**. The Home Center Software and the printer and scanner drivers are updated.
12. Next you will update printer firmware.
13. Open a browser window and enter the following URL:
<http://www.kodak.com/go/aiosupport>.
14. Select your printer model.
15. Under **Downloads**, select **Software Driver and Firmware Downloads**.
16. Select your operating system from the drop down list.
17. Download the firmware.
18. Double-click on the *.dmg file.
19. Double-click on **Kodak AiO Updater**.
20. Upon completion of the install, click **Quit**. The printer firmware is updated.

Troubleshooting “quick start”

Kodak provides several methods to help you troubleshoot your All-in-One printer issues. Here are some quick tips:

- Turn off your printer and then unplug it. Wait five seconds, and then plug the power cord back into the printer. Finally, turn the printer back on.
- Confirm that you are using a 2.0 USB cable to connect the printer to your computer. If you need to buy one, they are available online at www.kodak.com/go/aio, or from your local electronics and printer retailer.
- Make sure that you have the most up-to-date All-in-One printer software and Help files from the Internet. Visit www.kodak.com/go/support to download the latest files.
- View the troubleshooting information found in Kodak Home Center software on your computer. After opening Home Center, click the question mark (?) button:
 - **Macintosh:** The  button is located at the lower-left of the Home Center window.
 - **Windows:** The  button is located at the upper-right of the Home Center window.Use the Help window to view troubleshooting topics. (Windows users can also select **Troubleshoot** from the Help panel on the main Home Center window.)
- You can also get troubleshooting help at the Kodak Web site. Visit www.kodak.com/go/support for support for your Kodak printer.

NOTE: Many issues with degradation in performance or print quality can be resolved by meeting or exceeding the recommended system requirements. See [Chapter 10, Product Safety Specifications](#).

General troubleshooting

Printer fails to power on

Probable Cause

The power supply is not properly connected.

Corrective Action

- Make sure the electrical power cord is connected to the alternating current(AC) power adapter, and is plugged into a grounded power outlet or power strip.
- If using a power strip, make sure it is turned on.
- If using a switched power outlet, make sure the switch is on.
- Make sure the power outlet is supplying power.
- Verify the light on the Kodak printer power cord plug is lit.

Probable Cause 2

The USB cable was unplugged from the printer and then reconnected; or, power to the printer is interrupted.

Corrective Action

Restart the computer.

Probable Cause 3

The USB cable is not 2.0 compliant.

Corrective Action

- Replace the USB cable with a USB 2.0 compliant cable.

NOTE: For optimal quality and performance, use a good-quality high speed USB 2.0 cable. When connecting to the Kodak All-in-One printer, use the USB ports located in the back of the computer. Any USB 2.0 hubs that are used should be self-powered.

- Restart the computer.

If none of the above corrects the problem, contact Kodak support.

Device not recognized

Probable Cause

Any of the following can prevent your Kodak All-in-One printer from reading a connected device (digital camera, USB drive, or memory card).

- The camera is turned OFF.
- The USB connector on a USB drive is not fully inserted into the USB port.
- The memory card is not completely inserted, or is not inserted into the correct card slot.
- The file system on the device is corrupt.
- More than one device is inserted at a time.
- The USB device is not supported.
- The USB cable is faulty.

Corrective Action

- Correct any connection problems and try again.
- If the file system is corrupt, reformat it.
- Disconnect the unsupported device.

NOTE: If the USB drive uses an NTFS or HFS formatting system, the printer may not be able to read it. Macintosh users may need to transfer these files directly to their computer, and then print to the printer from there.

Ink cartridge not recognized

Probable Cause 1

The color or black ink cartridge installed was not recognized.



WARNING: Generic or non-Kodak ink cartridges may not function with the All-in-One printer. Kodak recommends using genuine Kodak ink cartridges.

Corrective Action

Install a genuine Kodak ink cartridge.

Probable Cause 2

One of the ink cartridges needs to be replaced.

Corrective Action

Replace the ink cartridge.

Multiple paper feed

Probable Cause

Multiple sheets of paper were pulled through printer.

Corrective Action



CAUTION:

Kodak Inkjet paper is recommended for your Kodak All-in-One printer

1. Remove the paper from the paper tray.
2. Carefully “fan” the paper to keep the sheets from sticking together.
3. Reload the paper tray. Do not overfill.
4. Press **OK**.

Multiple pictures not scanned properly

When scanning or copying, the Kodak printer can detect multiple images on the scanner glass, straighten them, and create individual files. If you are having trouble with this feature, check the following:

Probable Cause

Your photos are not placed optimally on the scanner glass.

Corrective Action

- Make sure that your photos do not overlap.
- Place photos away from the edges of the scanner glass.
- Some images do not scan well. Light-colored images may not be detected as separate images.
- You may need to make adjustments to the scanning area using the Preview feature in the Kodak Home Center.

Probable Cause 2

The scanner glass is dirty.

Corrective Action

Make sure the scanner glass is completely clean or the photos might not scan properly (see [Cleaning the scanner glass, page 55](#)).

Probable Cause 3

The scanner lid is dirty.

Corrective Action

Clean the scanner lid (see [Cleaning the scanner lid, page 55](#)).

Probable Cause 4

The **Scan What** ◀ **Document** ▶ option on the Scan menu was selected, instead of the **Scan What** ◀ **Photo** ▶ option.

Corrective Action

Scan the photos again in the appropriate format.

No communication with computer

Probable Cause

Your Kodak printer is not connected to your computer.

Corrective Action

- Make sure your printer is plugged in and turned on.
- Make sure you are using the proper USB cable (USB 2.0).
- If you are using a USB hub to connect the USB cable to the computer, make sure that it has power. Use a self-powered (connected to an electrical outlet) USB hub instead of one that uses the computer's internal power.
- Check the connection from your computer to your printer. Ensure that the square end of the USB cable is plugged in to the USB port on the back of your printer, and the flat end into a USB port on your computer.
- You may need to disconnect other printers or scanners from your computer.
- After checking connections, restart your computer.
- Make sure your computer meets the minimum system requirements, otherwise upgrade your system if necessary.

For more information on connecting your printer to your computer, see the Start Here booklet that came with your printer.

No paper feed

Probable Cause

The paper tray may be empty, or there may be a problem with the paper in the tray.



CAUTION:

Kodak Inkjet paper is recommended for your Kodak All-in-One printer.

Corrective Action

If the tray is empty, load paper into the paper tray, then resume printing. Check for a message from the printer status monitor (Windows) or the printer queue window (Macintosh) on your computer. Check for a problem with the paper in the tray.

To check the paper

1. Inspect the paper and make sure no paper sheets are damaged in any way. Reload with new paper, if necessary.
2. Carefully “fan” the paper to keep the sheets from sticking together.
3. Reload the paper tray. Do not overfill.
4. Press **OK**.

One or more of the colors on the calibration sheet is missing

Probable Cause

The printhead is not installed correctly. If the printhead has been working properly, it may have come loose.

Corrective Action

If the printhead has come loose:

1. Open the printer access door, and then remove the black and color ink cartridges.
2. Press the printhead release button.
3. Lift the printhead out.
4. Reinsert the printhead and ink cartridges.

NOTE: See [Replacing the printhead, page 60](#) for illustrated instructions for performing this procedure.

If this does not resolve your printing issue, contact Kodak Service and Support.

Paper jam

Probable Cause

The paper did not advance, was not picked up properly from the paper tray, or is lodged inside the printer.



CAUTION:

Kodak Inkjet paper is recommended for your Kodak All-in-One printer.

Corrective Action

1. Remove the paper from the tray you used when the jam occurred.
2. Turn off the printer.
3. Open the rear access area and pull the paper out from the rollers without tearing it.



CAUTION:

If the paper tears while removing it, make sure you remove all the torn pieces. More jams are likely to occur when torn pieces are left in the printer.

4. Reload the paper tray, but do not overfill it.
5. Turn the printer on.
6. Press **OK**.

Printer not responding

Probable Cause

The firmware or software is not in a ready state.

Corrective Action

- Turn the printer off and turn it back on.
- If the problem persists, unplug the power cord from the power supply and plug it back in.
- If the problem continues to persist, restart your computer.

Transfer pictures failure

Problem

Nothing happens when you try to transfer photos to the computer.

Corrective Action

- Remove the memory card or USB device and reinsert it.
- Check the power connection to the computer.
- If you are trying to transfer photos from a memory card and a PictBridge camera is connected, disconnect the camera.

- Close any unnecessary software applications, and minimize any remaining application windows. Follow any messages on the screen that may have been hidden by other windows.
- Disconnect, then reconnect the USB cable from the printer to the computer.
- Make sure you are using a high-quality USB cable which is communicating with the computer. (See [No communication with computer, page 70.](#))
- If the pictures are on a USB device, make sure it uses a supported file system (see [Device not recognized, page 68.](#))
- Make sure your computer meets the minimum system requirements for using your printer (see [General troubleshooting, page 67.](#)). Upgrade your system if necessary.

User guide on the CD is obsolete

Probable Cause

The User Guide has been updated since the software CD was released.

Corrective Action

- Download the most recent version of the User Guide from Kodak.com.

Wrong paper size

Probable Cause

The print size or paper size you selected may be larger or smaller than the paper found in the paper tray.

Corrective Action

- Replace the paper in the paper tray with the correct size.
- Press **OK**.

If the situation continues, contact Kodak support.

Macintosh OS X troubleshooting

Non-intel Mac only: black screen or screen freeze occurs when applying printer settings via the Home Center software

Probable Cause

This error only occurs with non-Intel Macintosh computers running Leopard OS version 10.5. Apple has confirmed that there are problems running the latest version (Leopard) on G5 processors.

Corrective Action

- Upgrade to Macintosh OS 10.5.2.

Windows Vista troubleshooting

WIA (Windows Image Acquisition) error: service has stopped working

This results in the inability to connect a camera and transfer pictures from the camera. Neither the camera nor the printer is visible through the **Transfer All to My PC** option on the Print Photo Options menu.

Probable Cause 1

The USB cable is unplugged and reconnected to the printer.

Probable Cause 2

A printer-terminated error occurs.

Probable Cause 3

Power is interrupted.

Corrective Action

Restart the computer and printer.

Home Center software on Windows works incorrectly following software upgrade

Probable Cause

Some changes in the Home Center software on Windows systems may have been affected by enabled Security and/or User Account Control settings.

Corrective Action

1. Right-click on the Home Center icon (shortcut) on the Desktop.
2. Select **Properties**.
3. Select the Compatibility tab.
4. Check the box that says "Run the program as an administrator."

Print troubleshooting

Use this section to resolve print problems.

Envelope printing incorrect

Probable Cause

The envelopes are not loaded correctly.

Corrective Action

1. Remove the envelopes from the paper tray.
2. Straighten the stack of envelopes against a flat surface. Reload the stack into the paper tray print side down, with the envelope flap aligned to the left.
3. Squeeze the paper guide and slide it to the right until it touches the edge of the envelopes.

Multiple-page document not printing in reverse order (Windows only)

NOTE: On a Macintosh, **Reverse Page Order** printing is the default setting. See [To set a Macintosh to print the first page of a document first](#): below.

Probable Cause

The print settings on your computer are set to print the first page of your document first.

Corrective Action

Configure the printer to print the document in reverse order, so the pages are in the correct order when printing is complete.

To set a Windows PC to print in reverse order:

1. On the Windows Desktop, click **Start > Settings > Control Panel**.
2. In the Control Panel window, open Printers or Printers and Faxes.
3. In the Windows Explorer window, right-click on the Kodak All-in-One printer in the **Name** column, and then select **Printing Preferences**.
4. On the Printing Preferences window, select **Print last page first** on the General tab.

Multiple-page document not printing in first-page first order (Macintosh only)

Probable Cause

The print settings on your computer are set to print the document in reverse order.

Corrective Action

Configure the printer to print the document first-page first.

To set a Macintosh to print the first page of a document first:

1. On the File menu, select **Print**.
2. On the Print dialog, select **Paper Handling**.
3. Select the **Normal Page Order** option.

PictBridge camera not detected

Probable Cause

The camera is not communicating with the printer.

Corrective Action

- Make sure the camera is turned on.
- Check the USB connections from the PictBridge camera to the printer.
- If disconnected, reconnect the USB cable from the PictBridge camera to the printer.

- Make sure the connected camera is PictBridge-compatible. See your camera or device user's guide for details.
- Check the camera batteries.

Picture cropped

- Change the picture quality setting (or resolution) on your digital camera to 3:2. See your camera user's guide for details.
- Adjust cropped photos using the Kodak Home Center software (Windows only) or other image editing software on your computer.
- If you are printing from an application on your computer, select the proper paper size from the printer options.

NOTE: Cropping may vary, depending on the selected picture size and size of the output paper. The dimensions of the photo on the camera are slightly different from each paper size so a portion will be cropped to fit perfectly on whatever paper size was selected.

Picture print smudged

Probable Cause

Fingerprints are on the glossy side of paper.

Corrective Action

Handle paper by the edges.

Picture will not print

A selected picture does not print.

Probable Cause 1

The image file may be corrupt.

Corrective Action

Review the picture on the camera or computer and delete it if necessary.

Probable Cause 2

The image file may not be in JPEG format.

Corrective Action

The Kodak printer can print only JPEG files in stand-alone mode. Connect the printer to a computer and use software to print other image formats.

Poor print quality

Probable Cause

Low resolution image file or the printer may need maintenance.

Corrective Action

- Align the printhead (see [Monitoring and adjusting the printer's performance, page 56](#)).
- Perform a nozzle check with the Home Center software.
- Clean the printhead from Home Center, or from the **Maintenance** menu on the printer control panel. If the printhead is clogged, the printouts should begin to improve with two or three cleanings. Repeat the cleaning cycle until the printout stops improving.
- If the problem still persists, you may need to replace the printhead (see [Replacing the printhead, page 60](#).)

Print skewed or slanted

Probable Cause 1

The paper is not properly loaded in the tray.



CAUTION:

Kodak Inkjet paper is recommended for your all-in-one printer.

Corrective Action

Realign the paper in the paper tray.

1. Remove paper and check for wrinkles and tears.
2. Slide the paper-width guide away from the paper.
3. Straighten the stack of paper against a flat surface, and reload it into the paper tray.
4. Slide the paper edge guide up against the edge of the paper.

Probable Cause 2

More than one type or size of paper is loaded.

Corrective Action

Load only one type or size of paper at a time.

Print spotted

Probable Cause

Paper may be dirty.

Corrective Action

Use a dry, lint-free cloth to wipe clean. For excessive dirt or debris, thoroughly clean the paper tray, and load new paper.

NOTE: When you are not using the printer, keep paper tray covers closed to keep dust and debris from collecting on the paper or inside the printer.

Print too dark

- Try taking the picture again with the flash on, or move within the flash range of the camera. Refer to your camera user's guide for details.
- Adjust the exposure compensation on your camera, and try taking the picture again. Refer to your camera user's guide for details.
- Edit the picture using Kodak Home Center (Windows only) or other image editing software.
- Make sure the printer is not placed in direct sunlight or is not operating in a high-temperature environment.

Print too light

 CAUTION:

For best results, use Kodak paper and ink cartridges for your Kodak All-in-One printer.

- Make sure the paper is loaded with the print side face down. Reload it if necessary.
- Try taking the picture again with the flash off. Refer to your camera user's guide for details.
- Adjust the exposure compensation on your camera and try taking the picture again. Refer to your camera user's guide for details.
- Edit the picture on your computer.

Printing slow

NOTE: When printing a large number of prints, printing may slow down to prevent the printhead from overheating.

- Make sure the printer is not placed in direct sunlight or is not operating in a high-temperature environment (higher than 95° Fahrenheit or 35° Celsius).
- Close any unnecessary software applications.
- Make sure your computer meets the minimum system requirements. Upgrade your system if necessary.

Printing stops

Printing stops during mid-print. Paper stops feeding, and status light may blink.

 CAUTION:

For best results, use Kodak paper and ink cartridges with your printer.

To check the paper:

1. Remove any loose paper from the printer. Check the paper access door in the rear of the printer.
2. Inspect the paper supplies and reload with new paper if necessary.

3. Carefully “fan” the paper to keep the sheets from sticking together.
4. Reload the paper tray. Do not overload.
5. Press **Start** to continue.

White edges on borderless prints

Probable Cause 1

White edges can appear when there are slight misalignments between the printer and paper. Some software applications are able to “hide” these small misalignments so that the prints look borderless.

Corrective Action

- Realign the paper in the tray.
- Use the application's Fill Page option, or resize the picture so it is slightly larger than the paper size.

Probable Cause 2

If the image's proportions or dimensions are not compatible with the selected paper size, the print usually will not be borderless. For example, if a square image is printed on 4 x 6-inch paper, it will often print as a 4 x 4-inch image, with white edges on each side of the print job.

Corrective Action 2

Crop the image so it is compatible with the selected paper size.

Copy troubleshooting

Copy cut off

Probable Cause

The original is larger than the paper loaded.

Corrective Action

When the original is larger than the paper loaded, reduce copy size to fit the size of the paper loaded.

Scan troubleshooting

Scan fails

Probable Cause 1

Your computer is not turned ON.

Corrective Action

Turn on your computer.

Probable Cause 2

Your Kodak printer is not connected to your computer.

Corrective Action

Connect your Kodak printer to your computer with a standard USB cable.

Probable Cause 3

The Kodak Home Center software is not installed.

Corrective Action

Insert the Kodak printer installation CD and install the software.

Probable Cause 4

Your computer system resources may be low.

Corrective Action

- Turn off your computer and the printer, and then turn them back on.
- If the problem still persists, try scanning at a lower resolution.

Probable Cause 5

The memory card to which you are scanning does not have enough free space to save the scanned photo.

Corrective Action

Remove some files from the memory card to free up some space.

Scanned image blank

Probable Cause

Your original is not placed correctly on the scanner glass.

Corrective Action

Place your original face down in the proper corner of the scanner glass.

Network troubleshooting

Wired network troubleshooting

Computer unable to detect the All-in-One printer

Probable Cause 1

Cables are not connected properly.

Corrective Action

Check the following cables to ensure they are properly connected.

- Cables between the hub or router and your computer
- Cables between the All-in-One printer and the hub or router
- Cables to and from your modem or printer Internet connection (if applicable)

Probable Cause 2

Your Local Area Network card (LAN card) is not set up properly.

Corrective Action

Verify the setup of your LAN card.

To check your LAN card (Windows)

1. Open the Control Panel.
2. Double-click **System**.
3. In the **System Properties** dialog box, click the Hardware tab.
4. Click **Device Manager**.
5. Make sure your card shows up under Network Adapters.
6. Refer to the documentation that came with your card.

To check your LAN card (Macintosh)

1. Click the Apple icon on the Menu bar.
2. Select **About This Mac** and then click **More Info**. The System Profiler is displayed.
3. In the System Profiler, click **Network**.
4. Make sure your LAN card appears in the list.

Probable Cause 3

You do not have an active network connection.

Corrective Action

Check to see if you have an active network connection.

To see if you have an active network connection

Check the two Ethernet indicator lights on the top and bottom of the RJ-45 Ethernet jack on the back of the printer. The lights indicate the following:

Top light	If this light is a solid green, the device is properly connected to the network, and communications have been established. If the top light is off, there is no network connection.
Bottom light	This yellow light flashes when data is being sent or received by the device over the network.

To establish an active network connection

1. Check the cable connections from the All-in-One printer to your gateway, router, or hub to ensure connections are secure.
2. If the connections are secure, turn off the power on the All-in-One printer, and then turn it on again. Press the **On/Off** button on the control panel to turn the printer off, and press it again to turn it back on. Also, turn off the power on your router or hub, and then turn it on again.

No TCP/IP

Probable Cause

Your Local Area Network (LAN) card is not installed properly.

Corrective Action

Make sure your LAN card is installed properly and set up for TCP/IP. See the instructions that came with your LAN card.

Printer not found

Probable Cause

The All-in-One printer is not turned on.

Corrective Action

Turn on the printer.

Probable Cause 2

You do not have an active network connection.

Corrective Action

Make sure you have an active network connection.

To make sure your network connection is active

1. If the connections are secure, turn off the power on the All-in-One printer, and then turn it on again. Press the **On/Off** button on the control panel to turn the printer off, and press it again to turn it back on. Also, turn off the power on your router or hub, and then turn it on again.
2. Check the cable connections from the printer to your gateway, router, or hub to ensure connections are secure.
3. Make sure the printer is connected to the network with a CAT-5 or better Ethernet cable.

Probable Cause 3

Cables are not connected properly.

Corrective Action

Check the following cables to ensure they are connected properly.

- Cables between the All-in-One printer and the hub or router
- Cables between the hub or router and your computer
- Cables to and from your modem or printer Internet connection (if applicable)

Probable Cause 4

A firewall, anti-virus, or anti-spyware application is preventing the printer from accessing your computer.

Corrective Action

Many firewall security programs have different levels of firewall security (Block All, High, Medium, Low), and some high levels of protection may prevent certain software applications and/or services from being permitted to operate through the network with enabled firewall security.

Via the firewall security program on your PC, manually allow inbound and outbound application permission through the firewall for the following services required for the wireless All-in-One operations:

Bonjour Service

(C:\Program Files\Bonjour\mDNSResponder.exe)

Kodak AiO Network Discovery Service

(C:\Program Files\Kodak\Printer\Center\EKDiscovery.exe)

Kodak AiO Device Service

(C:\Program Files\Kodak\Printer\Center\KodakSvc.exe)

Kodak AiO Home Center

(C:\Program Files\Kodak\Printer\Center\AiOHomeCenter.exe)

Go to www.kodak.com/go/inkjetnetworking for detailed instructions on adding these firewall permissions for the Kodak printer network services for 20 of the top rated firewall security programs on the market. If necessary, visit your firewall Manufacturer's online help Web site.

More advanced network users may also choose to allow inbound and outbound port permission through their firewall for the following ports associated with the wireless printer:

Port 5353 (UDP)

Port 9322 (TCP)

Probable Cause 5

A Virtual Private Network (VPN) is preventing the printer from accessing your computer.

Corrective Action

Try temporarily disabling the VPN before proceeding with the installation.

NOTE: The All-in-One printer functionality will be limited during VPN sessions.

Probable Cause 6

The Ethernet cable is not plugged into the router, switch, or hub. The cable may also be defective.

Corrective Action

Try reinserting the cables. Or, if necessary, try a different cable.

Probable Cause 7

The All-in-One printer is assigned an AutoIP address instead of DHCP.

Corrective Action

This indicates that the printer is not connected properly to the network. Check the following:

- Make sure all cables are connected properly and securely.
- If the cables are connected properly, your access point, router, or home gateway might not be sending an address. If this is the case, you might need to reset the device.
- Make sure the All-in-One printer is on the correct network.
- Restart your All-in-One printer.

Probable Cause 8

The printer is on the wrong Subnet or gateway.

Corrective Action

Print a network configuration page, and verify that the router and printer are on the same subnet and gateway.

To print the network configuration page

- On the control panel of the printer, press Menu.
- Press ▼ until Network Settings is highlighted, and then press OK.
- Press ▼ until Print Network Configuration is highlighted, and then press OK.

No IP address with cable modem (without a router)

Probable Cause

If you have a computer with a cable modem, a separate Local Area Network (LAN) for your other computers, and no DHCP or router, you must use AutoIP to assign IP addresses to the other computers and to the printer.

Corrective Action

To obtain an IP address for the computer with the cable modem

Your Internet Service Provider (ISP) assigns either a static or dynamic IP address to the computer with the cable modem.

To assign IP addresses to the remaining computers and the All-in-One printer

Use **AutoIP** to assign IP addresses to the remaining computers and the printer. Do not assign a static IP address.

Wireless troubleshooting

No SSID

Probable Cause 1

Your access point is not broadcasting its network name (SSID) because the **Broadcast SSID** option is turned off.

Corrective Action

Access the Embedded Web Server and turn on the **Broadcast SSID** option.

Probable Cause 2

The access point (infrastructure) or computer (ad hoc) is out of range.

Corrective Action

In order to establish a good signal between the printer and access point (infrastructure) or computer (ad hoc), try doing the following things separately or in combination.

- If there is a long distance between your computer or access point and the printer, move them closer together.
- If there are metal objects (such as a metal bookcase or refrigerator) in the transmission path, clear the path between the printer and the computer or access point.
- If a cordless telephone, microwave, or other device that emits radio signals transmitting at 2.4 GHz is nearby, move it farther away to reduce radio interference.

NOTE: Devices like wireless speakers or wireless gaming accessories can emit radio interference at 2.4 GHz. You can verify this on your wireless desktop or laptop computer by viewing sporadic signal bars in your Wi-Fi status utility.

Repositioning your computer away from these sources of signal interference can improve your computer network performance. For example:

- **Do** place the AP/router in a central room.
- **Do not** place wireless entertainment devices between the AP/router and wireless computer.
- **Do not** place wireless entertainment devices between the AP/router and Wi-Fi All-in-One printer.

Probable Cause 3

The SSID is not visible because it is at the bottom of the list.

Corrective Action

Press ▼ to scroll to the bottom of the list. Infrastructure entries are listed first and ad hoc entries last.

Probable Cause 4

The access point firmware needs updating.

Corrective Action

Check for firmware updates for your access point on the manufacturer's Web site. Update the firmware on the access point.

Probable Cause 5

Your wireless adapter on your computer is not broadcasting the SSID (ad hoc).

Corrective Action

Verify that the wireless adapter is broadcasting the SSID. Print a network configuration page from the All-in-One printer, and verify that the SSID for the wireless adapter appears on the network configuration page. If the wireless adapter is not broadcasting the SSID, see the documentation that came with your computer.

Probable Cause 6

The firmware for the wireless adapter on your computer needs updating (ad hoc).

Corrective Action

Check for firmware updates for your wireless adapter on the manufacturer's Web site, and then update the firmware.

Probable Cause 7

An Ethernet cable is connected to the printer.

Corrective Action

Unplug the Ethernet cable.

Weak signal

Probable Cause

The access point is too far away or there is interference.

Corrective Action

- If there is a long distance between your computer or access point and the printer, move them closer together.
- If there are metal objects (such as a metal bookcase or refrigerator) in the transmission path, clear the path between the printer and the computer or access point.
- If a cordless telephone, microwave, or other device that emits radio signals transmitting at 2.4 GHz is nearby, move it farther away to reduce radio interference. See [NOTE](#); page 89.

Cannot connect to network

Probable Cause 1

The equipment is not turned on.

Corrective Action

Turn on the networked devices, such as the access point for an infrastructure network, or the computer for an ad hoc network. For more information on how to turn on the access point, see the documentation that came with your access point.

Probable Cause 2

The All-in-One printer is not receiving a signal.

Corrective Action

Move the access point and the printer closer together. Then go through setup again.

Probable Cause 3

You have entered the SSID incorrectly.

Corrective Action

Enter the SSID correctly. Remember that the SSID is case-sensitive.

Probable Cause 4

You have entered the WEP key incorrectly.

Corrective Action

Enter the WEP key correctly. Remember that the WEP key is case-sensitive.

Probable Cause 5

The wireless settings on the printer do not match the wireless settings of your access point.

Corrective Action

Print a network configuration page to compare the wireless settings of the printer with the wireless settings for your access point. Change either the device or access point settings so that both the printer and the access point have matching wireless settings.

Probable Cause 6

You entered the wrong mode (ad hoc or infrastructure) or security type.

Corrective Action

Enter the correct mode or security type. Print a network configuration page to compare the wireless settings of the printer with the wireless settings for your access point. Change either the device or access point settings so that both the printer and the access point have matching wireless settings.

Probable Cause 7

MAC filtering is enabled on your access point.

Corrective Action

Keep MAC filtering enabled, but change the settings to allow the access point to communicate with the printer.

Unsupported authentication or encryption type

Probable Cause

Your network is configured with an authentication protocol not supported by the Kodak All-in-One printer.

Corrective Action

Open the Embedded Web Server of your access point and change the security settings. Use one of the supported protocol types.

NOTE: Types not supported include WPS, WPA2-Enterprise, LEAP, PEAP, EAP-MD5, EAP-TLS, and EAP-TTLS.

Invalid WEP Key

Probable Cause 1

An invalid WEP key was entered.

Corrective Action

If you do not know the WEP key, see the documentation that came with your access point/router. The WEP key is stored within the access point. Usually you can find the WEP key by logging on to the Embedded Web Server of your access point through your computer.

Probable Cause 2

The WEP key index setting of your access point does not match the WEP key index setting of the All-in-One printer.

Corrective Action

The printer is looking for a WEP key index of 1. If the WEP key index setting was changed on the access point, open the Embedded Web Server for the printer and update the index setting to match the index setting of your access point. Once you've updated the index setting on the printer, repeat the setup procedure.

NOTE: Some access points provide more than one WEP key. Make sure you use the first WEP key (index 1) when setting up your wireless network.

Invalid WPA Passphrase**Probable Cause**

You have entered the WPA passphrase incorrectly.

Corrective Action

Enter the correct passphrase. Make sure it has between 8 and 63 characters, and matches the passphrase programmed in the access point (case sensitive).

Another device connected to the access point**Probable Cause**

Another device in the vicinity connected to your access point before the All-in-One printer was able to connect.

Corrective Action

Cancel the setup and start over.

Product Safety Specifications

Specifications for your all-in-one printer are described in the tables below.

Print Performance

Print Performance	
Black print speed	Up to 30 pages per minute on plain paper
Color print speed	Up to 29 pages per minute on plain paper
Print technology	Continuous-tone thermal ink jet
Print quality modes	Draft, Normal, and Best on plain paper Photo quality mode on photo paper

Photo Printing Features

Photo Printing Features	
Quantity	1- 99
Print Sizes	2 x 3 inch (5 x 7.6 cm) 3.5 x 5 inch (9 x 12.7 cm) 4 x 6 inch (10 x 15 cm) 4 x 7 inch (10 x 18 cm) Panoramic (4 x 12 inch) (10 x 30 cm) 5 x 7 inch (13 x 18 cm) 8 x 10 inch (20 x 25 cm) US Letter (8.5 x 11 inch) (22 x 28 cm) A4 (21 x 30 cm)
Quality	Normal, Best, and Draft
Auto-detect media	Auto-detect plain paper, photo paper, and transparency Optimize image quality for Kodak Photo Papers with barcode
Image enhancement	Kodak Perfect Touch Technology with Home Center software
Add Dates to Prints	Yes, No
Color	Black & White or Color
Scene Balance	On, Off

Copy Document Features

Copy Document Features	
Color	Black & White or Color
Quantity	1 to 99 copies
Copy size	Same Size, 20% to 500%
Quality	Normal, Best, and Draft
Brightness	- 3 to + 3

Copy Photo Features

Copy Photo Features	
Color	Black & White or Color
Quantity	1 to 99 copies
Copy size	2 x 3 inch (5 x 7.6 cm) 4 x 6 inch (10 x 15 cm) 4 x 7 inch (10 x 18 cm) Panoramic (4 x 12 inch) (10 x 30 cm) 5 x 7 inch (13 x 18 cm) 8 x 10 inch (20 x 25 cm) US Letter (8.5 x 11 inch) (22 x 28 cm) A4 (21 x 30 cm)
Quality	Normal, Best, and Draft
Brightness	- 3 to + 3

Scanning Features

Scanning Features	
Scanner type	Contact Image Sensor (CIS) type scanner
Maximum scan size	8.5 x 11.7 in. (21.6 x 29.7 cm)
Functions	Segmentation scanning Auto-destination OCR

Paper Tray Features

Paper Tray	
Paper capacity:	100 sheets of 20 lb plain paper or 30 sheets of 10 mil photo paper
Tray size: top tray	4 x 6 in. to 8.5 x 14 in. (10 x 15 cm to 21.6 x 36 cm)
Tray size: bottom tray	4 x 6 in., 4 x 7 in., 5 x 7 in.

Ink Tanks

Ink Tanks	
Ink handling	2-cartridge, 6-ink system
Ink life	1-year warranty from date of purchase.

Connectivity

Connectivity	
Protocols supported	USB 2.0, USB PTP, Bluetooth® 2.0, PictBridge, DPOF, MIPC
Devices supported	Windows and Macintosh computers, USB mass storage devices, memory cards (MS, XD, SD, SDHC, and CF), PictBridge-enabled digital still cameras, and Bluetooth® Technology-enabled imaging devices
Image formats supported	JPEG (EXIF V2.2) (progressive JPEG format not supported) AVI, MOV and WAV (transfer only)
Number of USB ports	One front host port (full speed), one rear device port (high speed)

Software Support

Software Support	
Application support	Third-party image management applications or Kodak EasyShare Software for photos; optical character reader (OCR) support for documents
Media support	Plain paper, photo paper, envelopes, greeting cards, transparencies, labels, t-shirt transfers
Scanner support	TWAIN and WIA import, including EasyShare Software, segmentation scanning
File transfer support	Automatic color, contrast, sharpness improvements upon transfer to PC
Update support	Software and firmware updates available through web support

Physical Specifications

Physical Specifications	
Power	US: 110-120 VAC, 60 Hz WW: 110-240 VAC, 50-60 Hz Output: 36 VDC 24V AC adapter (100-240 VAC 50/60 Hz)
Dimensions	16.6 x 7.0 x 11.8 in (422 x 178 x 299 mm) [W x H x D] 445mm x 189mm x 427mm [W x H x D] (17.52 inches x 7.44 inches x 16.81 inches)
Weight	13.1 lbs (5.9 kg) 8.2kg (18.077 lbs)
Operating range	5°C (41°F) to 35°C (95°F), 15 to 85 % RH (non-condensing), and atmospheric pressure to approximately 10,000 ft ASL
Full IQ environmental range	15°C (59°F) to 30°C (86°F), and 20 to 80 % RH

Warranty

Warranty	
Product	One year from purchase (with proof of purchase).
Printhead	One year from purchase (with proof of purchase).

System Requirements

The following specifications are subject to change without notice.

Windows PC

Windows PC	Minimum	Recommended
Operating System	Microsoft Windows XP SP2	Microsoft Windows Vista
CPU	Celeron	32- or 64-bit processor
Clock Speed	1.2 GHz	2 GHz
Memory	512 MB RAM	1024 MB RAM
Available Disk Space	500 MB available	500 MB available
Interface	USB 2.0	USB 2.0
Removable Drive	CD-ROM	CD-ROM
Other	Internet access capability	Internet access capability

Macintosh

Macintosh	Minimum	Recommended
Operating System	Macintosh OS X 10.4.8	10.4.9 or greater
Computer	PowerMac or Powerbook G3, G4; iMac; eMac; or iBook	Intel Mac
Clock Speed	2 GHz	2 GHz
Memory	512 MB RAM	1024 MB RAM
Available Disk Space	200 MB available	200 MB available
Interface	USB 2.0	USB 2.0
Removable Drive	CD-ROM	CD-ROM
Other	Internet access capability	Internet access capability

Papers Supported

Paper Types Supported	
Plain paper	20 to 24 lb (60 to 90 gsm)
Photo paper	10 mils
Card stock	110 lb index max (200 gsm)
Envelopes	20 to 24 lb (75 to 90 gsm)
Transparencies	All commercially available inkjet varieties (with or without a white stripe.)
Labels	All commercially available inkjet varieties on 8.5 x 11 and A4 size sheets
Iron-on transfers	All commercially available inkjet varieties on 8.5 x 11 and A4 size sheets

Paper Sizes for PC and Macintosh computers

Paper Sizes Supported	
Usage	Size
Document page sizes Labels	A4 (210 x 297 mm) A5 (148 x 210 mm) A6 (105 x 148 mm) B5 (176 x 250 mm) US Executive (7.25 x 10.5 in.) (184 x 266 mm) US Letter (8.5 x 11 in.) (216 x 280 mm) US Legal (8.5 x 14 in.) (216 x 356 mm) Custom sizes from 4–8.5 in. wide and 6–14 in. long
Index card stock	4 x 6 in. index cards (101 x 152 mm) 5 x 7 in. index cards (127 x 178 mm)
Transparency Iron-on transfers	A4 (210 x 297 mm) US Letter (8.5 x 11 in.) (216 x 280 mm)
Envelopes	C5 (6.38 x 9 in.) (162 x 299 mm) C6 (4.49 x 6.38 in.) (114 x 162 mm) A2 (4.37 x 5.75 in.) (111 x 146 mm) DL (designated long) (4.33 x 8.66 in.) (110 x 220 mm) US #10 (4.12 x 9.5 in.) (105 x 241 mm)
Photo	4 x 6 in. (102 x 152 mm) 4 x 7 in. (102 x 178 mm) 4 x 12 in. (102 x 305 mm) 5 x 7 in. (127 x 178 mm) 8 x 10 in. (203 x 254 mm) US Letter (8.5 x 11 in.) (216 x 280 mm) A4 (210 x 297 mm)
Greeting card	4 x 5.5 in. (101 x 140 mm) 4 x 8 in. (101 x 203 mm)

Safety Specifications

- Read and follow these cautions and warnings before using Kodak products.
- Always follow basic safety procedures.
- Follow all warnings and instructions marked on the Kodak All-in-One printer.

Parts



CAUTION:

Do not disassemble this product; there are no user-serviceable part(s) inside. Refer servicing to Kodak's qualified service personnel.



WARNING: Keep out of reach of children. Ink may be harmful if swallowed.

Power



CAUTION:

If the power cord or plug is frayed or damaged, the equipment gets wet, or the equipment does not operate normally when the operating instructions are followed, unplug your printer from the power outlet and have qualified service personnel service your printer.



CAUTION:

The alternating current (AC) adapter power supply is equipped with a three-wire grounding type plug. If you cannot insert the plug into the power outlet, contact an electrician to check or replace the power outlet.



CAUTION:

For added protection from damage during a lightning storm, or when your printer and its associated alternating current (AC) adapter are unused for long periods of time, unplug the AC adapter from the power outlet.



WARNING: Pushing objects through the equipment openings can result in an electric shock or fire.



CAUTION:

Do not plug the alternating current (AC) adapter into a household extension cord.



WARNING: The use of an accessory not recommended by Kodak could cause fire, an electric shock, or injury.

Location



CAUTION:

To prevent your printer from overheating, do not block or cover the slots and openings in the equipment, place it near a heat register, or install it in a cabinet without proper ventilation.



CAUTION:

Do not use your printer near water, or spill liquid on it.



WARNING: Do not place your printer on an unstable cart, stand, bracket, or table; this risks damaging the equipment and injuring people.

Environment



CAUTION:

Excessive dust levels may damage internal parts.



CAUTION:

Unplug the equipment from the electrical outlet before cleaning.



CAUTION:

Dropping your printer may damage the housing and result in extensive damage that will require replacement or repair by a qualified technician to restore normal operation.



WARNING: Do not expose this product to liquid, moisture, or extreme temperatures. Kodak alternating current (AC) adapters are intended for indoor use only. The use of controls, adjustments, or procedures other than those specified herein may result in exposure to shock and/or electrical or mechanical hazards.



CAUTION:

Adjust only those controls covered in the user guide or setup instructions.

For more information, go to www.Kodak.com/go/MSDS

Regulatory Compliance



FCC Compliance and Advisory

This equipment has been tested and found to comply with the limits for a Class B digital device, pursuant to Part 15 of the FCC Rules. These limits are designed to provide reasonable protection against harmful interference in a residential installation.

This equipment generates, uses, and can radiate radio frequency energy and, if not installed or used in accordance with the instructions, may cause harmful interference to radio communications. However, there is no guarantee that interference will not occur in a particular installation.

If this equipment does cause harmful interference to radio or television reception, which can be determined by turning the equipment off and on, you are encouraged to try to correct the interference by one or more of the following measures: 1) reorient or relocate the receiving antenna; 2) increase the separation between the equipment and the receiver; 3) connect the equipment to a different outlet (on a circuit) than the one the receiver is connected to; 4) consult the dealer or an experienced radio/TV technician for additional suggestions.

Any changes or modifications not expressly approved by the party responsible for compliance could void the user's authority to operate the equipment.

Any changes or modifications not expressly approved by the party responsible for compliance could void the user's authority to operate the equipment. To ensure compliance with FCC regulations, use only the shielded interface cables provided with the product, or additional specified components or accessories that can be used with the installation of the product.



CAUTION:

When using the Bluetooth interface with a Kodak printer, the transmitter must not be collocated or operated in conjunction with any other antenna or transmitter.

FCC and Industry Canada

This device complies with RSS-210 of the Industry Canada Rules. Operation is subject to the following two conditions:

1. This device may not cause interference.
2. This device must accept any interference, including interference that may cause undesired operation of the device.

This device has been designed to operate with an antenna having a maximum gain of 1.8dB.

Antenna having a higher gain is strictly prohibited per regulations of Industry Canada. The required antenna impedance is 50 ohms.

To reduce potential radio interference to other users, the antenna type and its gain should be so chosen that the EIRP is not more than required for successful communication.

IC Radiation Exposure Statement

IMPORTANT NOTE: This equipment complies with IC radiation exposure limits set forth for an uncontrolled environment. This equipment should be installed and operated with minimum distance 20 cm between the radiator and your body.

Canadian DOC Statement

DOC Class B Compliance—This Class B digital apparatus complies with Canadian ICES-003.

Observation des normes-Class B—Cet appareil numérique de la classe B est conforme à la norme NMB-003 du Canada.

European Compliance Statement



Hereby, Eastman Kodak Company declares that this KODAK all-in-one wireless printer is in compliance with the essential requirements and other relevant provisions of Directive 1999/5/EC.

German Compliance Statement

Noise emissions for this equipment do not exceed 70 dB(A).

This equipment is not intended for use in the work place in accordance with BildscharbV regulations.

“Das Gerät ist nicht für die Benutzung am Bildschirmarbeitsplatz gemäß BildscharbV vorgesehen.”



Caution: There is a risk of explosion if the battery is replaced by an incorrect type. Dispose of used batteries according to the instructions. Contact your local Kodak representative or refer to www.kodak.com/go/recycle for additional information on the collection and recovery programs for batteries.

Achtung

Explosionsrisiko wenn die Batterie durch einen inkorrekten Typen ersetzt wird. Entsorgung der Batterie gemäss der Gebrauchsanweisung. Bitte kontaktieren Sie Ihren lokalen Kodak Repräsentanten oder www.kodak.com/go/recycle für mehr Informationen über das Sammeln und Wiederverwerten von Batterien

Waste Electrical and Electronic Equipment Labeling



In the European Union, this symbol indicates that when the last user wishes to discard this product, it must be sent to appropriate facilities for recovery and recycling.



Contact your local Kodak representative or refer to www.kodak.com/go/recycle for additional information on the collection and recovery programs available for this product.

Declaration of Conformity

See www.kodak.com/go/declarationofconformity.

Glossary

A

Ad hoc The Kodak All-in-One printer communicates directly with each device on the network. No wireless access point is used. This is also called a peer-to-peer network. On an Apple Macintosh, ad hoc is called computer-to-computer.

AiO All-in-One.

B

Bluetooth An industrial specification for wireless personal area networks (PANs). Bluetooth provides a way to connect and exchange information between devices such as mobile phones, laptops, PCs, printers, digital cameras, and video game consoles over a secure, globally unlicensed short-range radio frequency. The Bluetooth specifications are developed and licensed by the Bluetooth Special Interest Group.

C

Computer-to-computer See [Ad hoc](#).

D

DNS Domain Name Server or Domain Name System. A DNS is a record that is located at the registry that tells a browser where to route your mail or where a website can be found. Basically a system that converts IP addresses into names, i.e.123.456.789.0 to www.yourdomain.com. DNS entries translate the domain name (computer hostnames) to IP addresses.

DPI Dots per inch

DPOF Digital Print Order File. This file allows the user of a digital camera to define which captured images on the storage card are to be printed, together with information on the number of copies or other image information such as paper size, image title text, image orientation, contact information and more.

E

ESP EasyShare Printer.

Ethernet A family of computer networking technologies for local area networks (LANs). It defines a number of wiring and signaling standards of network access at the Media Access Control (MAC)/Data Link Layer, and a common addressing format.

EXIF Exchangeable Image File Format. A standard for storing interchange information in image files, especially those using JPEG compression. Most digital cameras now use the EXIF format.

G

Gateway Address A node on a network that serves as an entrance to another network. A node in this instance can be a computer or some other device. The address of the default gateway is assigned by the installation software, unless you have already set a manual IP address.

H

Hex Hexidecimal. A numeric system that uses sixteen distinct characters that are a combination of the numbers 0 - 9 (represent values zero to nine) and letters A - F (represent values ten to fifteen). Hexidecimal is used as a human friendly representation of binary coded values.

Hostname The TCP/IP name assigned to the device by the installation software.

I

Infrastructure The Kodak All-in-One printer communicates with other network devices through a wireless access point, such as a wireless router or base station.

IP Address Internet Protocol address. This address uniquely identifies the device on the network. IP addresses are assigned dynamically through DHCP or AutoIP. Static IP addresses can be set up. An invalid IP address during installation will prevent your network components from seeing the Kodak All-in-One printer.

J

JPEG Joint Photographic Experts Group. The name of the committee that developed the image file format. JPEG is a compressed image file format. JPEG is a "lossy" format, which means some quality is lost when the image is compressed.

K

Kodak Perfect Touch Automatically corrects for common image flaws and "mistakes," such as shadows, and backlighting. Kodak Perfect Touch technology also enhances the desirable qualities of pictures, for vibrant color and richer detail. This feature is available when scanning or copying pictures. Color restoration and Kodak Perfect Touch can be used together to enhance pictures. This feature is not available when scanning black and white pictures.

KPT Kodak Perfect Touch.

M

MAC Media Access Control. The Media Access Control address identifies the Kodak All-in-One printer. This is a unique 12-digit identification number assigned to networking hardware for identification, including routers, switches, and other such devices. No two pieces of hardware have the same MAC address. Some Internet service providers (ISPs) require that you register the MAC address of the Network Card or LAN Adapter that was connected to your cable or DSL modem during installation.

N

Network Configuration

The protocol used to assign the [IP Address](#) to the device. For this Kodak All-in-One printer, the network configuration is:

AutoIP: The installation software automatically determines the configuration parameters.

DHCP: The configuration parameters are supplied by a dynamic host configuration protocol (DHCP) server on the network. On small networks, this could be a router.

Manual: The configuration parameters are set manually, such as a static IP address.

Not Specified: The mode used when the Kodak All-in-One printer is initializing.

O

OCR

Optical character recognition.

P

Peer-to-peer network

See [Ad hoc](#).

PictBridge

A Camera and Imaging Products Association standardized technology that allows printing of images between any PictBridge compliant digital camera and any PictBridge compliant printer. Thus, you can print from a memory card in a digital camera directly to a printer, regardless of brand. No computer is necessary. Each device is automatically recognized by the other. The camera compares its PictBridge functions to the functions of the printer. The camera then displays the supported functions on menus on the LCD screen or in the viewfinder. Once a PictBridge digital camera is connected to a compliant printer, print options appear on the camera monitor (LCD). The camera menu system is used to select settings such as print size, layout, media type, and date. You can print a single image displayed on the camera, print two or more images, or print all of the images on the memory card. You can print part of an image by first cropping it within the camera and even create index prints (contact sheets). To find out if a camera or printer is PictBridge compatible, look for the PictBridge logo on the packaging or check the manual for specifications.

PTP

Picture Transfer Protocol. A standard for transferring pictures from a digital camera.

R

Red Eye

The red-eye effect in flash photography is caused by the light from the flash reflecting off the blood vessels and interior eye tissue in humans. Animal eye glow from reflections is caused by a different internal eye structure, which is much like a mirror. When not enough time elapses between the flash and exposure (as with most compact cameras), the light of the flash occurs too fast for the iris of the eye to close the pupil. The flash of light is focused by the lens of the eye onto the blood-rich retina at the back of the eye. The image of the illuminated retina is then focused by the lens of the eye back to the camera, resulting in a red appearance of the eye on the picture.

S

SSID

Service Set Identifier: A unique identifier (up to 32 characters) that differentiates one wireless local area network (WLAN) from another. The SSID is also known as the network name. The name of the network to which the Kodak All-in-One printer is connected is called its SSID.

Speed	The speed at which data is transmitted over a network. Speeds include 10TX-Full, 10TX-Half, 100TX-Full, and 100TX-Half.
Subnet Mask	A subnet is an IP Address assigned by the installation software to make an additional network available as part of a larger network. Subnets are specified by a subnet mask. This mask determines which of the Kodak All-in-One printer IP address bits identify the network and subnet, and which bits identify the device itself. Kodak recommends that the All-in-One printer and the computers that use it all reside on the same subnet.
T	
Tagged Images	See DPOF above.
U	
USB	Universal Serial Bus. A connection protocol between a peripheral device and a computer, allowing electronic data/signals to be transmitted back and forth. It is used commonly to connect a portable storage device such, as a “thumb” or “flash” drive, to a PC or Macintosh desktop or laptop computer. The Kodak All-in-One printer has a USB port on the front panel for external USB devices to plug into, and another one on the back panel to connect the printer to a computer via a USB cable.
W	
WEP	Wired Equivalent Privacy. A deprecated algorithm to secure wireless networks. Wireless networks broadcast messages using radio, so are more susceptible to eavesdropping than wired networks. WEP was intended to provide confidentiality comparable to that of a traditional wired network. The WEP standard only defines a 10 or 26 character “key” in hexadecimal (0-9+A-F). A WEP password is generated by the router manufacturer and as such, a password for a Linksys router will not be the same on a NetGear router.
Wi-Fi	Wireless Fidelity. A common “shorthand” name for wireless computer networking.
WPA	Wi-Fi Protected Access. A class of systems to secure wireless (Wi-Fi) computer networks. WPA is designed to work with pre-WPA wireless network interface cards (through firmware upgrades), but not necessarily with first generation wireless access points. WPA2 implements the full standard, but will not work with some older network cards.
WPA Key	A WPA key is an encryption key for wireless networking devices.
WPS	Wireless Provisioning Services. A standards-based and integrated platform to provide secure Wi-Fi hotspots. WPS enables enterprises to easily provide guest access with enhanced security to private wireless Internet and corporate networks.

Appendix A: If You Need to Call Customer Support

When you contact Kodak Customer Support for All-in-One printer assistance, the service representative may ask you for some background information, as well as information about your specific issue. If you can have ready access to it, it may save you time.

Useful for the Kodak service technician:

- Kodak Service Number (located inside or on the outside of the printer)
- Printer model number (located on back of the printer)
- Control panel error message, if any
- A printed test page (see [Monitoring and adjusting the printer's performance, page 56](#))
- Computer model and operating system
- Computer processor type and speed (MHz)
- Amount of computer memory (RAM) and free hard disk space
- Exact Home Center error message received, if applicable

Windows PC only:

- Exact printer error message received in the printer status monitor
- Version of Kodak Home Center software. (From the Home Center Help panel, click the Info  button to view the About box)

Index

Symbols

.jpg, 50
.pdf files, 50
.rtf files, 50

Numerics

1111 See Personal identification number, 43
2.0 USB See USB
4-way navigation buttons, 7, 9
8-in-1 card reader See Kodak

A

Ad hoc, definition, 102
Add Date to Prints, 39
Adjusting
 Control panel, 7
 Copy settings, 47
 Scan settings, 52
Align the printhead, 18
Apple Macintosh See Macintosh
arm mode, 102
Arrows See 4-way navigation buttons
Auto-detect, 90
AutoIP, definition, 104

B

Battery recycling, 100
Black ink cartridge, 58, 61
Black print speed, 90
Blinking blue light, 5
Blue light, 5
Bluetooth
 Definition, 102
 Dongle, 42
 Pairing, 43
 Printing from, 42
 Range, 43
Bluetooth dongle, 6
Borderless prints, white edges on, 79
Bottom paper tray, 4
Bottom paper tray extender, 4
Button
 4-way navigation, 9
 Cancel, 11
 Menu, 10
 OK, 10
 Start, 11
 Zoom, 10

C

Cable, USB, 70
Cables, USB 2.0 compliant, 68
Camera troubleshooting, 68

Canadian DOC Statement, 99
Cancel button, 7, 11
Card reader, Kodak 8-in-1, 37
Castellano (Iberian/Spanish), 20
Changing See Edit. See also Replacing
Check ink levels, 57
Chemicals to avoid coming in contact with the printer, 54
Clean the printhead, 57
Cleaning the printer, 54
 Cleaning supplies to avoid, 55
Client port, 3
Color ink cartridge, 58, 61
Color print speed, 90
Communication between printer and computer, troubleshooting, 70
Compliance See Regulations
Components, 4
Computer-to-computer See Ad hoc
Configuring
 Ethernet settings, 21
 Network settings, 21
 Wireless settings, 22
Connectivity, specifications, 92
Control panel, 4, 6
 Adjusting, 7
Copy Document
 Settings, 48
Copy Photo, 47
 Settings, 49
Copy problems, troubleshooting, 79
Copy settings, adjusting, 47
Copying, 47
Cropped pictures, troubleshooting, 76
Cropping photos, 44
Customer Support See Support

D

Danger See Safety
Dark print, troubleshooting, 78
Declaration of Conformity, 101
Device not recognized, troubleshooting, 68
DHCP, definition, 104
Digital Print Order File, definition, 102
Display See LCD Screen
DNS Server Address, definition, 102
Document paper sizes, 95
Document print order, troubleshooting, 75
Document, copy, 47
Dongle See Bluetooth
Download printer updates, 2
DPOF, 42
Draft quality, 48

E

EasyShare software, 2
Electrical and Electronic equipment labeling, 100
Energy See Power
Envelope sizes, 95
Envelopes, 35
Envelopes, loading, 35
Environmental hazards, 97
ESP, definition, 102
Español (Latin-American Spanish), 20
Ethernet network status light, 7
Ethernet network, configuring, 21
Ethernet, definition, 102
European Union recycling, 100
EXIF, definition, 102

F

FCC compliance, 98
File transfer support, 92
Flash drive See Portable storage device
Formatting a memory card in the printer, 57

G

Gateway Address, definition, 103
German Compliance Statement, 99
Greeting card size paper, 95

H

Handling originals, 32
Hazards
 Environmental, 97
 Parts, 96
 Placing the printer safely, 97
 Power, 96
Help
 Control panel options, 1
 Home Center software, 1
 Macintosh, 67
 Windows, 67
HFS Plus See Mac OS Standard
HFS See Mac OS Standard
Home Center software
 Macintosh, 18
 Maintenance options, 57
 Ordering supplies through, 17
 Scanning with, 50
 Troubleshooting, 74
 Troubleshooting the printer, 67
 Windows, 17
Host port, 3
Hostname, definition, 103
Hub See USB

I

IC Radiation Exposure Statement, 99
Image Capture software, 46
Image formats supported, 92
Image quality
 Setting, 39
 Troubleshooting, 56
Index card stock sizes, 95
Industry Canada rules, 98
Ink cartridge
 Disposal, 58
 Installing, 64
 Replacing, 57
 Storing, 57
Ink cartridge not recognized, troubleshooting, 69
Ink levels, 57
Ink, preventing drying out, 59
Installing ink cartridges, 64
IP Address, 27
IP Address, definition, 103
iPhoto software, 46
Iron-on transfers, 95

J

Jammed paper, troubleshooting, 72
JPEG, definition, 103

K

Keyboard See On-screen keyboard, 11
Kodak
 Bluetooth dongle, 6
 Ink cartridges, 57
 Web site, 2
Kodak 8-in-1 USB card reader, 37
Kodak Bluetooth dongle
Kodak Perfect Touch, 90, 103
Kodak Service Number, 106
 Locate in Home Center (Macintosh) software, 18
Kodak.com, 2
 Download printer updates from, 2
 Tips & Projects Center, 2
KPT See Kodak Perfect Touch

L

Label sizes, 95
Labeling, Waste Electrical and Electronic Equipment
 in European Union, 100
Last page first, printing, 75
LCD screen, 4, 7
Light print, troubleshooting, 78
Lights, interpreting signals from the printer, 6
Loading the paper tray, 32

M

- MAC Address, definition, 103
- Mac OS Standard format (HFS), 40
- Macintosh
 - Formatted USB drives not recognized by the printer, 68
 - Help, 67
 - Home Center software, 18
 - Print the first page of a document first, 75
 - Software, 46
 - System requirements, 94
 - Troubleshooting, black screen or screen freeze, 73
- Main menu, 13
- Maintenance, 54
- Maintenance Settings, 57
- Manual IP Address, definition, 104
- Media Access Control address See MAC Address
- Media supported, 94
- Memory card slots, 4
- Memory cards, 5
 - Compatible, 37
 - Formatting, 57
 - Printing photos from, 40
 - Removing, 5
 - Slots, 4
 - Troubleshooting, 68
 - Types supported, 5
- Menu button, 7, 10
- Menus, 12
 - Main, 13
- Model number. See Printer model number
- Modifying See Edit. See also Adjusting
- Monitoring printer performance, 56
- Multiple originals, scanning, 52
- Multiple photo printing, 43
- Multiple-page documents, printing in reverse order, 75

N

- Network
 - Configuring, 21
- Network configuration, definition, 104
- Network settings, 24
- Network settings, configuring, 21
- Network settings, Ethernet, 21
- Network settings, Wireless, 22
- No communication with computer,
 - troubleshooting, 70
- Noise emission, 99
- Nozzle check, 57
- Nozzle correction, 57

O

- Obsolete User Guide, 73
- OCR, definition, 104
- OK button, 7, 10
- On/Off button, 7
- On-screen keyboard
 - Using, 11
- Optical Character Recognition See OCR
- Ordering supplies, 17
- Originals
 - Handling, 32
 - Scanning, 52

P

- Pairing, Bluetooth, 43
- Panoramic photo paper, using, 43
- Panoramic photos, printing, 43
- Paper
 - Sizes supported, 95
 - Troubleshooting, 73
 - Types supported, 94
- Paper feed, troubleshooting, 69, 71
- Paper jam
 - Troubleshooting, 72
- Paper output tray, 4
- Paper output tray extender, 4
- Paper stop, 32
- Paper tray, 4
 - Bottom, 4
 - Extender, 4
 - Loading, 32
 - Top, 4
- Paper tray extension-release, 33
- Paper-edge guide, 4
- Parts hazards, 96
- Peer-to-peer network See Ad hoc
- Photo paper
 - Loading, 34
 - Setting image quality, 39
- Photo paper sizes, 95
- Photocopy, 47
- Photos
 - Cropping, 44
 - Panoramic, 43
 - Printing, 40
 - Printing multiple, 43
 - Select and print all, 41
 - Setting image quality, 39
 - Transferring, 39
- PictBridge camera
 - Definition, 104
 - Displaying photos on, 38
 - Printing photos from, 40
 - Troubleshooting, 75

- Picture Transfer Protocol See PTP
 - PIN. See Personal identification number, 43
 - Poor print quality, 77
 - Port
 - Power cord, 4
 - USB device, 4
 - Portable storage device
 - Encrypted, 40
 - Multiple partitions on, 40
 - Printing photos from, 40
 - Third-party access software, 40
 - Types not supported, 40
 - Power cord connection port, 4
 - Power hazards, 96
 - Power not working, troubleshooting, 67
 - Print
 - Last page first, 75
 - Print a test page, 18
 - Print order
 - Macintosh, 75
 - Windows, 75
 - Print problems, troubleshooting, 74
 - Print quality, troubleshooting, 67
 - Print skewed or slanted, troubleshooting, 77
 - Print smudged, troubleshooting, 76
 - Print spotted, troubleshooting, 77
 - Print Test Page, 57
 - Print too dark, troubleshooting, 78
 - Print too light, troubleshooting, 78
- Printer
 - Components, 4
 - Configuring network settings, 21
 - Ethernet, 21
 - Wireless, 22
 - Personal identification number, 43
 - Updates from Kodak.com, 2
 - Printer access door, 57, 60
 - Printer fails to power on, troubleshooting, 67
 - Printer location, selecting, 19
 - Printer model number, 106
 - Printer not responding, troubleshooting, 72
 - Printer performance, monitoring and adjusting, 56
 - Printer settings, 20
 - Printer status lights, 6
 - Printer supplies, 17
 - at Kodak.com, 2
 - Maintaining, 54
 - Ordering from Home Center, 17
 - Recycling, 54
 - Printhead, 4
 - Alignment, 18, 56
 - Damaged or broken, 60
 - Removing, 61
 - Replacing, 60
 - Printing
 - From a computer, 37
 - From Bluetooth, 42
 - Multiple photos, 43
 - Multiple-page document in reverse order, 75
 - Panoramic photos, 43
 - Photos
 - Memory cards, 40
 - PictBridge camera, 40
 - Portable storage device, 40
 - PTP camera, 40
 - Tagged image photos, 42
 - Troubleshooting, 74
 - Printing stops, troubleshooting, 78
 - Printing too slow, troubleshooting, 78
 - Protecting the printer, 54
 - PTP camera, printing photos from, 40
 - PTP, definition, 104
- Q**
- Quality settings
 - Best, 48
 - Draft, 48
 - Normal, 48
 - Quality, troubleshooting, 77
- R**
- Rear-access cleanout area, 4
 - Recycling
 - Battery, 100
 - European Union, 100
 - Printer or printing supplies, 54
 - Red Eye, definition, 104
 - Register the printer, 2
 - Regulations
 - Canadian, 98
 - FCC, 98
 - IC radiation exposure, 98
 - Regulatory compliance, 98
 - Removing a memory device from the printer, 37
 - Removing the printhead, 61
 - Replacing ink cartridges, 57
 - Reversing document print order, 75
- S**
- Safety
 - Environmental, 97
 - Parts, 96
 - Placing the printer, 97
 - Power, 96
 - Safety requirements, 96
 - Same size copies, 48
 - Scale percent copies, 48

- Scaling copy size, 48
 - Scaling destination, 53
 - Scan settings, adjusting, 52
 - Scanned image is blank, troubleshooting, 80
 - Scanner glass, 4
 - Cleaning, 55
 - Damage, avoiding, 55
 - Scanner lid, 4
 - Cleaning, 55
 - Scanning, 50
 - Multiple originals, 52
 - Problem troubleshooting, 79
 - Using Home Center software, 50
 - Scene Balance, 39
 - Screen, 7
 - Select and print all photos, 41
 - Selecting printer setup location, 19
 - Self-powered USB hub, 70
 - Service agreements, 54
 - Set up a network connection to the printer, 21, 22
 - Settings
 - Ethernet, 21
 - Network, 21
 - Wireless network, 22
 - Setup, selecting location for the printer, 19
 - Sizes of copies, 48
 - Slots for memory cards, 4
 - Slow printing, troubleshooting, 78
 - Software See Home Center software
 - Spots on print, 77
 - SSID, definition, 104
 - Start button, 7, 11
 - Status check, performing, 56
 - Status lights, 6
 - Status Monitor, 17
 - Storing ink cartridges, 57
 - Subnet, definition, 105
 - Supplies, ordering, 17
 - Support, 1, 67
 - Telephone numbers
 - Web site, 2
 - System requirements, 93
- T**
- Tagged images, 42
 - Printing, 42
 - Technical Support See Support
 - Test page, printing, 57
 - Thumb drive See Portable storage device
 - Top paper tray, 4
 - Touching the scanner glass, 54
 - Transfer picture failure, troubleshooting, 72
 - Transferring photos, 39
 - Transparency sizes, 95
 - Troubleshooting
 - at Kodak.com, 2
 - Camera, 68, 72, 75
 - Copy problems, 79
 - Cropped picture, 76
 - Device not recognized, 68
 - Document print order, 75
 - Home Center software, 74
 - Ink cartridge not recognized, 69
 - Macintosh, 73
 - Macintosh-formatted USB drive, 68
 - Memory cards, 68
 - No communication with computer, 70
 - Paper, 73
 - Paper feed, 69, 71
 - Paper jam, 72
 - PictBridge camera, 75
 - Picture smudged, 76
 - Print quality, 67
 - Print skewed or slanted, 77
 - Print spotted, 77
 - Print too dark, 78
 - Print too light, 78
 - Printer fails to power on, 67
 - Printer not responding, 72
 - Printing, 74
 - Printing stops, 78
 - Printing too slow, 78
 - Scanning problems, 79
 - Status lights, 14
 - Transfer picture failure, 72
 - Water inside the printer, 54
 - White edges on borderless prints, 79
 - WIA error, 74
 - Windows Vista, 74
- U**
- Universal serial bus
 - Definition, 105
 - Device port, 4
 - Port, 6
 - Update, 92
 - Printer software, firmware, drivers, 2
 - Updating the User Guide, 73
 - Upper paper tray, 3
 - USB
 - Cable, 70
 - Card readers, supported, 37
 - Definition, 105
 - Device port, 4
 - Host port, 4, 6
 - Hub, self-powered, 70

- Port, 4, 6
- USB 2.0 compliant cables, 68
- User Guide
 - Outdated, 73
 - Updating, 73
- Using
 - On-screen keyboard, 11

V

- Vista troubleshooting, 74

W

- Warranty, 92
- Waste labeling, 100
- Water exposure, troubleshooting, 54
- WEP, definition, 105
- White edges on borderless prints,
troubleshooting, 79
- WIA error, troubleshooting, 74
- Wi-Fi Radio, 24
- Wi-Fi Setup Wizard, 24
- Wi-Fi, definition, 105
- Windows
 - Help, 67
 - Home Center software system requirements, 93
- Windows Vista troubleshooting, 74
 - WIA error, 74
- Wireless network status light, 7
- Wireless network, configuring, 22
- Wireless printing, Bluetooth
- WPA, definition, 105
- WPS, definition, 105

Z

- Zoom buttons, 7, 10
- Zooming photos, 44