

Kodak KD Alkaline Battery

Effective: April 11, 2008

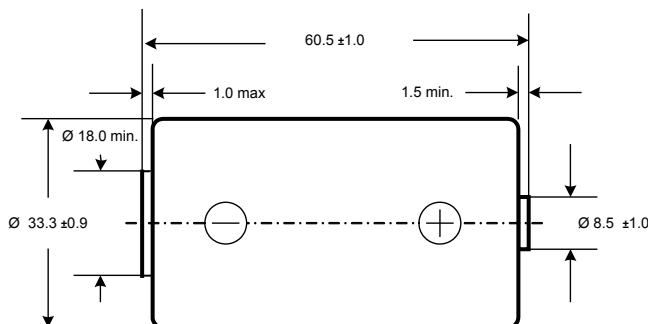

Dimensions are in millimeters and include label.

System:	Alkaline
Designation:	ANSI 13A, IEC LR20
Nominal Voltage:	1.5 Volts
Nominal Capacity:	19500 mAh at 39 Ohms to 0.8 Volts
Internal Impedance:	0.08 Ohms (typical)
Temperature Ranges:	-20°C to +54°C (Operating) +10°C to +25°C (Storage, Recommended)
Chemistry:	Zn/MnO₂
Reaction:	2MnO + Zn + H₂O → 2MnOOH + ZnO
Average Weight:	141 grams
Volume:	53.8 cm³
Terminals:	Flat contacts, Protruding Negative
Jacket:	PVC Plastic Label

Note:

- 1) No added Mercury / 99.9999% Mercury Free
- 2) No added Lead / 99.9999% Lead Free
- 3) No added Cadmium / 99.9999% Cadmium Free
- 4) No added PFOS (Perfluorooctane sulfonates)
- 5) This battery complies with ANSI C18, IEC 60086, and EU Directive 2006/66/EC, 2006/122/EC
- 6) Batteries are NOT subject to European RoHS regulations.
- 7) Primary Batteries (non-Rechargeable) are not subject to China RoHS regulations.
- 8) MSDS sheets are available on the Kodak website.

The Data in this publication represents product tested under the conditions specified. They do not represent standards or specifications which must be met by Eastman Kodak Company. Company reserves the right to change and improve product characteristics at any time.

For more information, contact Eastman Kodak Company, 343 State Street, Rochester NY 14650-0811, Phone 1-800-242-2424

www.kodak.com/go/batteries

© Eastman Kodak Company, 2008

Kodak is a trademark.

Kodak